

1. Mechanical Dimensions:

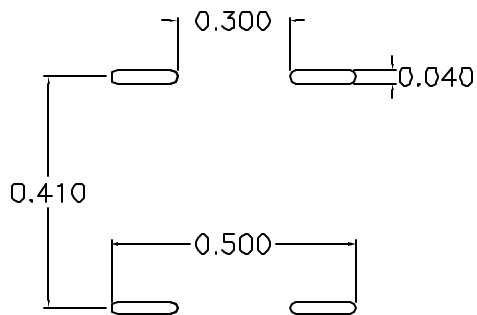

(SUGGESTED MOUNTING PAD)

2. Schematic:

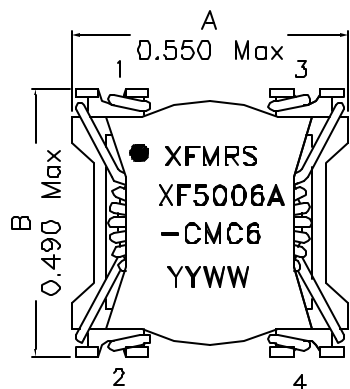
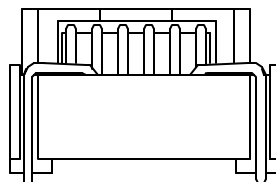
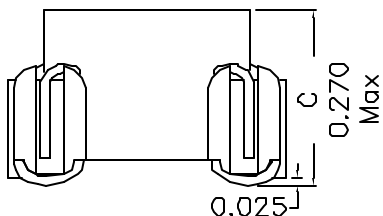
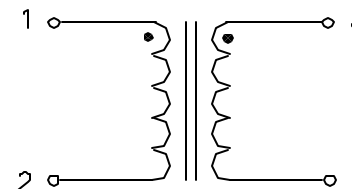

3. Electrical Specification:

Turns Ratio: Pins (1-2):(3-4) = 1:1
 OCL: 0.5mH Min @10KHz 1.0V
 DCR: 0.045 Ohms Max, Each Wdg
 Rated Current (For 55c Rise): 3A
 Hipot : 500Vrms

Notes:

1. Solderability: Leads shall meet MIL-STD-202G, Method 208H for solderability.
2. Flammability: UL94V-0
3. ASTM oxygen index: > 28%
4. Insulation System: Class F 155°C, UL file E151556
5. Operating Temperature Range: All listed parameters are to be within tolerance from -40°C to +125°C
6. Storage Temperature Range: -55°C to +125°C
7. Aqueous wash compatible
8. SMD Lead Coplanarity: ±0.004*(0.102mm)
9. Electrical and mechanical specifications 100% tested
10. RoHS 6/6 Compliant Component

DOC. REV: A/1

PROPRIETARY Document is the property of XFMRS Group & is not allowed to be duplicated without authorization.

XFMRS Inc.	Title: Common Mode Choke		
	UNLESS OTHERWISE SPECIFIED TOLERANCES: .xxx ±0.010 INCH Dimensions in INCH	P/N: XF5006A-CMC6	REV. A
SHEET 1 OF 1	DWN.	康玉坤	Oct-02-06
	CHK.	李清儿	Oct-02-06
	APP.	MS	Oct-02-06