

2CLG200KV/1.0A Product Data

High voltage rectifier diodes 2CLG200KV/1.0A series adopt high reliable mesa structure and diffusion craftwork, epoxy resin molded in a compact structure.

■ Feature

- Avalanche characteristic
- More sizes to choose
- epoxy resin molded in vacuum, have anticorrosion in the surface
- Operating Junction Temperature Tj: -40°C—+150°C

■ Application

- High voltage rectifier used in electrostatic cleaning
- High voltage generator
- High voltage testing equipment
- General purpose high voltage rectifier, voltage multiplier assembly

■ Maximum Ratings

Item	Symbol	Conditions	2CLG	Unit
			200KV/1A	
Repetitive Peak Reverse Voltage	V_{RRM}	$T_a=25^{\circ}\text{C}$ $I_R=5\mu\text{A}$	200	kV
Average Forward Current	I_O		1.0	A
Surge Forward Current	I_{FSM}	50Hz Half-sine Wave , Resistance load @ $T_{break}=50^{\circ}\text{C}$	25	A
Operating Junction Temperature	Tj	Halfsine wave peak voltage	-40—+150	°C
Operating Ambient Temperature	Tc		100	°C
Storage Temperature	Tstg		-40—120	°C

■ Electrical Characteristics

Rated Value	Symbol	Conditions	2CLG	Unit
			200KV/1A	
Forward Peak Voltage Max (Reference Value)	V_F	$I_F=1.0\text{A}$ 40°C	350	V
Reverse Recovery Time Max	Trr		100	nS
Peak Reverse Current (Reference Value)	I_{R1}	$V_R=V_{RRM}$, 25°C	5.0	μA
	I_{R2}	$V_R=V_{RRM}$, 100°C	50.0	μA

■ Dimension (Unit: mm)

Drawing1

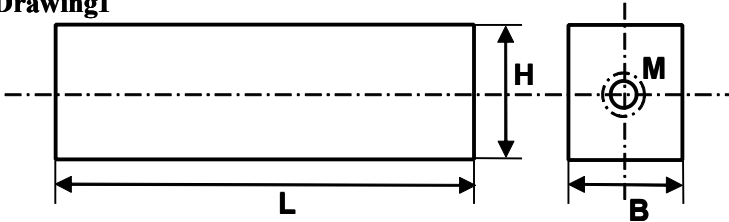

Type	L	B	H	Electrode
2CLG200KV/1A	220	35	25	M5

Notice:

Please do cooling treatment if the surface temperature is higher than 60 °C when the diode rectifier is working. It will be better used in oil immersion conditions.

■ Characteristic Curve

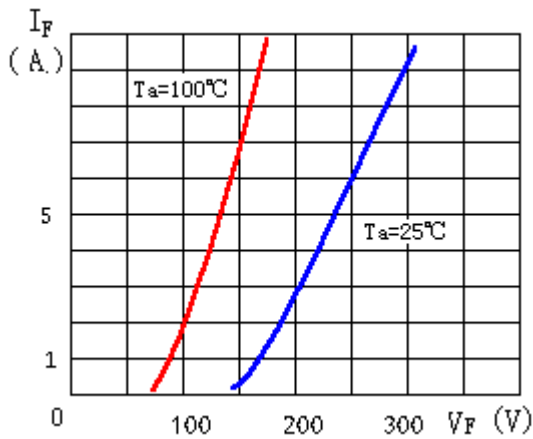

Forward Characteristics

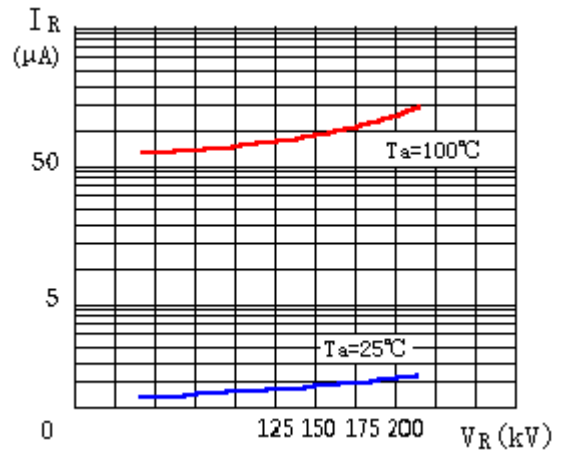

Reverse Characteristics

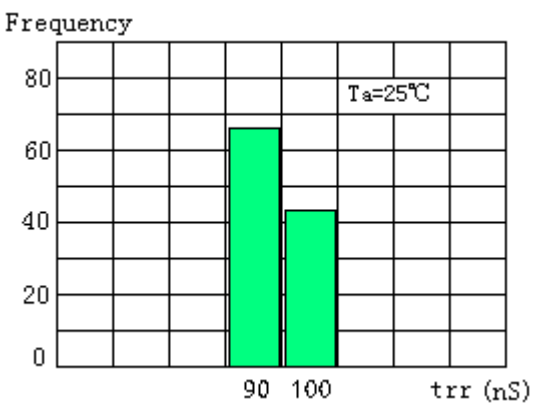

Reverse Recovery Time Distribution
ANSHAN SULY ELECTRONICS CO., LTD.

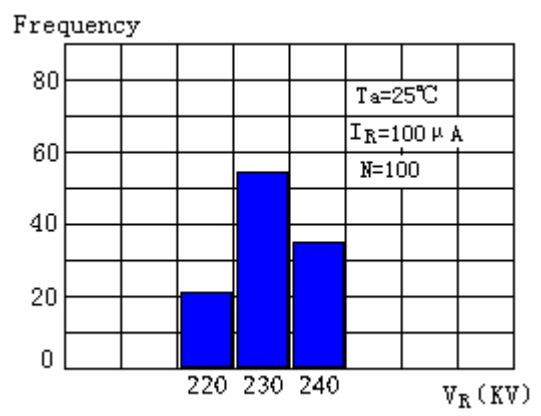

Avalanche Breakdown Voltage Distribution
Website: www.hvdiode.com

Reverse Recovery Time Basic Test Circuit

