

**PLEASE CHECK WWW.MOLEX.COM FOR LATEST PART INFORMATION**

**Part Number:** [0638851060](#)  
**Status:** **Active**  
**Description:** Applicator Wire Guide Funnel Assembly

**Documents:**

[RoHS Certificate of Compliance \(PDF\)](#)

**General**

|                                |   |
|--------------------------------|---|
| Product Family                 | Application Tooling   |
| Series                         | T9999   |
| Comments                       | Funnel used with 4.20mm nominal wire insulation diameter wires with smaller insulation diameter may not be effectively guided in the funnel |
| Function                       | Crimp   |
| Geographic Area                | Global  |
| Level of Automation            | Automatic, Semi-Automatic   |
| More Detailed Tech Information | <a href="mailto:applicationtooling@molex.com">applicationtooling@molex.com</a>  |
| Product Name                   | Mini-Mac™   |
| Survey                         | <a href="http://www.molex.com//review/apptool_survey.html">www.molex.com//review/apptool_survey.html</a>                                    |
| Tool Type                      | Mini-Mac Applicator   |
| UPC                            | 822350316569  |

**Material Info**

**Reference - Drawing Numbers**

Application Tooling Documents

638851060, TM-640160065, TM-640160065CN, TM-640160065DE, TM-640160065FR, TM-640160065IT, TM-640160065JP, TM-640160065KR, TM-640160065MY, TM-640160065PL, TM-640160065RU, TM-640160065SK, TM-640160065SP, TM-640160065TH, TM-640160065TW, TM-640160065VN

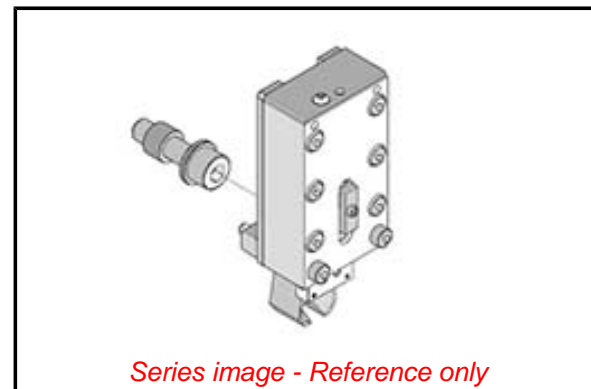

*Series image - Reference only*

**EU ELV**

**Not Reviewed**

**EU RoHS**

**Not Reviewed**

**REACH SVHC**

Not Reviewed

**Halogen-Free**

**Status**

**Not Reviewed**

**Need more information on product environmental compliance?**

Email [productcompliance@molex.com](mailto:productcompliance@molex.com)  
Please visit the [Contact Us](#) section for any non-product compliance questions.

China ROHS

Not Reviewed

ELV

Not Reviewed

**Search Parts in this Series**

[T9999 Series](#)

**Use With**

[63885-1000](#)