

Rev	AWO #	Description	Date	Appr
-		RELEASED	6/7/05	

APPROVED: \_\_\_\_\_  
 DATE: \_\_\_\_\_ TITLE: \_\_\_\_\_

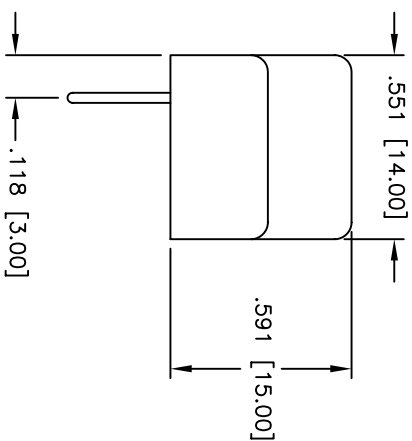
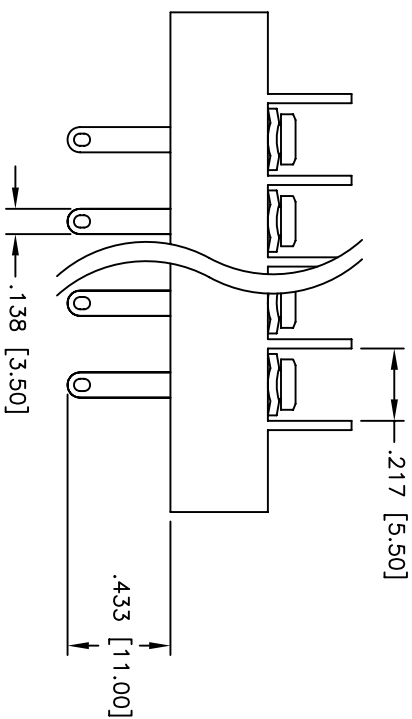
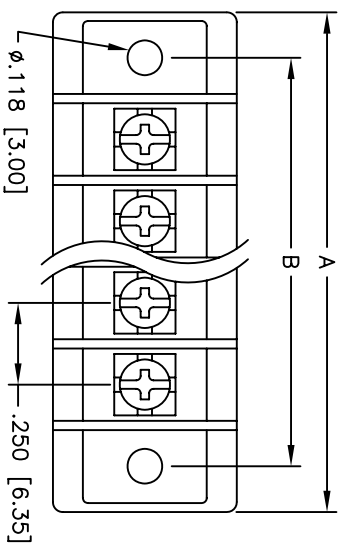

Positions: 2 thru 32  
 A = .250 [6.35] x No. of Positions + .535 [13.60]  
 B = .250 [6.35] x No. of Spaces

**SPECIFICATIONS:**

- Material: Insulator: PBT, rated UL 94V-0  
Insulator color: Black
- Plating: Contacts: Brass, Tin plated  
Screws: Steel, Nickel plated  
Hardware: Brass, Tin plated
- Electrical: Operating voltage: 300 VAC max.  
Current rating: 10 Amps max.  
Contact resistance: 20 mohms max. initial  
Insulation resistance: 500 Mohms min.  
Dielectric withstanding voltage: 2,000 VAC for 1 minute
- Mechanical: Wire range: 22 - 16 AWG  
Temperature Rating: Operating temperature: -65°C to +125°C  
Environmental: Lead free, RoHS compliant  
Recommended soldering temp: 230°C for 5 seconds

UNLESS OTHERWISE SPECIFIED ALL DIMENSIONS ARE INCHES [MM]	
TOLERANCES: EXCEPT AS NOTED	
INCHES	HOLDS
.X ± .10	ØX ± .10
.XX ± .020	ØXXX ± .015
.XXX ± .015	ØXXX ± .010
APPROVALS	DATE
DRAWN SS	6/7/05
CHECKED	
APPROVED	

**ADAM TECH**  
 909 Railway Avenue, Union, NJ 07083  
 Phone: 908-687-5000 Fax: 908-687-5710

TITLE: 250 [6.35] CENTERLINE BARRIER BLOCK  
 CLIP TITE TERMINALS, MOUNT ENDS

SIZE: X PART NO.: TBA-XX-04-M  
 SCALE: NTS SHEET 1 OF 1