

[NetShelter 2 Post Open Frame Racks](#)

**NetShelter 2 Post Rack 45U #12-24 Threaded Holes Black**

AR201



2-post racks for networking applications in IT environments.

**Includes:** Qty 24 #12-24 x 0.5 inch pilot screws, User Manual

**Standard Lead Time:** Usually in Stock

## Physical

Net Weight	11.82 KG
Maximum Height	2121.00 mm
Maximum Width	513.00 mm
Maximum Depth	376.00 mm
Shipping Weight	13.64 KG
Shipping Height	2184.00 mm
Weight Capacity (static load)	340.91 KG
Rack Height	45U
Color	Black
Vertical Posts	3 gauge

## Conformance

Regulatory Approvals	UL Listed
Standard Warranty	2 years repair or replace
Standards	EIA-310-D, EIA-310-E

**AR201 Features**

Bolts to the floor
Ships Unassembled
Powder coat paint finish

**NetShelter 2 Post Open Frame Racks Features & Benefits**

<b>Agility</b>	
Self squaring design	Allows for fast and easy installation
<b>Total Cost of Ownership</b>	
6061-T6 Structural grade aluminum	Highly quality aluminum ensures product durability

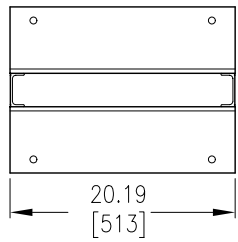

TOP VIEW

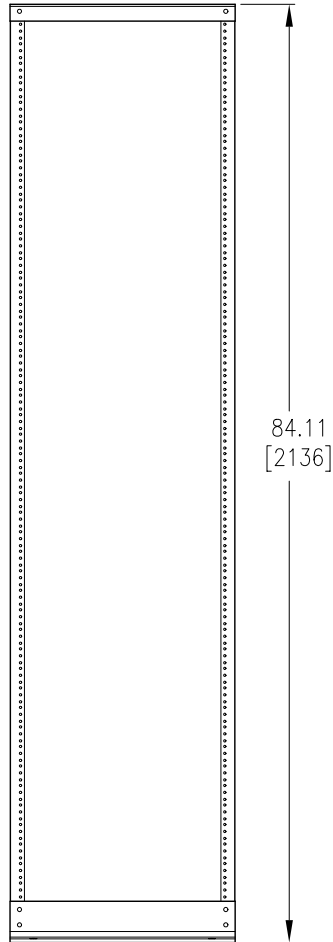

FRONT VIEW

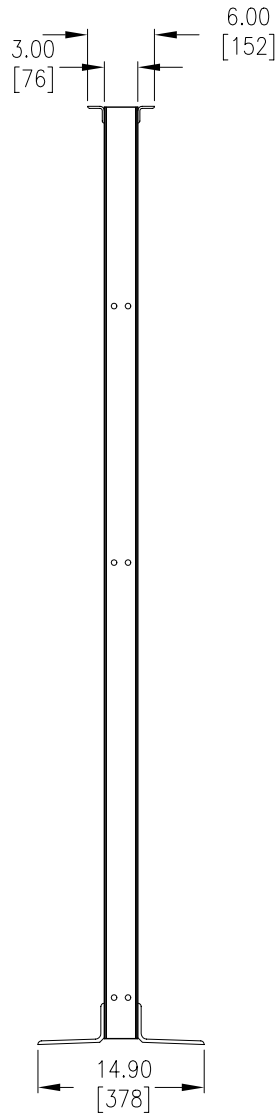

SIDE VIEW

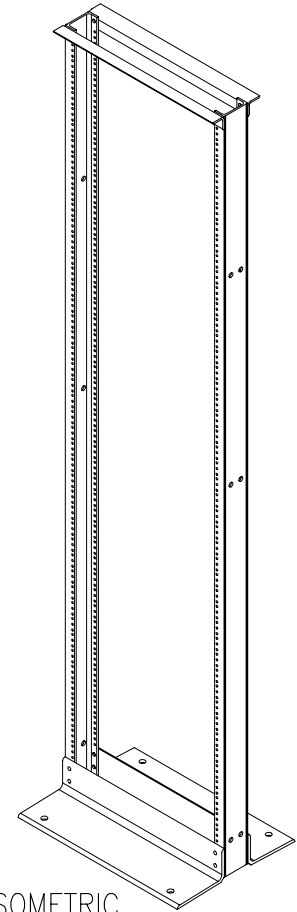

ISOMETRIC VIEW

NOTES:

1. ALL DIMENSIONS ARE IN INCHES [MILLIMETERS].
2. UNIT NET WEIGHT 26.00 LBS [11.82KG].
3. INSTALLATION MUST COMPLY WITH ALL APPLICABLE NATIONAL AND LOCAL CODES.

THIS DRAWING AND SPECIFICATIONS HEREIN ARE THE PROPERTY OF AMERICAN POWER CONVERSION AND SHALL NOT BE COPIED, REPRODUCED OR USED IN WHOLE OR IN PART, AS THE BASIS FOR THE MANUFACTURE OR SALE OF ITEMS, WITHOUT WRITTEN PERMISSION FROM APC. THIS DRAWING IS BASED UPON LATEST AVAILABLE INFORMATION AND IS SUBJECT TO CHANGE WITHOUT NOTICE.

TITLE: InfraStruXure®  
2 Post Open Frame  
Mechanical Layout

PROJECT: SUBMITTAL DRAWINGS SHEET 1 OF 1

DWG NO:	AR200-AR201	REV.	-
DRAWN BY:	M CRAVEN	11/20/03	
CHECKED BY:	B SHERIDAN	11/20/03	
ENGINEER:	J RUNK	11/20/03	

**APC**®  
AMERICAN POWER CONVERSION  
132 FAIRGROUNDS RD  
WEST KINGSTON, RI 02892