

PCB Layout

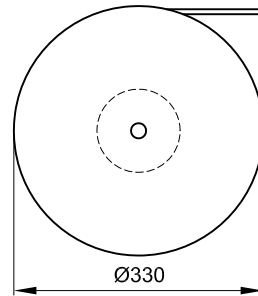

Tape & Reel packaging (with Pick and Place Cap) 300pcs per reel

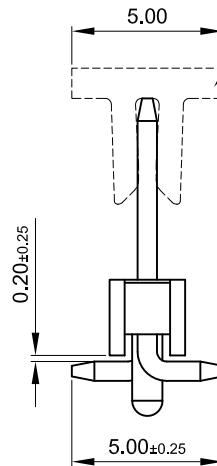
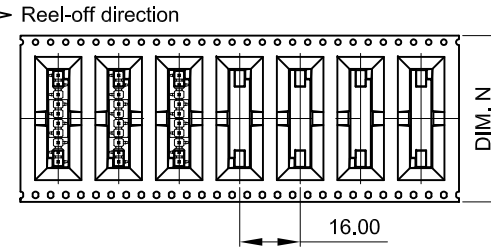

Pick and Place Cap for tape and reel packaging

**Notes:**

**Material and finish:**

Contact: Brass  
Gold over 30~80u" nickel plating  
Insulation: PA9T UL94-V0, color black

**Specifications:**

Current rating: 3.0A  
Contact resistance: 20mΩ Max.  
Withstanding Voltage: 1000V AC/DC  
Insulation resistance: 1000MΩ Min.  
Operating temperature: -40°C to +105°C

Tube Packaging Q'ty

|                  |               |
|------------------|---------------|
| 14               | 16            |
| 12               | 19            |
| 10               | 22            |
| 8                | 28            |
| 6                | 38            |
| 4                | 57            |
| 2                | 114           |
| No. of positions | Q'ty per tube |

|        |        |        |        |    |       |       |       |    |       |
|--------|--------|--------|--------|----|-------|-------|-------|----|-------|
| 129160 | 129153 | 129146 | 129139 | 14 | 35.56 | 33.02 | 30.48 | 56 | 10.00 |
| 129159 | 129152 | 129145 | 129138 | 12 | 30.48 | 27.94 | 25.40 | 56 | 10.00 |
| 129158 | 129151 | 129144 | 129137 | 10 | 25.40 | 22.86 | 20.32 | 44 | 10.00 |
| 129157 | 129150 | 129143 | 129136 | 8  | 20.32 | 17.78 | 15.24 | 44 | 10.00 |
| 129156 | 129149 | 129142 | 129135 | 6  | 15.24 | 12.70 | 10.16 | 44 | 10.00 |
| 129155 | 129148 | 129141 | 129134 | 4  | 10.16 | 7.62  | 5.08  | 32 | 10.00 |
| 129154 | 129147 | 129140 | 129133 | 2  | 5.08  | 2.54  | 0.00  | 24 | 7.00  |

| Id-Nr. Tape&Reel<br>10u" gold plating | Id-Nr. Tube<br>10u" gold plating | Id-Nr. Tape&Reel<br>0.8u" gold plating | Id-Nr. Tube<br>0.8u" gold plating | No of Pos. | DIM. G | DIM. H | DIM. M | DIM. N | DIM. P |
|---------------------------------------|----------------------------------|--|-----------------------------------|------------|--------|--------|--------|--------|--------|
| 129160                                | 129153                           | 129146                                 | 129139                            | 14         | 35.56  | 33.02  | 30.48  | 56     | 10.00  |
| 129159                                | 129152                           | 129145                                 | 129138                            | 12         | 30.48  | 27.94  | 25.40  | 56     | 10.00  |
| 129158                                | 129151                           | 129144                                 | 129137                            | 10         | 25.40  | 22.86  | 20.32  | 44     | 10.00  |
| 129157                                | 129150                           | 129143                                 | 129136                            | 8          | 20.32  | 17.78  | 15.24  | 44     | 10.00  |
| 129156                                | 129149                           | 129142                                 | 129135                            | 6          | 15.24  | 12.70  | 10.16  | 44     | 10.00  |
| 129155                                | 129148                           | 129141                                 | 129134                            | 4          | 10.16  | 7.62   | 5.08   | 32     | 10.00  |
| 129154                                | 129147                           | 129140                                 | 129133                            | 2          | 5.08   | 2.54   | 0.00   | 24     | 7.00   |

|  |   |  |
|--|---|--|
| Information:   | Tolerances<br>X: ±0.50 X*: ±10°<br>X.X: ±0.40 X.X*: ±5°<br>X.XX: ±0.25 X.XX*: ±3° | Scale 4:1<br>For further information about I. D. number see manufacturing document |
| All rights reserved. Only for Information. To insure that this is the latest version of this drawing, contact one of the ERNI companies before using | Subject to modification without prior notice. Drawing will not be updated.        | Designation<br>2.54mm Vertical Single Row Header SMT with Locating Pegs            |
| ERNI Asia Holding<br>www.erni.com  |   | 129132   |
| A  | 13-08-2013  |  |
| Rev.   | Date  | 129132.DWG   |