

TOP VIEW

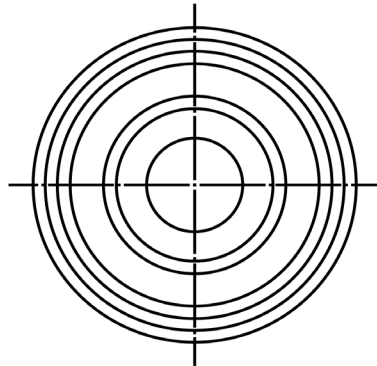

SIDE VIEW

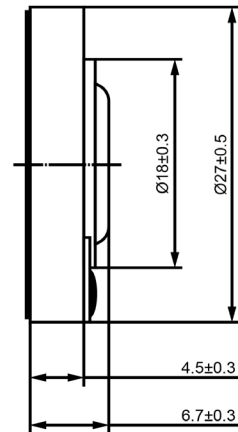

BOTTOM VIEW

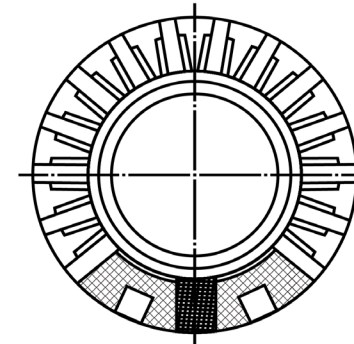

**Specifications**

Description	Value	Unit
Shape	Round	
Resonant Frequency	950	(Hz)
Frequency Range	950 ~ 20,000	(Hz)
SPL @ 10cm	93	(dBA)
Impedance	8	(Ohm)
Cone Material	Mylar	
Nominal Power	0.25	(W)
Max Power	0.5	(W)
Mount Type	Flush Mount	
Operating Temperature	-40 ~ +66	°C
Storage Temperature	-40 ~ +66	°C
Weight	6.4	(g)

**Notes**

- 1) All dimensions are in mm unless otherwise noted
- 2) All parts meet RoHS



**Revision History**

Version	Description	Date	Approved		
1	Released from Engineering	10/21/2013	J.S		
Drawn by	Date	Checked by	Date	Approved by	Date
A.B.	10/21/2013	C.E.	10/21/2013	J.S	10/21/2013

Dynamic Speaker

**SM270908-1**