

1. Material:
 Contacts :Brass
 Insulator :PBT+30% G.F. UL 94V-0;Black
 Shell :Brass
2. Mechanical:
 Mating Force: 45N max.
 Withdrawal Force: 7N min.
 Durability: 500 cycles min.
3. Electrical:
 Current-max[amps] 1.0A
 Voltage-max[volts] 30V
 Withstanding Voltage 750V AC
 Contact Resistance [ohms] 30 milliohms max
 Insulation Resistance [ohms] 1000 Megohms min
4. Plating:
 Contacts:Gold Flash Selective over Nickel
 Shell: Nickel
5. Environmental
 Temperature Range -55°C~+85°C

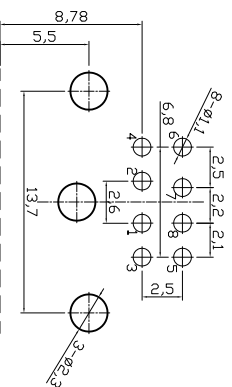
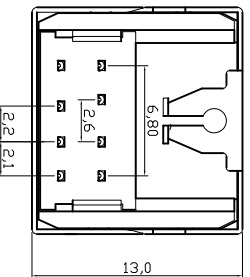

RECOMMENDED P.C.B. PATTERN LAYOUT
 TOP VIEW (TOLERANCE: ±0.05)

RoHS compliant

Scale	1:1														
TOLERANCE															
X.X	±0.38														
X.XX	±0.25														
X.XXX	±0.15														
DIM	TOL	①	Change the manufacture plant	25.11.2010	Alex										
X.°	±1°	②	Drawn	15.07.2009	Rale	Drawn	15.07.2009	Rale							
X.X°	±X°					Approved	25.11.2010	Gerber							
Angle	TOL	Id.	Modification	Date	Name										



Customer-No.
 ASSMANN WSW-No.
A-DIO-FS08

Drawing-No.
ASS 3563 CO
 Replace
 rev02
 Sheet

1 2 3 4 5 6 7

A B C D E F G H

A B C D E F G H