

REV.	ECN NO.	DATE	SIGN	DESCRIPTION
A	Initial Release	2013-11-07	Fisher	Initial Release

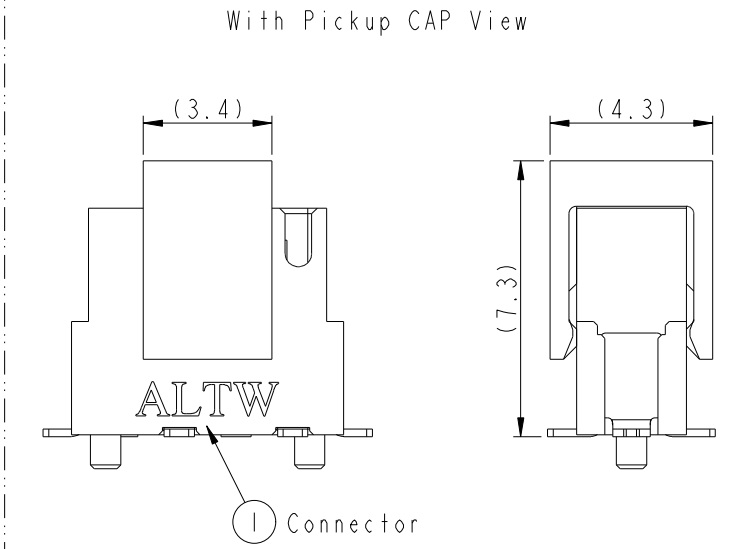

ALTW
CONFIDENTIAL
2013-11-07
R&D DEPT.

RECOMMENDED P.C.B. LAYOUT
GENERAL TOLERANCE IS ±0.05

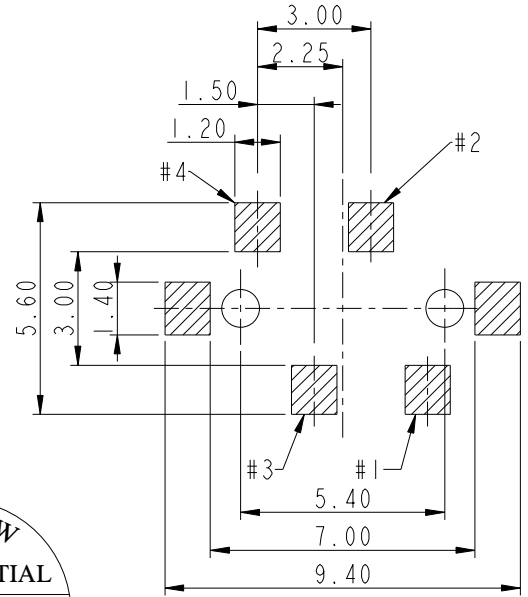
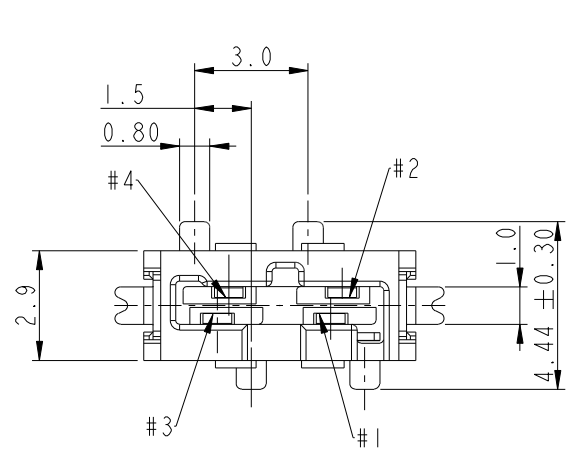
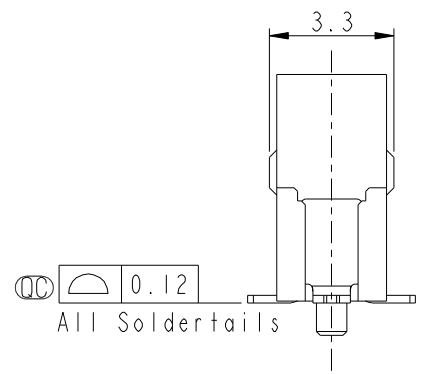
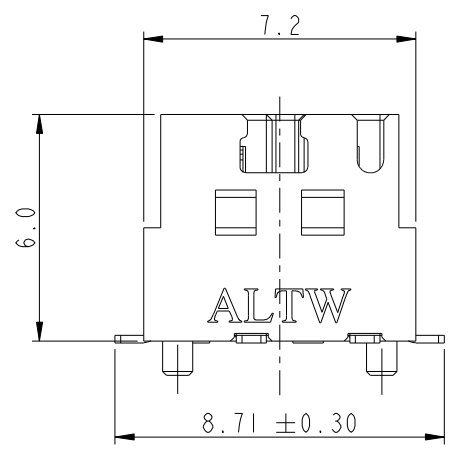

ALTW
DCC. DEPT.
CONFIDENTIAL
2013.11.20
ISSUED

- Notes:
- * CC Important Dimension To Check.
 - * Housing: High temperature thermoplastic. UL94V-0, color is Natural white.
 - * Pickup Cap: High temperature thermoplastic. UL94V-0, color is Natural white.
 - * Terminal: Copper Alloy, Gold Plated on contact area. Tin plated on solder tails.
 - * Solder Peg: Copper Alloy, Tin plated over Nickel.

UNIT:mm		TITLE SSL-1.1 DC 4P JACK CONN, WITH POST,S/T,SMT TYPE		Amphenol LTW		ITEM NO	DRAWN BY	DATE
		SCALE 5:1	SIZE A4	SHEET 1 OF 2	安費諾亮泰企業股份有限公司	SSL11-J4A00-000001	Fisher_Wang	2013-11-07
TOLERANCE .X ±0.25 .XX ±0.1 .XXX ±0.05 ANGLES ±1°		REV. A	WC-REV. A.1	CC : Inspection item		DWG NO SSL11-J4A00-000001	CHECKED BY Ivan_Lin	DATE 2013-11-07
						CUSTOMER ALTW	APPROVED BY Kevin_Hu	DATE 2013-11-07

THIS DOCUMENT IS SUBJECT TO CHANGE WITHOUT NOTICE. IT IS CONFIDENTIAL AND A PROPERTY OF Amphenol LTW. DISCLOSURE TO THIRD PARTY HAS TO BE AUTHORIZED BY Amphenol LTW.

THIS DOCUMENT IS SUBJECT TO CHANGE WITHOUT NOTICE. IT IS CONFIDENTIAL AND A PROPERTY OF Amphenol LTW. DISCLOSURE TO THIRD PARTY HAS TO BE AUTHORIZED BY Amphenol LTW.

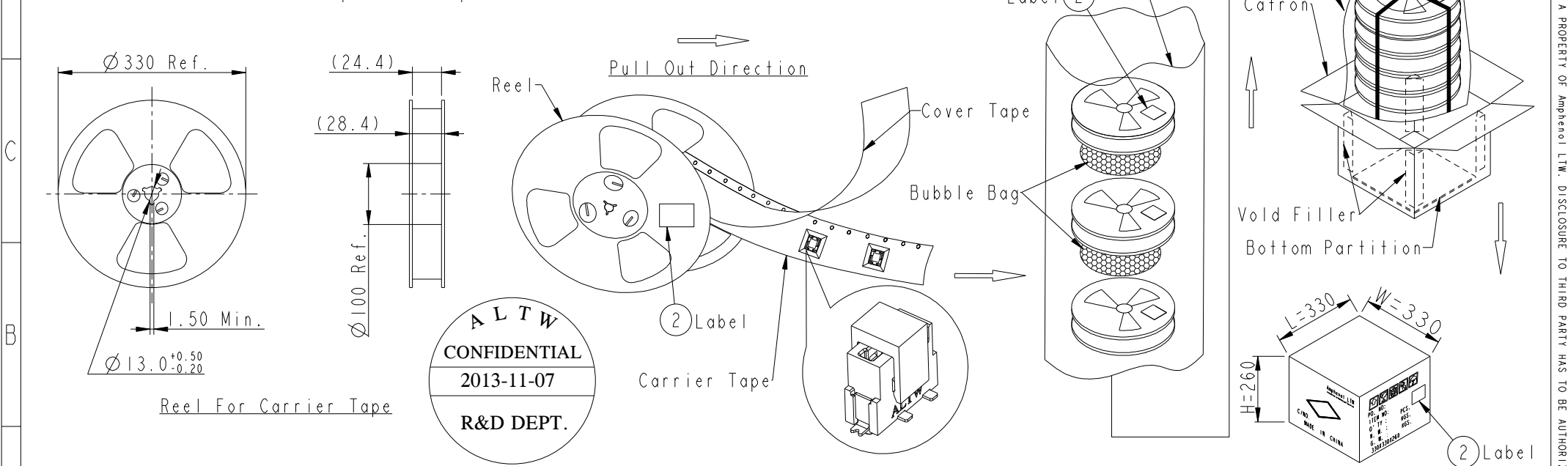
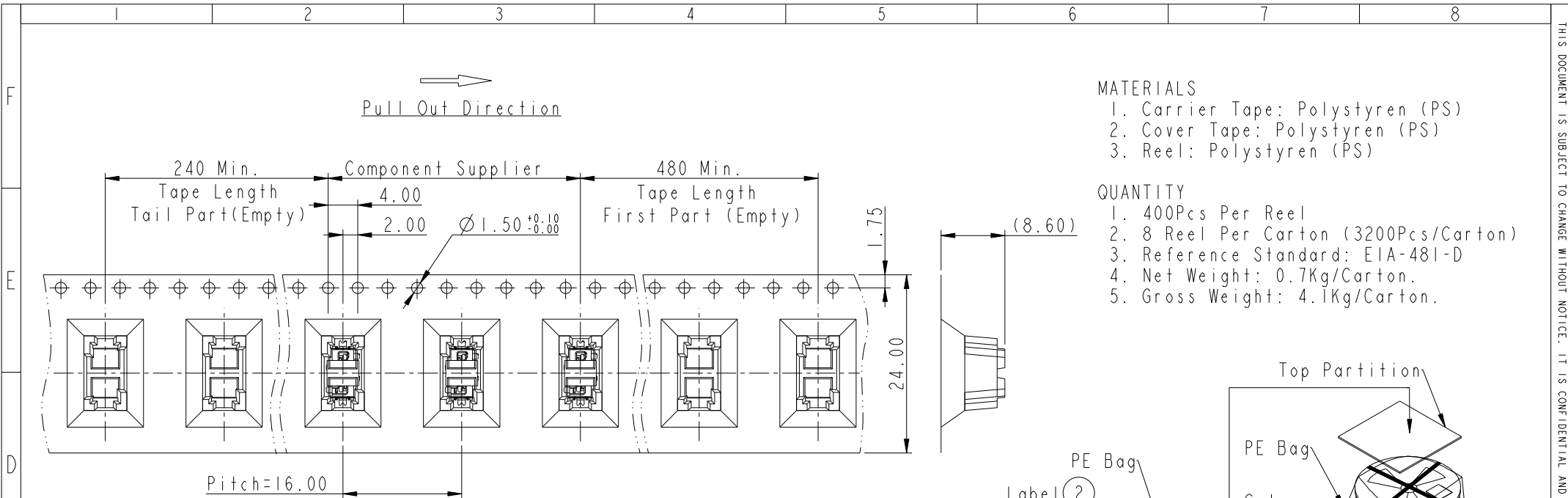

ALTW
 CONFIDENTIAL
 2013-11-07
 R&D DEPT.

UNIT: mm TOLERANCE .X ±0.25 .XX ±0.1 .XXX ±0.05 ANGLES ±1°		TITLE SSL-1.1 DC 4P JACK CONN, WITH POST, S/T, SMT TYPE			<h2 style="margin: 0;">Amphenol LTW</h2> <h3 style="margin: 0;">安費諾亮泰企業股份有限公司</h3>		ITEM NO SSL11-J4A00-000001	DRAWN BY Fisher_Wang	DATE 2013-11-07
		SCALE 5:1	SIZE A4	SHEET 2 OF 2	REV. A	WC-REV. A.3	(QC): Inspection item	DWG NO SSL11-J4A00-000001	CHECKED BY Ivan_Lin
						CUSTOMER ALTW	APPROVED BY Kevin_Lin	DATE 2013-11-07	