



WAP-6101 Version: 1

300Mbps Wireless Ceiling Gigabit PoE Access Point

The tough, high performance WAP-6101 is designed for fast wireless connectivity in enterprise or industrial environments of all dimensions. Embedded with IEEE 802.11n/b/g 2.4GHz MIMO radio in an dust-proof ceiling housing, the enterprise access point provides up to 300 Mbps internet speed.

WAP-6101 enables fast, secure and easy wireless communication, with a WEC button for switching the device between Master and Slave Mode. In Slave Access Point (AP) mode, the device will extend a connection without requiring login to the configured Web, The Wireless Access Point also supports tunnelbased AP Management, and boasts business grade security such as 802.1X and Wi-Fi Protected Access (WPA and WPA2). It also supports WDS for connecting multiple WAP-6101 devices, forming a wider network area.

WAP-6101 features multiple ESSIDs with VLAN tags; one WAP-6101 can emulate up to eight Virtual APs, so offers great performance in situations commonly found in large enterprise, such as separating traffic from different departments using unique ESSIDs. Wireless clients are shielded from each other by Layer 2 isolation, preventing possible attacks from malicious users. When implemented with a Wireless Layer 2 firewall, WAP-6101 inspects all inter-virtual AP traffic as well as wireless-to-wired traffic and decides whether to block or allow passage according to specified security criteria. The device is also PoE compatible, according to standard IEEE 802.3af, and supports IEEE 802.11b/g/n wireless standards.

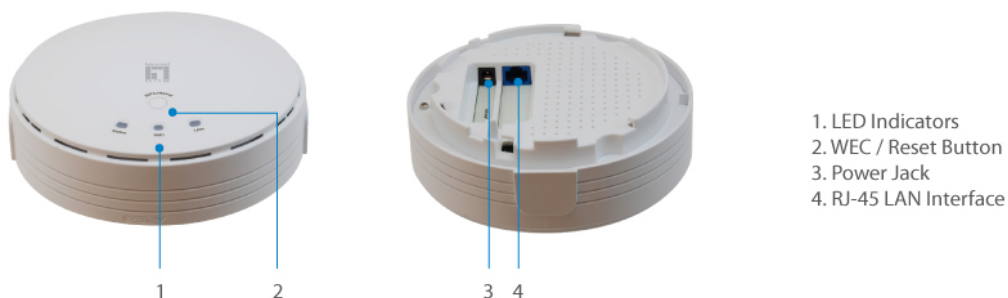

Key Features

- Share your wireless network up to 300Mbps
- Compatible with IEEE 802.11b/g/n wireless standards
- Multi-operation modes to suit different wireless applications



- IEEE 802.3af PoE compliant to simplify deployment and installation
- Provides up to 8 SSIDs to separate network traffic and enhance security
- WEC(Wireless Easy Connection) button for automatic WDS connection
- Enlarge wireless network coverage through WDS technology
- Auto Channel Selection for low interference band
- Supports WEP, WPA and WPA2 encryption with IEEE 802.1X for high level security

Works Well With



WCS-6050

5-Megapixel Day/Night Wireless P/T Network Camera - IR LEDs



WUA-0605

300Mbps Wireless USB Network Adapter

Specifications

System Specifications

Connectors and Cabling:

1x 10/100/1000 Mbps Base-T PoE Port

Button:

WEC button, Reset button

Indicator:

Status, WLAN, PoE

Power:

Power over Ethernet (IEEE802.3af) 48 VDC

Power supply DC12V / 1A

Standards & Protocols:

IEEE 802.3 10-BASE-T, Ethernet

IEEE 802.3u 100-BASE-TX, Fast Ethernet

IEEE 802.3ab 1000BASE-T, Gigabit Ethernet

IEEE 802.1Q Tag-based VLAN

IEEE 802.11e Wi-Fi Multimedia (WMM)

IEEE 802.1X Port-based Network Access Control (PNAC)

IEEE 802.3x Ethernet Flow Control

IEEE 802.11i Wi-Fi Protected Access (WPA2)

IEEE 802.11b, IEEE 802.11g, IEEE 802.11n Wireless Networking

IEEE 802.3 af Power over Ethernet

Wireless

Operating Mode:

AP, Client, WDS (point-to-point/multi-point, max. 4 peer APs), WDS Hybrid, Universal Repeater

Encryption:

WEP 64/128-bit Web share key encryption

WPA, WPA2 128-bit TKIP/AES encryption

WPA, WPA2-PSK TKIP/AES encryption

802.1x RADIUS support

Receive Sensitivity(dBm):

802.11n (20MHZ): Range (-72 ~ -87) dBm

802.11n (40MHZ): Range (-68 ~ -87) dBm

802.11g: Range (-72 ~ -91) dBm Error Rate = 10% at room temperature.

802.11b: Range (-89 ~ -91) dBm Error Rate = 8% at room temperature.

Channel:

Ch.1 ~ 11 USA

Ch.1 ~ 13 EU

EIRP(dBm):

(Controllable for different country regulations)

802.11n: up to 27dBm ± 1dBm

802.11g: up to 24dBm ± 1dBm

802.11b: up to 27dBm ± 1dBm

Antenna:

2x 3dBi internal Omni Antenna

Frequency Band (GHz):

2.4 ~ 2.4835 GHz

Data Transfer Rate:

802.11n: 300 ~ 78 Mbps

802.11g: 54 ~ 6 Mbps

802.11b: 11 ~ 1 Mbps

Features

General:

Auto Channel Selection

Multi-SSID: 8 SSIDs

Security:

802.1x RADIUS support

Wireless Easy Connection (WEC) Push Button

SSID Broadcast On/Off

Management:

Web-Based GUI Configuration

Syslog monitoring

SNMP V1/V2c/V3 supported

QoS:

802.11e WMM Supported

Ease of Use:

Web-based GUI with Quick Installation Wizard

Web-based (HTTP) firmware upgrade

Environment

Temperature (°C):

Operating: 0°C ~ 40°C,

Storage: -10°C ~ 70°C

Humidity (Non-condensing):

Storage: 0 ~ 95%

Operating: 10 ~ 90%

Physical Specifications

Dimensions (W x D x H mm):

Diameter: 150 x 150 x 57.5 mm



Weight (g):
300 g

Others

Approval and Compliance:
CE, FCC

Deployment:
Ceiling-mounted

Diagram

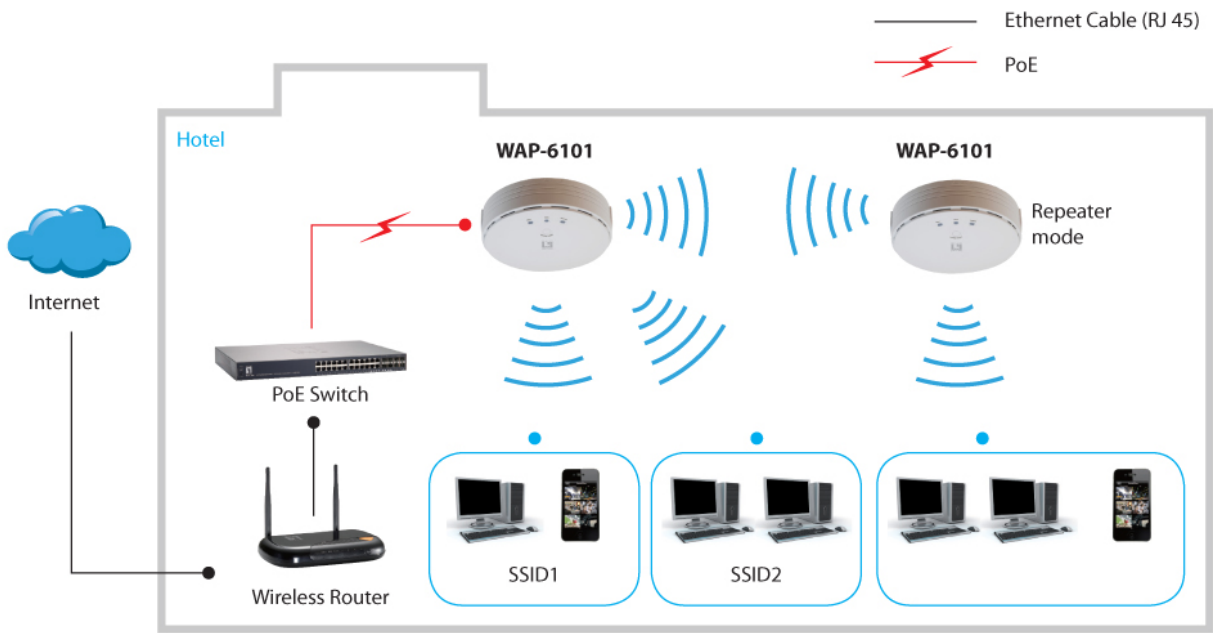

Order Information

WAP-6101

Package Contents

- Power Adapter
- RJ45 Ethernet Cable
- Quick Installation Guide
- Resource CD (User Manual, QIG)

No liability or responsibility for any errors or omissions in the content.
Specifications are subject to change without notice.

All mentioned brand names are registered trademarks and property of their owners.
Copyright © Digital Data Communications GmbH, Germany. All Rights Reserved.