

MATERIAL AND FINISH:

Insulator: PC (Polycarbonate), color black, UL-94V-0 rated

Contacts: Brass, Nickel plated

ELECTRICAL SPECIFICATIONS:

Current rating: 10 A

Voltage rating: 250 VAC



Dielectric withstanding voltage: 3000 VAC for one minute

RoHS
COMPLIANT

ORDERING CODE:

42R45-314 - - -
1 2

1) ELECTRICAL CIRCUIT CONFIGURATION

1 = 10A 250V 70°C
2+GROUND 2 FUSE

2 = 10A 250V 120°C
2+GROUND 2 FUSE

2) PANEL THICKNESS

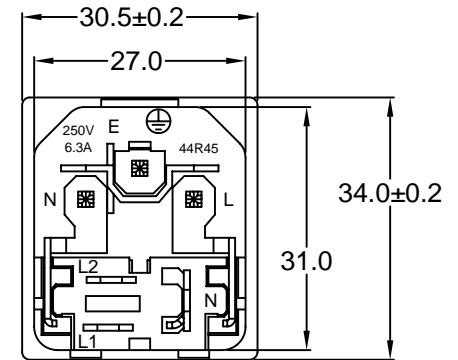
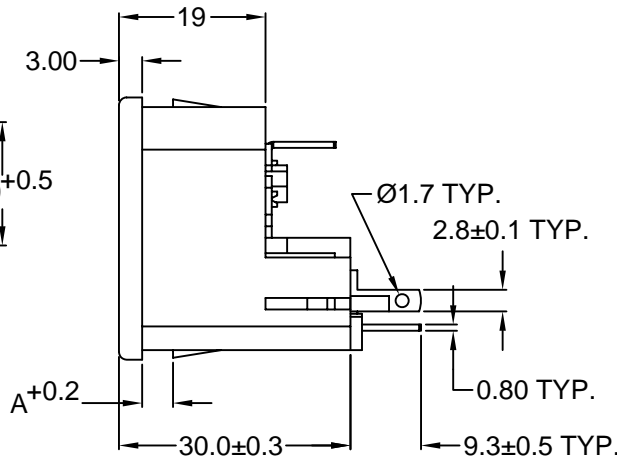
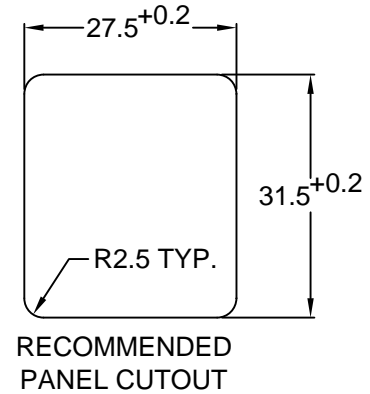
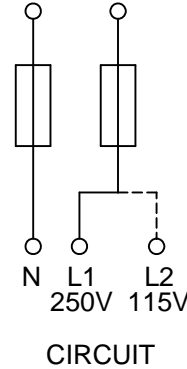
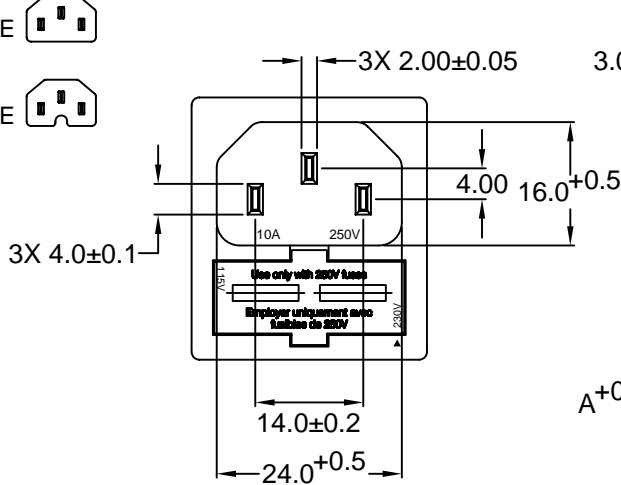

REV	DATE	CHANGE	CHKG	CHKD	APPR

P/N	A	MAX. PANEL THICKNESS
42R45-314X-150	1.5	1.5
42R45-314X-200	2.0	2.0
42R45-314X-250	2.5	2.5
ADDITIONAL PANEL THICKNESS AVAILABLE ON REQUEST		

TOLERANCE UNLESS OTHERWISE SPECIFIED		
X	±	1
X.X	±	0.4
X.XX	±	0.20
DRAWN BY	GQ	DATE: 11/26/01
CHECK BY	PB	DATE: 12/04/01
APPR BY	TD	DATE: 12/04/01

Power Dynamics, Inc.
Phone: 973 560-0019 Whippany, New Jersey Fax: 973 560-0076

PART: IEC 60320 APPL. INLET, VOLTAGE SELECTOR WITH FUSE HOLDER, SOLDER TERMINALS; SNAP-IN

PART #: 42R45-314X-XXX		SHEET 1 of 1
SIZE: A	SCALE: NTS	ALL DIMENSIONS FOR REFERENCE ONLY DIMENSIONS ARE IN MILLIMETERS
REV:		