

IEC Appliance Inlet C10, Screw-on Mounting, Front Side, Solder or Quick-connect Terminal



C10



70° C

**Description**

- Panel Mount:

- Screw-on mounting, from front side
- Appliance Inlet, Pin temperature 70 °C Protection class II
- Solder terminals or quick connect terminals

Approvals

- VDE License Number: 40009507
- UL License Number: E45115
- CSA License Number: 27324

References[General Product Information](#)**Weblinks**

[Approvals](#), [RoHS](#), [CHINA-RoHS](#), [Mating Connectors](#), [e-Store](#), [Distributor-Stock-Check](#), [Accessories](#)

Technical Data

Ratings IEC	6 A / 250 VAC; 50 Hz
Ratings UL/CSA	6 A / 250 VAC; 60 Hz
Dielectric Strength	> 3 kVAC between L-N > 1.5 kVAC between L/N-PE (1 min/50 Hz)
Allowable Operation Temp.	-25 °C to 70 °C
Degree of Protection	from front side IP 20 acc. to IEC 60529
Protection Class	Suitable for appliances with protection class 2 acc. to IEC 61140
Material: Housing	PA, UL 94V-0

Appliance Inlet	C10 acc. to IEC/EN 60320-1 UL 498, CSA C22.2 no. 42 (for cold conditions) pin-temperature 70 °C, 6 A, Protection Class 2
-----------------	-----------------------------------------------------------------------------------------------------------------------------

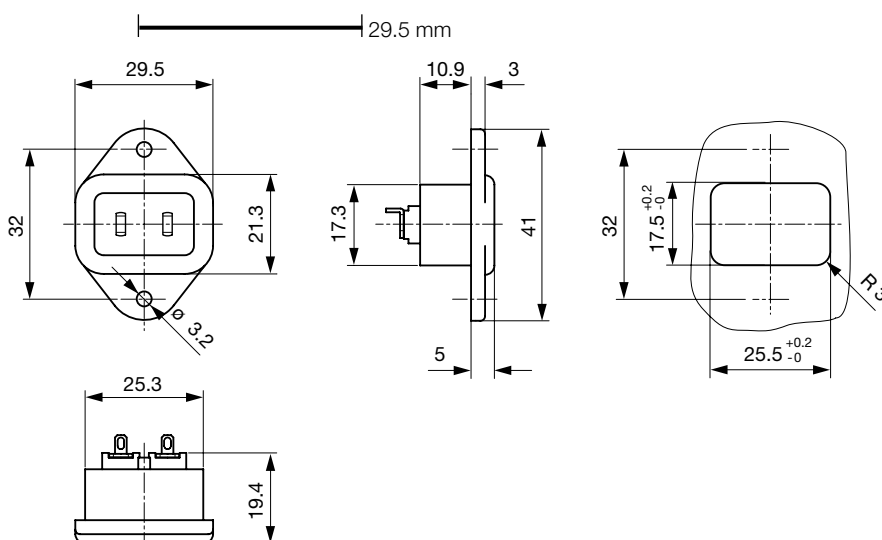
Dimensions

length of the terminal please find at the order code configuration table

Config. Code

Product Configurator

6076 - H - A B C 0 - D - E

The characters are placeholders for the correspondingly keys of selections from the key tables.

6076 - H - A B C 0 - D - E = Type

Type	Configuration key
protection class 2	B

6076 - H - A B C 0 - D - E = Terminals

Terminal L	Configuration key
short solder terminal (L=4,8mm)	2
long solder terminal (L=8,5mm)	3
blade terminal (4,8x0,8mm)	8
blade terminal (6,3x0,8mm)	9

6076 - H - A B C 0 - D - E = Terminals

Terminal N	Configuration key
short solder terminal (L=4,8mm)	2
long solder terminal (L=8,5mm)	3
blade terminal (4,8x0,8mm)	8
blade terminal (6,3x0,8mm)	9

Symbols similar as in table A

6076 - H - A B C 0 - D - E = Terminals

Terminal Ground	Configuration key
without terminal	0

Symbols similar as in table A

6076 - H - A B C 0 - D - E = Color

Color	Configuration key
jet black; RAL9005	A
silver grey; RAL7001	B
pure white; RAL9010	D

standard color: black

6076 - H - A B C 0 - D - E = Style

Style	Configuration key
flange with countersunk holes	1
flange with through holes	2

Packaging unit 50 Pcs

Mating Outlets/Connectors

Category / Description

[Plug Overview complete](#)

IEC Connector C9, Rewireable Appliance Internal

3017

[Plug further types to 6076](#)[Power Cord Overview complete](#)

Power Cord with IEC Connector C9, Straight

3016

Power Cord with IEC Connector C9, Angled

9011

[Power Cord further types to 6076](#)