

# CTGSR74B Series

## From 10 $\mu$ H to 270 $\mu$ H

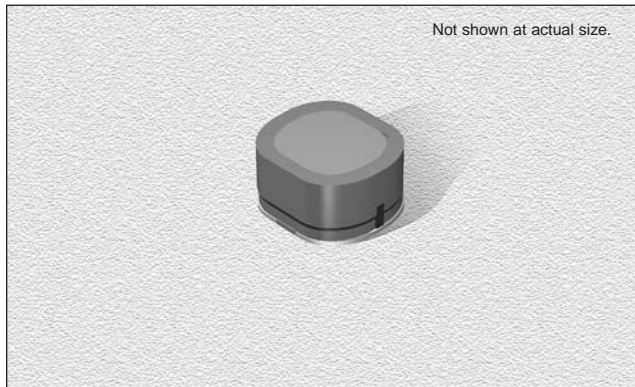

### CHARACTERISTICS

**Description:** SMD shielded power inductor

**Applications:** VTR power supplies, OA equipment, LCD televisions, PC notebooks, portable communication equipment, DC/DC converters

**Operating Temperature:** -40°C to +85°C

**Inductance Tolerance:**  $\pm 15\%$ ,  $\pm 20\%$  &  $\pm 30\%$

**Testing:** Inductance is tested on an HP4285A at specified frequency

**Packaging:** Tape & Reel, 1,000 parts per reel

**Marking:** Marked with inductance code

**Additional Information:** Additional electrical & physical information available upon request

**Samples available. See website for ordering information.**

### SPECIFICATIONS

Parts specify tolerance code when ordering.  
CTGSR74B-100\_ ← L =  $\pm 15\%$ , M =  $\pm 20\%$  & N =  $\pm 30\%$

Part Number	Inductance ( $\mu$ H)	L Test Freq. (.Hz)	DCR Max. ( $\Omega$ )	Rated DC (A)
CTGSR74B-100_	10	2.52M	0.07	1.65
CTGSR74B-120_	12	2.52M	0.07	1.57
CTGSR74B-150_	15	2.52M	0.08	1.39
CTGSR74B-180_	18	2.52M	0.10	1.29
CTGSR74B-220_	22	2.52M	0.13	1.12
CTGSR74B-270_	27	2.52M	0.16	1.06
CTGSR74B-330_	33	2.52M	0.18	0.97
CTGSR74B-390_	39	2.52M	0.18	0.91
CTGSR74B-470_	47	2.52M	0.27	0.80
CTGSR74B-560_	56	2.52M	0.29	0.76
CTGSR74B-680_	68	2.52M	0.33	0.68
CTGSR74B-820_	82	2.52M	0.43	0.62
CTGSR74B-101_	100	1.00k	0.49	0.55
CTGSR74B-121_	120	1.00k	0.68	0.49
CTGSR74B-151_	150	1.00k	0.94	0.44
CTGSR74B-181_	180	1.00k	1.00	0.40
CTGSR74B-221_	220	1.00k	1.18	0.36
CTGSR74B-271_	270	1.00k	1.30	0.33

### PHYSICAL DIMENSIONS

Size	A Max.	B Max.	C Max.	D Ref.
mm	7.35	8.15	4.9	2.1
inches	0.29	0.32	0.19	0.08

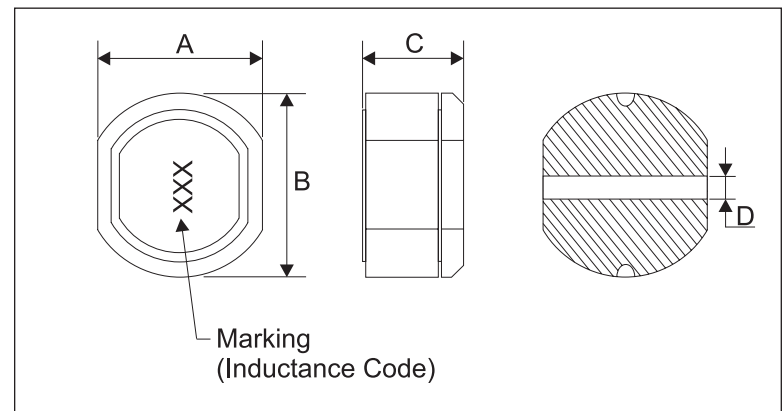

1.06.03