



FCIconnect.com

Copyright FCI

PRODUCT NUMBER

SEE TABLE

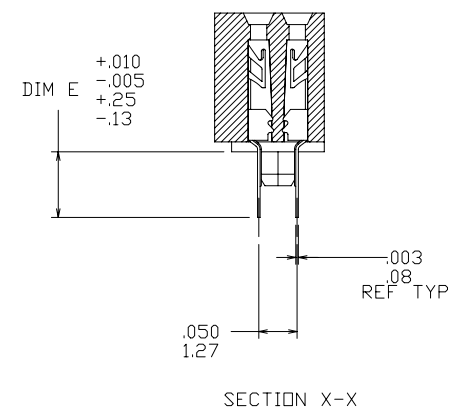
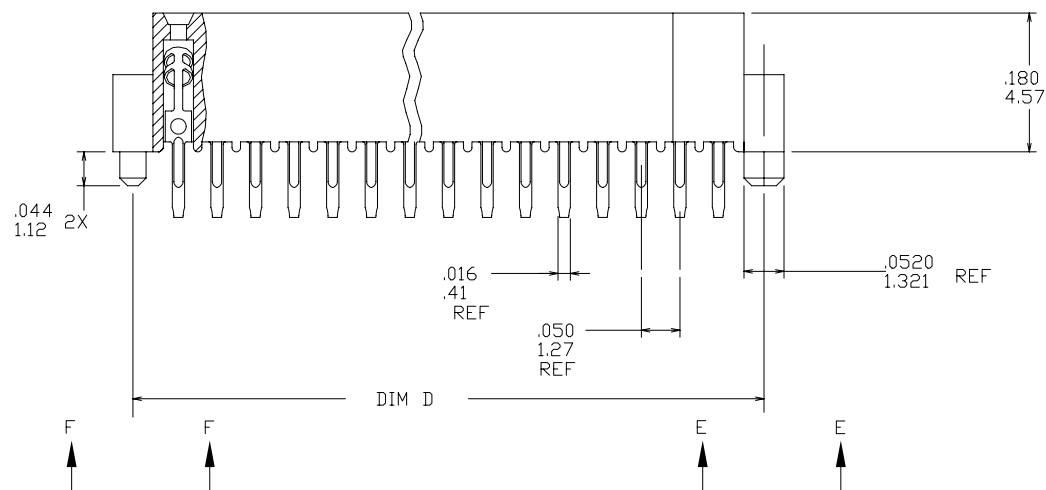
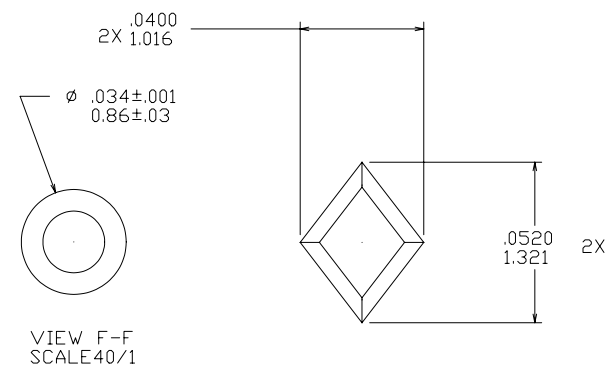
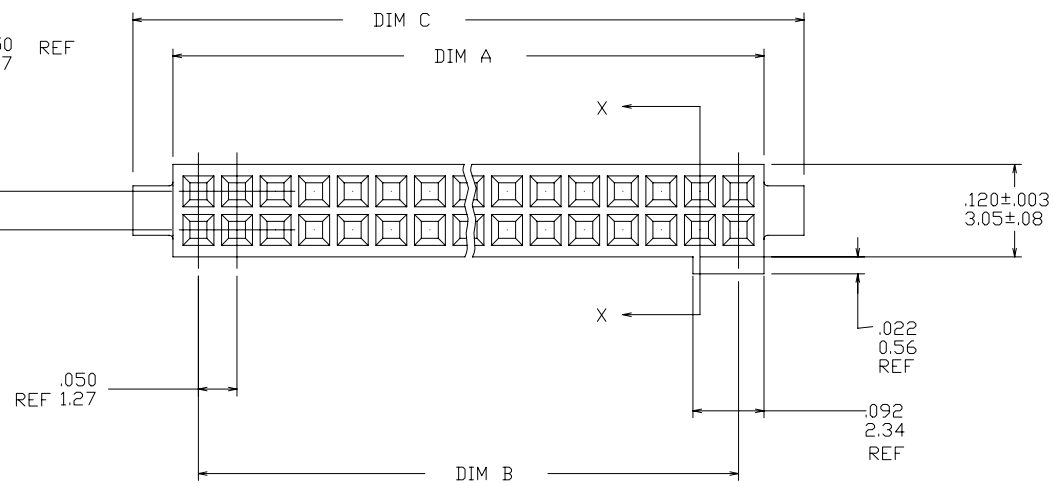

mat'l. code				surface	tolerance	projection	product family		
-				ISO 1302	ISO 406 ISO 1101		RIB CAGE		
ltr	ecn no	dr	date	tolerances unless otherwise specified			title		
A	V70872	SAR	7/16/97	angles	linear	XX ±.01/.3	.050 cc VERT. CARD CONN. THRU MT. W/POL. HOLD DOWN		
B	V02780	DLW	12/01/00			XXX ±.005/-.13			
C	V10994	DLW	3/09/01	0°±2°		XXXX ±.0020/.050	dwg no 73545 sheet 1 of 3 size A3		
D	V11674	CRG	6/14/01	dr	S. ROYER	7/16/97			
E	M05-0123	ERE	6/07/05	engr	D. WHITING	7/16/97	type Product Customer Drawing		
F	M06-0284	AEA	7/27/06	chr	C. GINGRICH	7/16/97			
G	N10-0174	YOH	6/17/10	appd	D. WHITING	7/16/97			
sheet	revision	G	G	G					
index	sheet	1	2	3					



FCIconnect.com

Copyright FCI

PRODUCT NUMBER

SEE TABLE

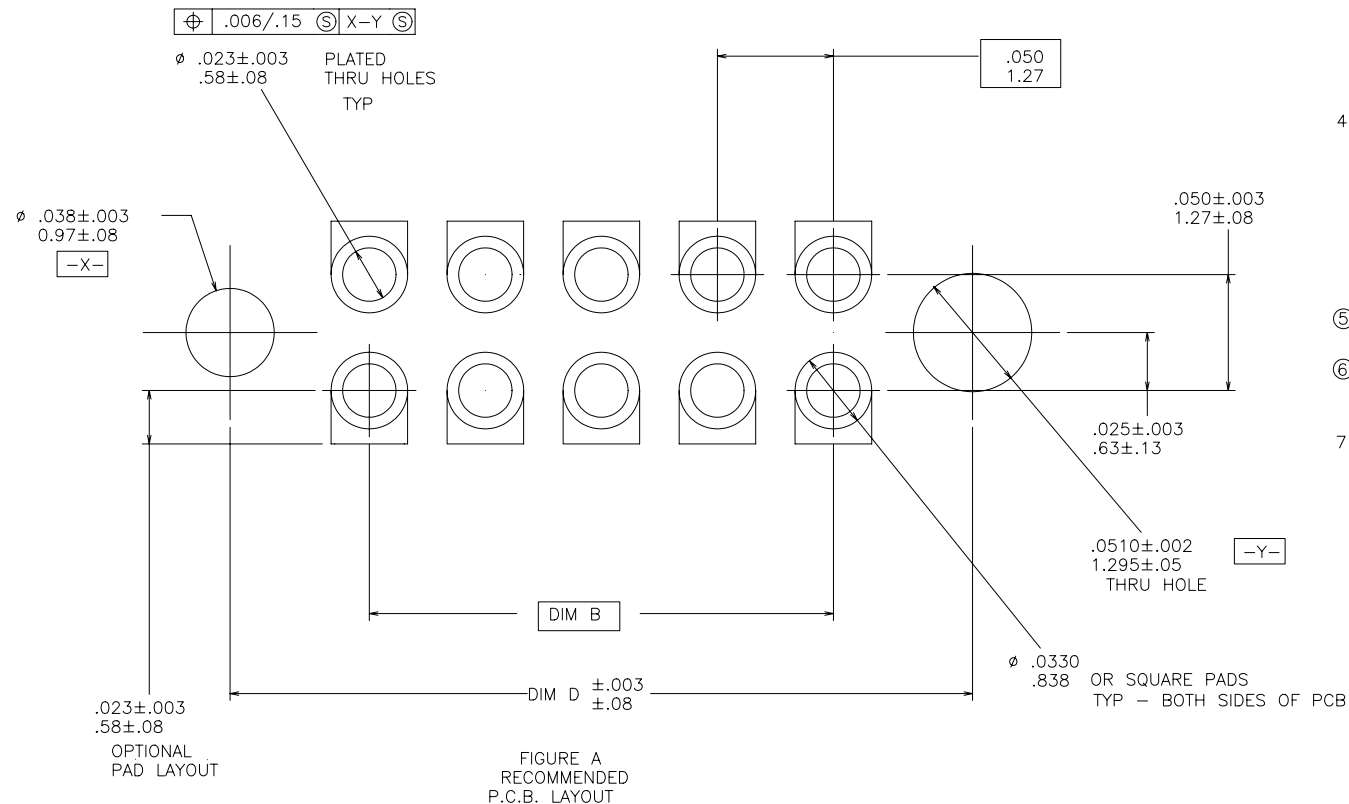
FIGURE A
RECOMMENDED
P.C.B. LAYOUT

NOTES:

- ① HOUSING MATERIAL:
GLASS FILLED THERMOPLASTIC FLAME
RETARDANT PER UL 94V-0
COLOR: NATURAL
- ② TERMINAL MATERIAL: BeCu
- ③ TERMINAL PLATING:
30u"/.76um MIN HARD GOLD
OVER Ni ON CONTACT ZONES.
100u"/2.54um MIN TIN OVER 50u"/1.27um Ni.
IN SOLDERING ZONES.
OTHERWISE GOLD FLASH OR UNPLATED.
- 4 APPLICATION INFORMATION:
A. RECOMMENDED PCB LAYOUT PATTERN IS
SHOWN IN FIGURE A.
B. MATING PINS TO BE .0176/.447 TO
.0181/.459 THICK.
C. MATING PIN TIPS TO BE IN TRUE POSITION
TO MATING GRID WITHIN .006/.15 DIA.
D. SUGGESTED MATING PIN LENGTH .130/3.30
±.010/.25.
- ⑤ ADD "LF" SUFFIX AT THE END OF PART NUMBER
FOR LEAD FREE OPTION.
- ⑥ IF P/N IS LF THE PRODUCT MEETS EUROPEAN UNION
DIRECTIVES AND OTHER COUNTRY REGULATION AS
DESCRIBED IN GS-22-008.
- 7 THE HOUSING WILL WITHSTAND EXPOSURE TO 260°C
PEAK TEMPERATURE FOR 15 SECONDS IN A WAVE
SOLDER APPLICATION WITH A 1.5mm MINIMUM THICK
CIRCUIT BOARD. SEE APPLICATION NOTES/PROCEDURES
IF THEY ARE AVAILABLE.

mat'l. code				surface	tolerance	projection	product family			
-				ISO 1302	ISO 406 ISO 1101		RIB CAGE			
ltr	ecn no	dr	date	tolerances unless otherwise specified			title			
G				angles	linear	XX ±.01/.3 XXX ±.005/.13 XXXX ±.0020/.050	INCH/MM			
				dr	S. ROYER	7/16/97	scale 12:1			
				enrg	D. WHITING	7/16/97				
				chr	C. GINGRICH	7/16/97				
				appd	D. WHITING	7/16/97	dwg no			
sheet	revision						sheet 2 of 3			
index	sheet						73545			
							type			
							Product Customer Drawing			

1		2		3							4	5		6
PRODUCT NO. NOTE 5		SIZE	DIM A	DIM B	DIM C		DIM D		DIM E					
73545-605		2 X 5	.266/6.756	.200/5.08	.370/9.398		.3200/8.128		.085/2.16					
↑ -610		2 X 10	.516/13.106	.450/11.43	.620/15.748		.5700/14.478		↑					
-615		2 X 15	.766/19.456	.700/17.78	.870/22.098		.8200/20.828							
-620		2 X 20	1.016/25.806	.950/24.13	1.120/28.448		1.0700/27.178							
-625		2 X 25	1.266/32.156	1.200/30.48	1.370/34.798		1.3200/33.528							
-630		2 X 30	1.516/38.506	1.450/36.83	1.620/41.148		1.5700/39.878							
-635		2 X 35	1.766/44.856	1.700/43.18	1.870/47.498		1.8200/46.228							
-640		2 X 40	2.016/51.206	1.950/49.53	2.120/53.848		2.0700/52.578							
↓ -645		2 X 45	2.266/57.556	2.200/55.88	2.370/60.198		2.3200/58.928		↓					
73545-650		2 X 50	2.516/63.906	2.450/62.23	2.620/66.548		2.5700/65.278		.085/2.16					



mat'l. code				surface		tolerance		projection		product family											
-				ISO 1302		ISO 406 ISO 1101				RIB CAGE											
ltr		ecn no		dr		date		tolerances unless otherwise specified													
G										.050 cc VERT. CARD CONN. THRU MT. W/POL. HOLD DOWN											
						angles		linear		scale 1:1											
						0°±2'															
						dr		S. ROYER		7/16/97											
						engr		D. WHITING		7/16/97											
						chr		C. GINGRICH		7/16/97											
						appd		D. WHITING		7/16/97											
sheet index		revision										dwg no									
		sheet										sheet 3 of 3									
												73545									
												A3									
												type Product Customer Drawing									