

GST Series

High Resistance / Thick Film Leaded Resistors



- Resistances from 1M to 1TOhms
- Power Rating 0.5 to 2Watts
- Resistance Tolerances to $\pm 0.5\%$
- TCR's to $\pm 25\text{ppm}/^\circ\text{C}$
- Non-Magnetic
- High Value Thick Film Resistance Element

SPECIFICATIONS

Type		1210	2512	4020
Power Rating (W) ¹		0.5	1.0	2.0
Working Voltage (VAC)	Trimmed	300	1200	4000
	Untrimmed ($\geq 5\%$ tol.)	1000	2500	6000
Resistance Range (Ω)		Tolerances Available (%) Temperature Coefficients Available (\pm ppm/K) ² Voltage Coefficient (ppm / V) Typical Value		
1M - 100M		0.5% to 10% 25 / 50 / 100 50ppm/V	0.5% to 10% 25 / 50 / 100 10ppm/V	0.25% to 10% 25 / 50 / 100 5ppm/V
>100M - 500M		2% to 20% 50 / 100 / 250 100ppm/V	1% to 20% 25 / 50 / 100 25ppm/V	0.5% to 20% 25 / 50 / 100 10ppm/V
>500M - 1G		5% to 20% 100 / 250 100ppm/V	1% to 20% 100 / 250 25ppm/V	1% to 20% 25 / 50 / 100 10ppm/V
>1G - 10G		5% to 30% 250 / 500 500ppm/V	2% to 20% 100 / 250 100ppm/V	2% to 20% 50 / 100 25ppm/V
>10G - 100G		5% to 30% 500 / 1000 1000ppm/V	5% to 30% 250 / 500 250ppm/V	5% to 30% 100 / 250 100ppm/V
>100G - 1T		-	10% to 50% 500 / 1000 500ppm/V	5% to 30% 250 / 500 250ppm/V

¹W @ 70 °C / 0W @ 125 °C
²25 / 50 PPM : +25°C to +85°C
 Labeling on parts available upon request

Note: Do not use Acetone or Methylene Chloride for cleaning as they destroy coating.

GST Series

High Resistance / Thick Film Leded Resistors



SPECIFICATIONS (continued)

Specification	Value		
Temperature Range	-55°C to +125°C		
Climactic Category	55 / 125 / 56		
Long Term Stability	Max ΔR		
	<1 G Ω	1 G Ω - 10 G Ω	>10 G Ω
Storage 125°C / 1000h	$\pm 1\%$	$\pm 2\%$	$\pm 5\%$
Maximum Voltage / 1000h	$\pm 0.5\%$	$\pm 1\%$	$\pm 2\%$

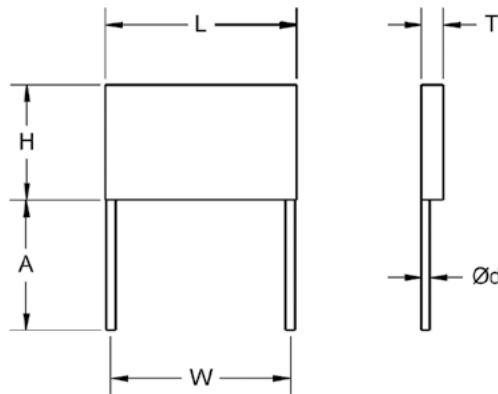

Type	Dimensions					
	L ± 0.008 [± 0.2]	H ± 0.008 [± 0.2]	T ± 0.008 [± 0.2]	W ± 0.008 [± 0.2]	A +0 / -0.08 [+0 / -2.0]	d ± 0.002 [± 0.05]
GST 1210	0.126 [3.2]	0.098 [2.5]	0.035 [0.9]	0.079 [2.0]	0.79 [20]	0.016 [0.4]
GST 2512	0.250 [6.3]	0.138 [3.5]	0.039 [1.0]	0.217 [5.5]	0.79 [20]	0.016 [0.4]
GST 4020	0.400 [10.2]	0.200 [5.1]	0.039 [1.0]	0.374 [9.5]	0.79 [20]	0.016 [0.4]

Power Derating Curve

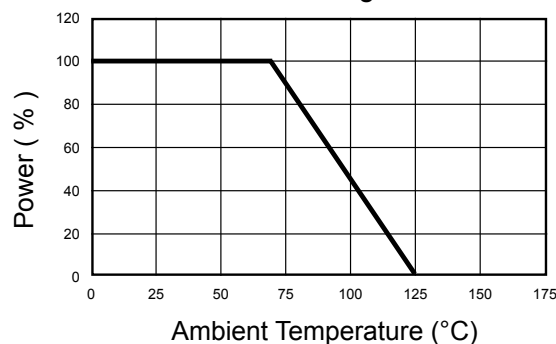

Ordering Information

Part Description: Part Type - Resistance - Tolerance - TCR

Example: GST 2512 10G 10% 100ppm

(Note: if no TCR is Specified / The highest value will be supplied)