

REV.	ECN.NO.	MODIFY.CONTENT	DATE
1	S0905043	Initial release	5/20'09
2	S0907005	Change The Switch Pin	7/01'09

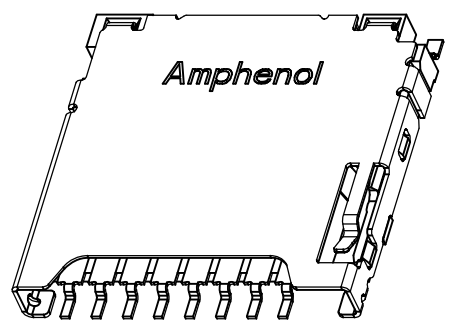

GENERAL TOLERANCE	TOLERANCE	FILE.NO.	114-00841	PART.NO.	114-00841-68	DRAWN	Ray lee	MATERIAL		SCALE	5:1
X±0.50	x. ± 5°	REV.	2	TITLE	Micro SD None Push Connector Top Mount	CHECKED	Henry	DATE	2009/05/20	UNIT	MM
.X±0.38	.x ± 2°	SIZE		SHEET	1/2	APPROVED	Henry	Amphenol Shouhmin Industry			
.XX±0.25	.xx ± 1°	A4									

REV.	ECN.NO.	MODIFY.CONTENT	DATE
1	S0905043	Initial release	5/20'09
2	S0907005	Change The Switch Pin	7/01'09

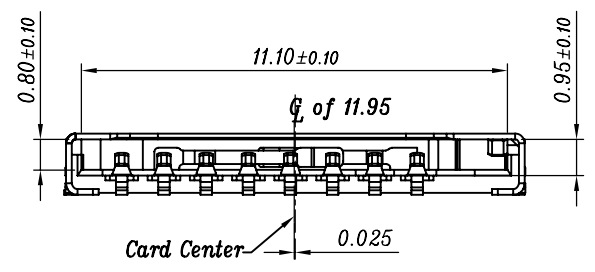
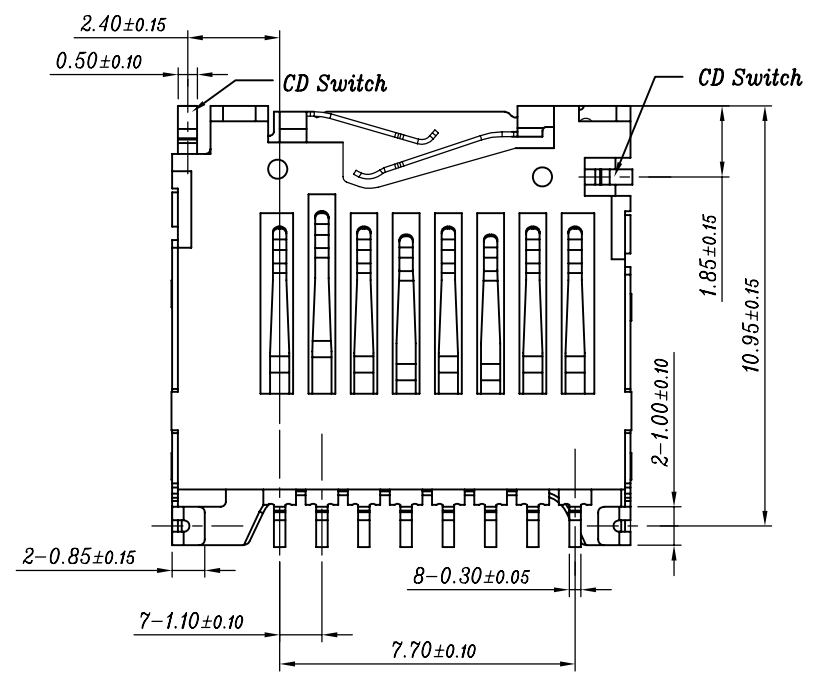
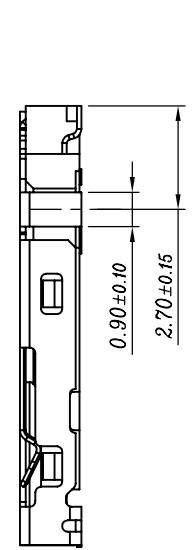
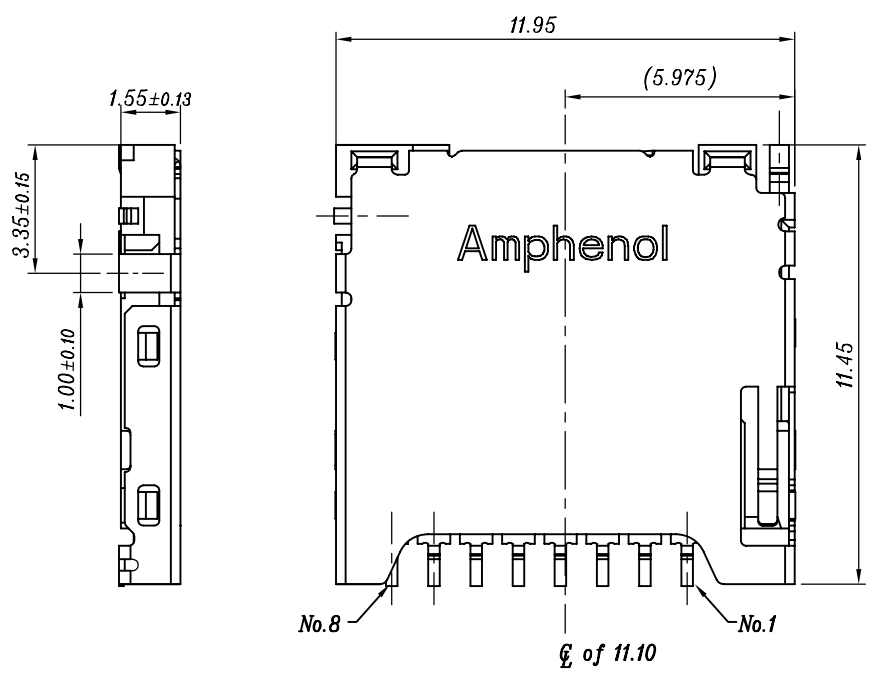
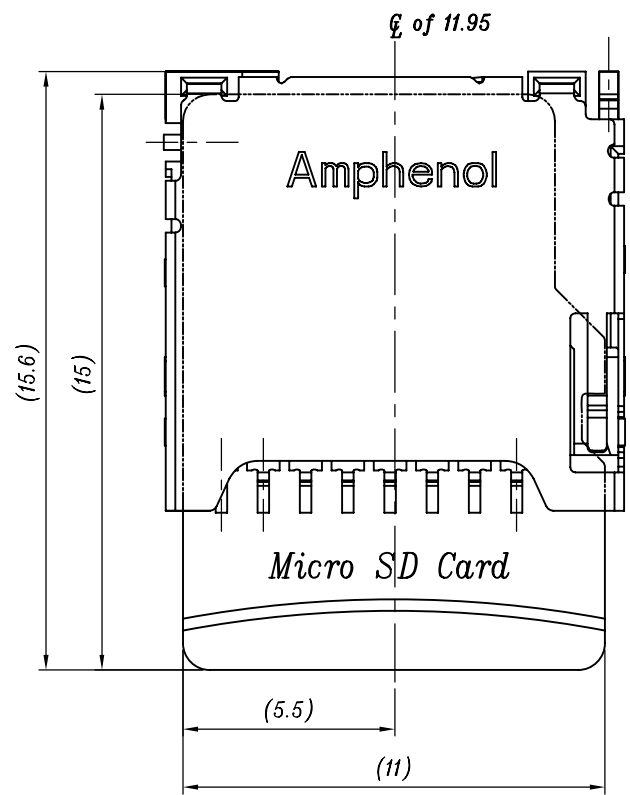

PIN Assignments

PIN NO.	Micro SD
1	Date Line[Bit 2]
2	Card Detect/ Date Line[Bit 3]
3	Command/Response
4	Supply voltage
5	Clock
6	Supply voltage ground
7	Date Line[Bit 0]
8	Date Line[Bit 1]

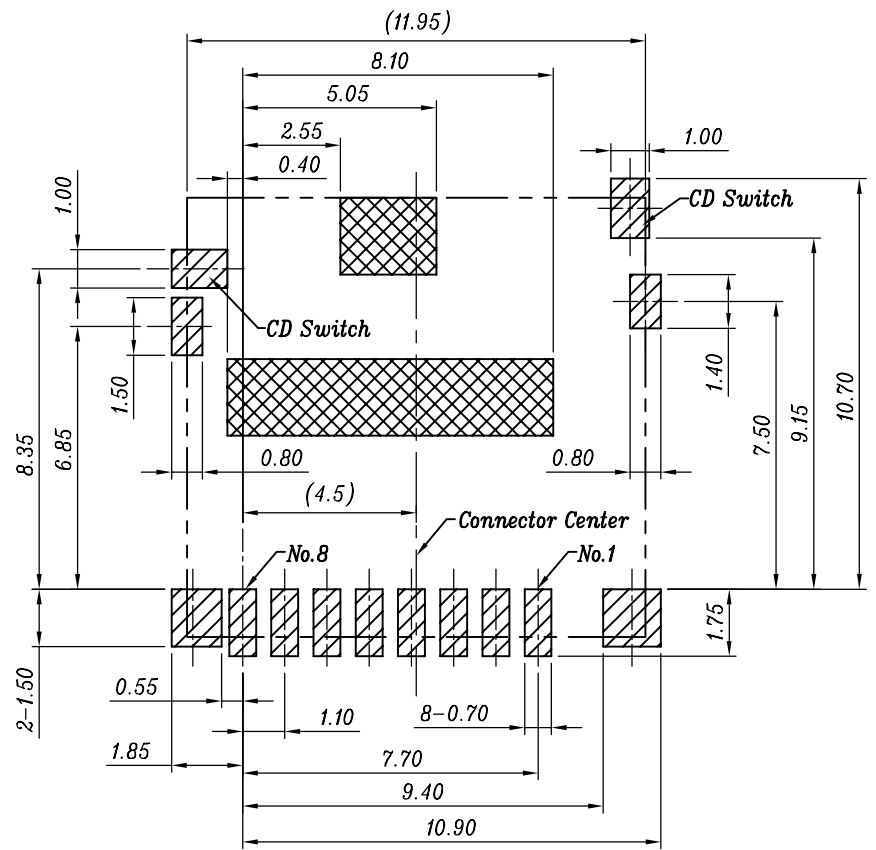

RECOMMENDED P.C.B LAYOUT

P.C.B TOLERANCE: ±0.05

- Connector Area
- PAD Area
- Pattern Prohibited Area

Note:

1. Material:
Housing: LCP Black UL 94V-0
Contact: Copper alloy
Shell: Stainless steel
2. Plating:
Contact Area: Plating Au
Solder tail: Plating Tin
Shell: Plating weldable Ni
3. Tail Coplanarity 0.12mm Max.
4. The Part must compliant AMSI'S ROHS SPEC.

GENERAL TOLERANCE	FILE.NO.	114-00841	PART.NO.	114-00841-68	DRAWN	Ray lee	MATERIAL	SCALE	5:1	
X.±0.50	REV.	2	TITLE	Micro SD None Push Connector Top Mount	CHECKED	Henry	DATE	2009/05/20	UNIT	MM
.X±0.38	SIZE	A4	SHEET	2/2	APPROVED	Henry	Amphenol Shouhmin Industry			
.XX±0.25										

