

SMC: Clamp Flexible Cable

Straight Bulkhead Jack Captive Contact

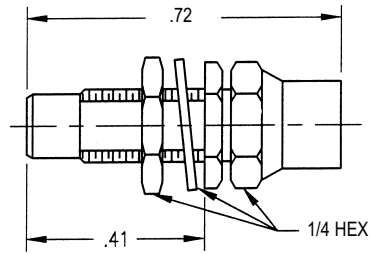

Part Number	Cable	Mounting Hole
501-780-0360H	RG-178	No. 080
501-780-0630H	RG-316	No. 080
501-780-0631H	RG-316 double shielded	No. 080

- See page 99 for cable assembly procedures: No. 7-03
- See page 83 for mounting hole layout.
- Part number shown is for gold plated.
- For nickel plate change suffix to "N".

Right Angle Plug

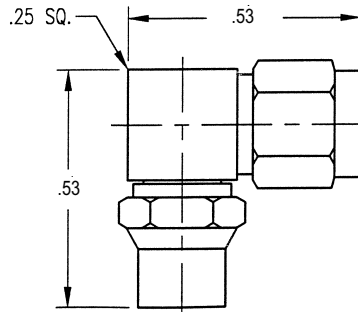

Part Number	Cable
502-700-0360H	RG-178
502-700-0630H	RG-316
502-700-0631H	RG-316 double shielded

- See page 100 for cable assembly procedures: No. 7-04
- Part number shown is for gold plated.
- For nickel plate change suffix to "N".

SMC: Printed Circuit Receptacles

Straight Plug

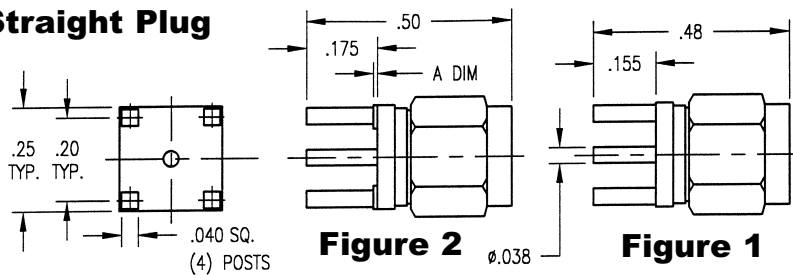

Part Number	Mounting Hole	"A" DIM	Figure
500-060-0040H	No. 060 B	.000	1
500-060-0047H	No. 060 B	.020	2

- See page 83 for mounting hole layout.
- Part number shown is for gold plated.
- For nickel plate change suffix to "N".

Straight Jack

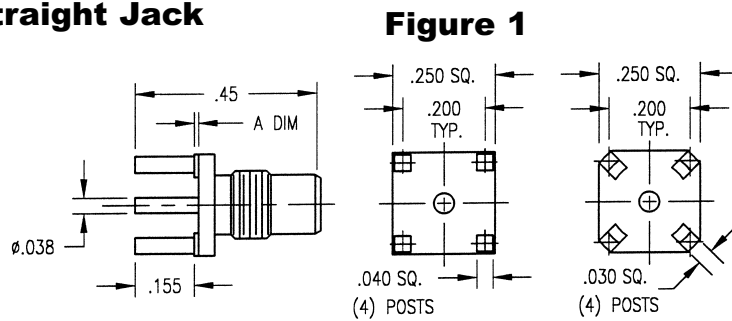

Part Number	Mounting Hole	"A" DIM	Figure
501-060-0040H	No. 060 B	.000	1
501-060-0047H	No. 060 A	.000	2
501-060-0048H	No. 060 A	.020	2

- See page 83 for mounting hole layout.
- Part number shown is for gold plated.
- For nickel plate change suffix to "N".

Right Angle Jack

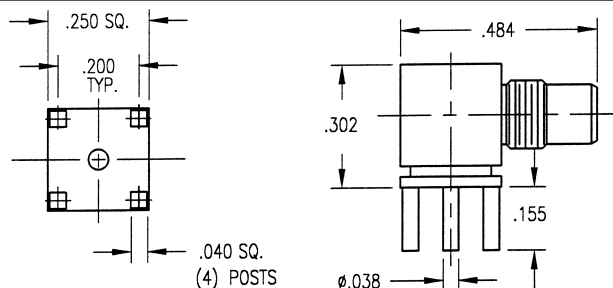

Part Number	Mounting Hole
503-060-0040H	No. 060 B

- See page 83 for mounting hole layout.
- Part number shown is for gold plated.
- For nickel plate change suffix to "N".

Note: Dimensions shown in inches.

Winchester/Retconn