

## SPECIFICATIONS:

MATERIAL:-

MOULDING: PBT UL94V-0

ELECTRICAL:-

CURRENT RATING: 1A AC/DC MAX.

WORKING VOLTAGE: 100V AC/DC

WITHSTANDING VOLTAGE: 500V AC/MINUTE

CONTACT RESISTANCE: 20 mΩ MAX.

INSULATION RESISTANCE: 100 MΩ MIN.

ENVIRONMENTAL:-

TEMPERATURE RANGE: -25°C TO +85°C

OTHERS:-

ACCEPTS: M30-3000046 CRIMP TERMINAL

MATES WITH: WAFER M30-301 XX 46R

M30-401 XX 46R

M30-310 XX 46

M30-410 XX 46

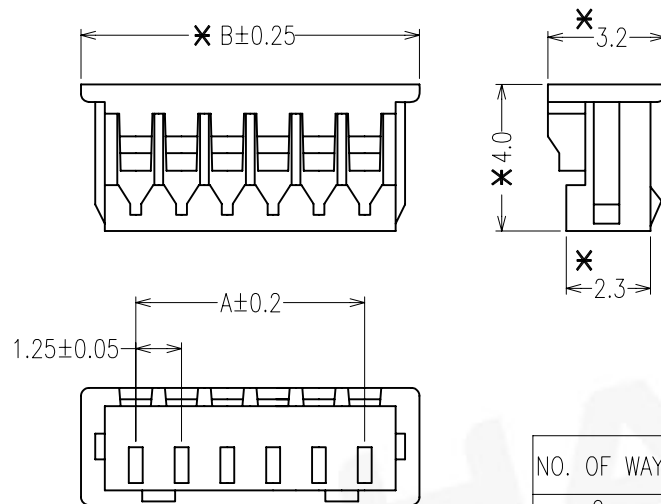

NO. OF WAYS	PART NO.	DIM	
		A	B
2	M30-1300200R	1.25	4.25
3	M30-1300300R	2.50	5.50
4	M30-1300400R	3.75	6.75
5	M30-1300500R	5.00	8.00
6	M30-1300600R	6.25	9.25
7	M30-1300700R	7.50	10.50
8	M30-1300800R	8.75	11.75
9	M30-1300900R	10.00	13.00
10	M30-1301000R	11.25	14.25
11	M30-1301100R	12.50	15.50
12	M30-1301200R	13.75	16.75
13	M30-1301300R	15.00	18.00
14	M30-1301400R	16.25	19.25
15	M30-1301500R	17.50	20.50

NOTES: ALL DIMENSIONS AND NOTES  
MARKED \* ARE CRITICAL AND  
MUST BE CHECKED IN ACCORDANCE  
WITH QUALITY DOC. QI-02A

Allan	3	27.06.08	A139
Allan	2	20.02.08	A112
HTUT	1	14.02.07	-
NAME	ISS.	DATE	C/NOTE

APPROVED:

CHECKED:

DRAWN: Allan

ORDER CODE

M30-130 XX 00

NO. OF WAYS

CUSTOMER REF.:

ASSEMBLY DRG:

# HARWIN

HARWIN USA  
TEL: 603 893 5376  
FAX: 603 893 5396  
mis@harwin.com

HARWIN Europe (UK)  
TEL: 023 9231 4545  
FAX: 023 9231 4590  
mis@harwin.co.uk

HARWIN Asia  
TEL: +65 6 779 4909  
FAX: +65 6 779 3868  
mis@harwin.com.sg

THIS DRAWING AND ANY  
INFORMATION OR DESCRIPTIVE  
MATTER SET OUT HEREON ARE  
CONFIDENTIAL AND COPYRIGHT  
PROPERTY OF THE HARWIN  
GROUP AND MUST NOT BE  
DISCLOSED, LOANED, COPIED  
OR USED FOR MANUFACTURING,  
TENDERING OR FOR ANY  
OTHER PURPOSE WITHOUT  
THEIR WRITTEN PERMISSION.

## TOLERANCES

X. = ±1mm  
X.X = ±0.25mm  
X.XX = ±0.15mm  
X.XXX = ±0.08mm

ANGLES = ±5°  
UNLESS STATED

## MATERIAL:

SEE NOTES

FINISH: SEE NOTES

S/AREA: mm<sup>2</sup>

## TITLE:

1.25MM PITCH SINGLE ROW  
HOUSING

## DRAWING NUMBER:

M30-130 XX 00

SHT  
1  
OF  
1