

## Carrier Type Low Profile

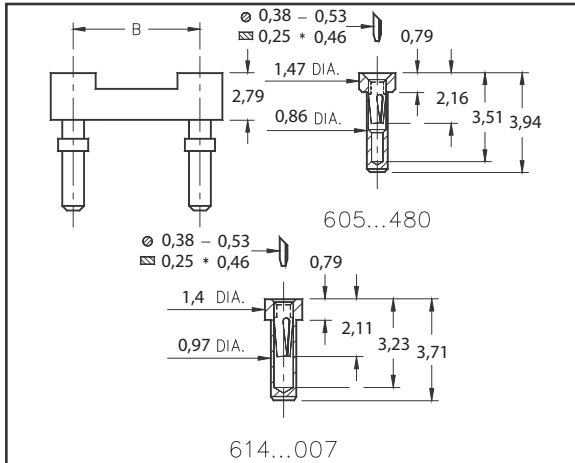

- Low profile receptacles sit only 0,79 high above the board.
- Removable plastic carriers can be returned for reloading.
- Hi-Rel, 3-finger #11 BeCu contact is rated at 3 amps. See page 206 for details.
- Uses M-M#1407 & 0548 receptacles. See page 126 for details.

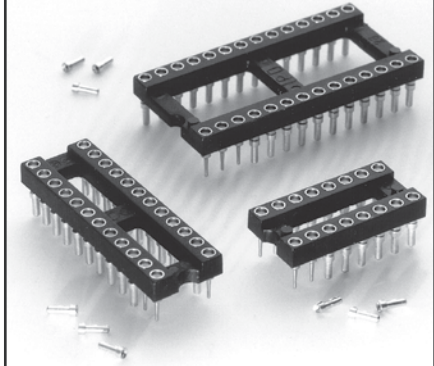

Total number of pins				Quantity per tube	Ordering Information		
	A	B	C		Length = 3,71	Length = 3,94	
					(0,99 Min. Mounting Hole)	(0,89 Min. Mounting Hole)	
10	12,6	5,08	7,6	40	614-XX-210-31-007000	605-XX-210-11-480000	
4	5,0	7,62	10,1	102	614-XX-304-31-007000	605-XX-304-11-480000	
6	7,6	7,62	10,1	67	614-XX-306-31-007000	605-XX-306-11-480000	
8	10,1	7,62	10,1	50	614-XX-308-31-007000	605-XX-308-11-480000	
10	12,6	7,62	10,1	40	614-XX-310-31-007000	605-XX-310-11-480000	
14	17,7	7,62	10,1	28	614-XX-314-31-007000	605-XX-314-11-480000	
16	20,3	7,62	10,1	25	614-XX-316-31-007000	605-XX-316-11-480000	
18	22,8	7,62	10,1	22	614-XX-318-31-007000	605-XX-318-11-480000	
20	25,3	7,62	10,1	20	614-XX-320-31-007000	605-XX-320-11-480000	
22	27,8	7,62	10,1	18	614-XX-322-31-007000	605-XX-322-11-480000	
24	30,4	7,62	10,1	16	614-XX-324-31-007000	605-XX-324-11-480000	
28	35,5	7,62	10,1	14	614-XX-328-31-007000	605-XX-328-11-480000	
20	25,4	10,16	12,7	20	614-XX-420-31-007000	605-XX-420-11-480000	
22	27,8	10,16	12,7	18	614-XX-422-31-007000	605-XX-422-11-480000	
24	30,4	10,16	12,7	16	614-XX-424-31-007000	605-XX-424-11-480000	
28	35,5	10,16	12,7	14	614-XX-428-31-007000	605-XX-428-11-480000	
32	40,6	10,16	12,7	12	614-XX-432-31-007000	605-XX-432-11-480000	
24	30,5	15,24	17,7	16	614-XX-624-31-007000	605-XX-624-11-480000	
28	35,5	15,24	17,7	14	614-XX-628-31-007000	605-XX-628-11-480000	
32	40,6	15,24	17,7	12	614-XX-632-31-007000	605-XX-632-11-480000	
36	45,7	15,24	17,7	11	614-XX-636-31-007000	605-XX-636-11-480000	
40	50,8	15,24	17,7	10	614-XX-640-31-007000	605-XX-640-11-480000	
42	53,3	15,24	17,7	9	614-XX-642-31-007000	605-XX-642-11-480000	
48	60,9	15,24	17,7	8	614-XX-648-31-007000	605-XX-648-11-480000	
50	63,5	15,24	17,7	8	614-XX-650-31-007000	605-XX-650-11-480000	
52	66,0	15,24	17,7	7	614-XX-652-31-007000	605-XX-652-11-480000	
50	63,5	22,86	25,3	8	614-XX-950-31-007000	605-XX-950-11-480000	
52	66,0	22,86	25,3	7	614-XX-952-31-007000	605-XX-952-11-480000	
64	81,2	22,86	25,3	6	614-XX-964-31-007000	605-XX-964-11-480000	
SPECIFY PLATING CODE XX=					13	93	43
Sleeve (Pin)					0,25µm Au	5,08µm Sn/Pb	5,08µm Sn
Contact (Clip)					0,76µm Au	0,76µm Au	0,76µm Au

**XX=Plating Code  
See Below**

**For RoHS compliance, select  $\diamond$  plating code. For the all gold option (XX=13) also change part number from 6XX-XX-XXX-X1-XXX000 to 6XX-13-XXX-X1-XXX100**





PLATING OPTIONS FOR HEADERS, SOCKETS AND SPRING PINS

*Some Platings not available for Stamped DIP Sockets or PLCC's*

<b>HEADERS</b>	<b>PIN</b>		<b>ROHS</b>	<b>STANDARD</b>
10	10u" gold over 100-150u" nickel		YES	YES
40	200u" matte tin over 100-150u" nickel		YES	YES
90	200u" tin/lead over 100-150u" nickel		NO	YES
<b>SOCKETS</b>	<b>SHELL</b>	<b>CLIP</b>		
13	10u" gold over 100-150u" nickel	30u" gold over 50-100u" nickel	YES	YES
41	200u" matte tin over 100-150u" nickel	10u" gold over 50-100u" nickel	YES	NO
43	200u" matte tin over 100-150u" nickel	30u" gold over 50-100u" nickel	YES	YES
44	200u" matte tin over 100-150u" nickel	150u" matte tin over 50-100u" nickel	YES	YES
91	200u" tin/lead over 100-150u" nickel	10u" gold over 50-100u" nickel	NO	YES
93	200u" tin/lead over 100-150u" nickel	30u" gold over 50-100u" nickel	NO	YES
99	200u" tin/lead over 100-150u" nickel	150u" tin/lead over 50-100u" nickel	NO	YES
<b>MILITARY</b>	<b>SHELL</b>	<b>CLIP</b>		
33	30u" gold over 100-150u" nickel	30u" gold over 50-100u" nickel	YES	YES
83	100u" tin/lead over 100-150u" nickel	30u" gold over 50-100u" nickel	NO	YES
88	100u" tin/lead over 100-150u" nickel	100u" tin/lead over 50-100u" nickel	NO	YES
<i>Note: Gold platings are minimum thickness and tin/lead is 60/40 alloy</i>				
<b>SPRING HEADER PIN</b>	<b>SHELL</b>	<b>SPRING</b>		
22	20u" gold over 100-150u" nickel	10u" gold over 50-100u" nickel	YES	YES