

RECOMMENDED PANEL CUTOUT

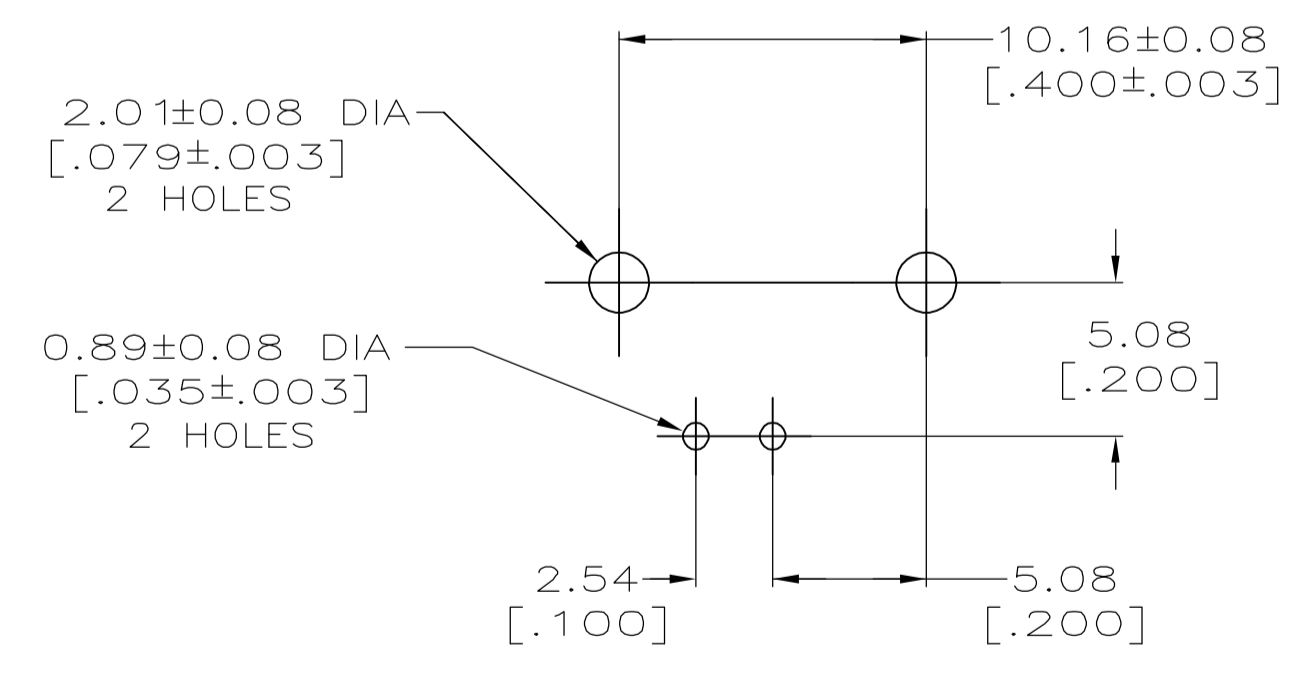

PCB CONFIGURATION

- ① ZINC PER QQ-Z-363.
- ② POLYMETHYLPENTENE PER ASTM-D-1238.
- ③ PHOSPHOR BRONZE PER QQ-B-750.
- ④ BRASS PER ASTM-B-453.
- ⑤ BRASS PER ASTM-B-16.
- ⑥ NICKEL PLATE PER QQ-N-290, 3.81 μm [.000150] MINIMUM THICK.
- ⑦ TIN PLATE PER ASTM-B-545, 3.81 μm [.000150] MINIMUM THICK.
- ⑧ SEE INSTRUCTION SHEET 2769.
- ⑨ TIN PLATE PER ASTM-B-545, 3.81 μm [.000150] MINIMUM THICK.

SUPERSEDED BY 227661-1	⑨	⑨	⑨	⑨	⑨	9-227661-0
	⑦	⑦	⑦	⑦	⑦	227661-2
	⑦	⑦	⑦	⑦	⑦	227661-1
	GROUND POST PLATING	CONTACT POST PLATING	MOUNTING POST PLATING	CONTACT PLATING	SHELL ASSY PLATING	PART NUMBER

THIS DRAWING IS A CONTROLLED DOCUMENT.

DIMENSIONS: INCHES	TOLERANCES UNLESS OTHERWISE SPECIFIED:	DWG: J. LIPPERT 6-29-92	Tyco Electronics Corporation Harrisburg, PA 17105-3608
0 PLC ± -	1 PLC ± -	CHK: A. GABANY 7-2-92	
2 PLC ± 0.05 [.002]	3 PLC ± -	APVD: J. LIPPERT 07-30-82	NAME: JACK, RIGHT ANGLE, PCB 50 OHM, SERIES BNC
4 PLC ± -	ANGLES ± -	PRODUCT SPEC: 108-12078	SIZE: A1
MATERIAL FINISH	① ② ③ ④ ⑤ ⑥ ⑦ ⑧ ⑨	APPLICATION SPEC: -	SCALE: 4:1
WEIGHT: -	CUSTOMER DRAWING	RESTRICTED TO: -	SHEET 1 OF 1

DATE: 00779 ©=227661