

MATERIALS

| | |
|------------------|--------------------------|
| BODY | BRASS GOLD PLATED |
| CONTACT | GOLD PLATED |
| INSULATOR | PTFE |
| | |

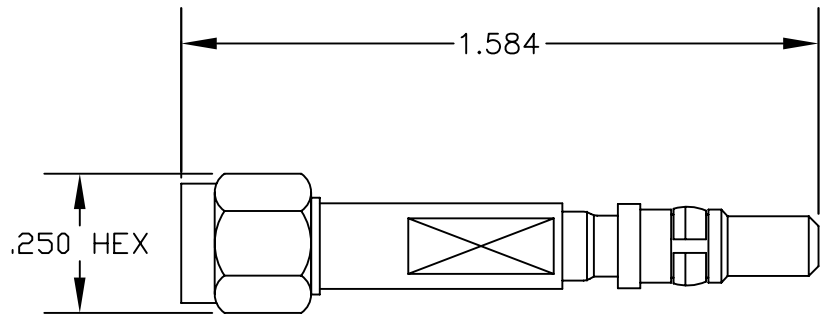

PASTERNACK ENTERPRISES, INC.
 P.O BOX 16759, IRVINE, CA 92623
 PHONE (949) 261-1920 FAX (949) 261-7451
 WEB ADDRESS: www.pasternack.com
 E-MAIL ADDRESS: sales@pasternack.com
COAXIAL & FIBER OPTICS

| | | | | | |
|---------------|--|--------------------------------------|--|----------------|-----------------|
| DWG TITLE | | DES. SMA MALE TO D SUBMINIATURE PLUG | | | |
| PE9425 | | SIZE A | | FSCM NO. 53919 | CAD FILE 092002 |
| | | SCALE N/A | | | 127 |

NOTES:
 1. UNLESS OTHERWISE SPECIFIED ALL DIMENSIONS ARE NOMINAL.
 2. ALL SPECIFICATIONS ARE SUBJECT TO CHANGE WITHOUT NOTICE AT ANY TIME.