

Coaxial

Adapter, N-MALE to SMA-F

NM-SF50+

50Ω

DC to 18 GHz



CASE STYLE: DJ825

Maximum Ratings

Operating Temperature	-55°C to 100°C
Storage Temperature	-55°C to 100°C

Permanent damage may occur if any of these limits are exceeded.

Features

- flat response
- excellent VSWR
- passivated stainless steel
- low cost adapters, available from stock

Connectors	Model	Price	Qty.
Conn1 N-MALE	Conn2 SMA-F	NM-SF50+	\$22.95 ea. (1-49)

Applications

- interconnection of RF cables and equipment

+ RoHS compliant in accordance with EU Directive (2002/95/EC)

The +Suffix has been added in order to identify RoHS Compliance. See our web site for RoHS Compliance methodologies and qualifications.

Electrical Specifications T_{AMB}=25°C

FREQUENCY (GHz)	INSERTION LOSS (dB)	VSWR (:1) Max.		
		DC-8 GHz	DC-12.4 GHz	DC-18 GHz
f _L -f _U	Typ.			
DC-18	0.1	1.15	1.25	1.25

Outline Drawing

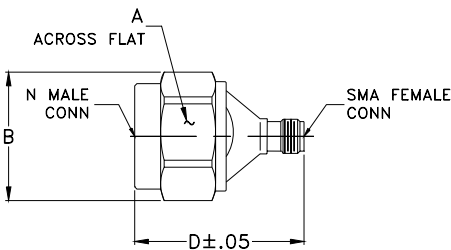

Outline Dimensions (inch/mm)

A	B	C	D	E	wt
.812	.90	--	1.24	--	grams
20.62	22.86	--	31.50	--	33.6

Typical Performance Data

Frequency (MHz)	Insertion Loss (dB)	VSWR (:1)	
		N-MALE	SMA-F
10.00	0.00	1.00	1.00
50.00	0.00	1.00	1.00
100.00	0.00	1.00	1.00
100.00	0.00	1.00	1.00
500.00	0.02	1.01	1.01
1000.00	0.04	1.01	1.01
2000.00	0.05	1.02	1.02
3000.00	0.05	1.03	1.02
4000.00	0.07	1.04	1.04
5000.00	0.09	1.04	1.04
6000.00	0.10	1.05	1.03
8000.00	0.17	1.03	1.03
9000.00	0.12	1.01	1.03
10000.00	0.13	1.02	1.06
12000.00	0.10	1.04	1.03
13000.00	0.04	1.03	1.04
15000.00	0.01	1.09	1.09
16000.00	0.02	1.13	1.05
17000.00	0.10	1.11	1.05
18000.00	0.01	1.03	1.03

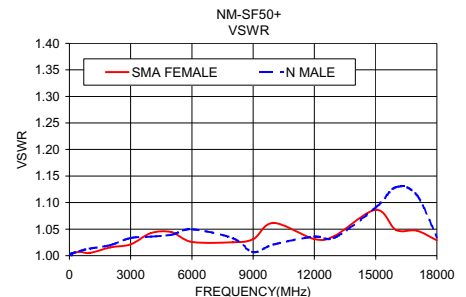
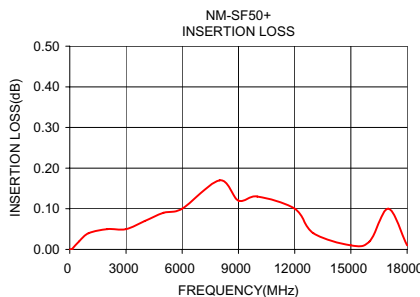

P.O. Box 350166, Brooklyn, New York 11235-0003 (718) 934-4500 Fax (718) 332-4661 For detailed performance specs & shopping online see Mini-Circuits web site

The Design Engineers Search Engine Provides ACTUAL Data Instantly From MINI-CIRCUITS At: www.minicircuits.com

IF/RF MICROWAVE COMPONENTS

REV. D
M108294
NM-SF50+
EE-9107
RS/TD/CP/AM
070725