

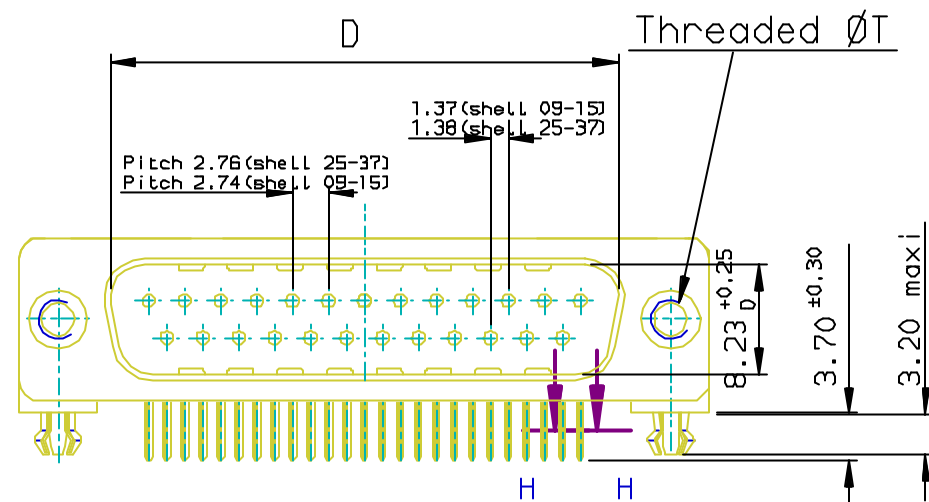

Copyright FCI.

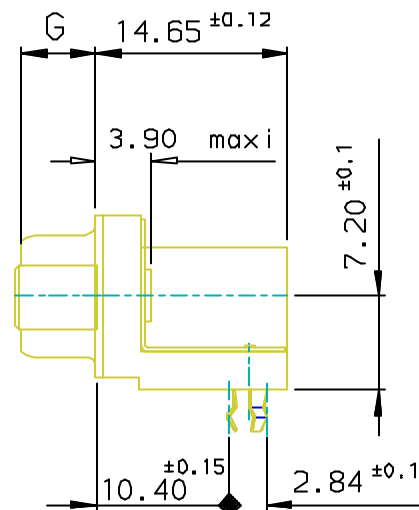

PC card drilling dimensions (after plating)  
(thickness 1.60 ± 0.20 mm)

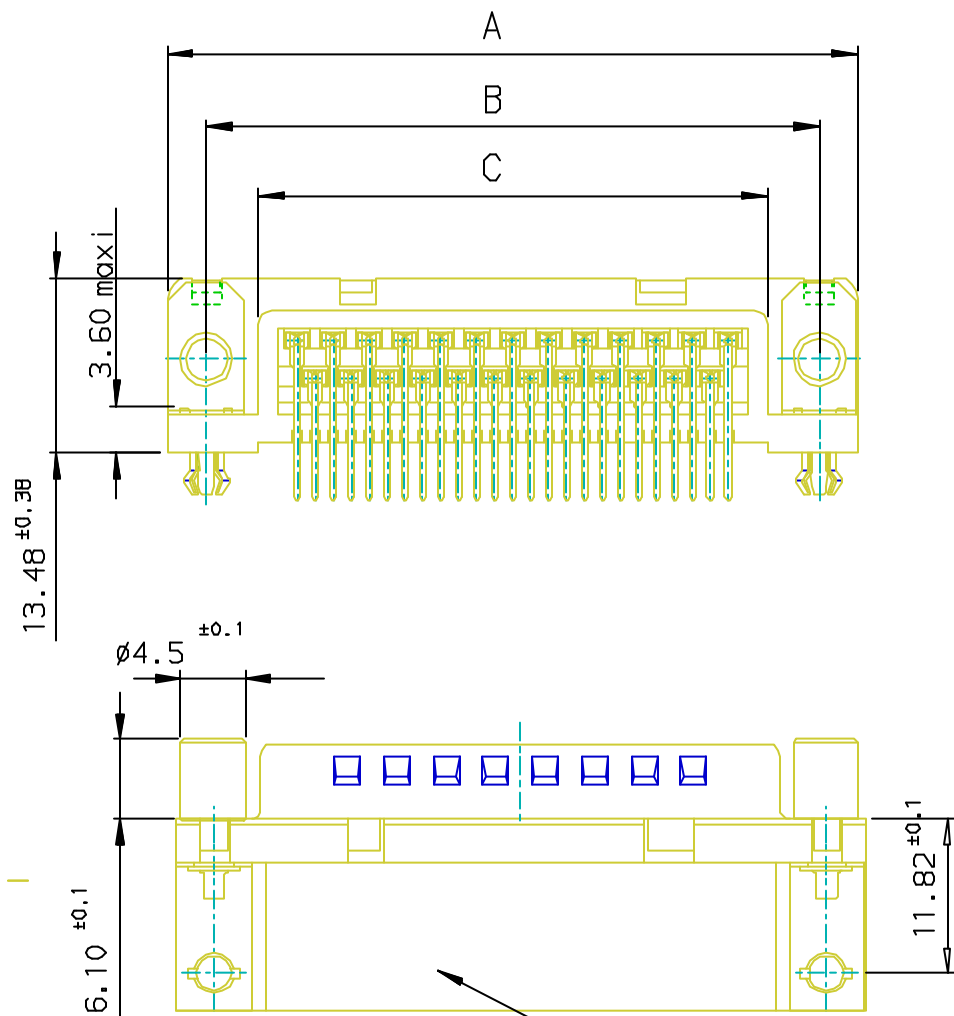
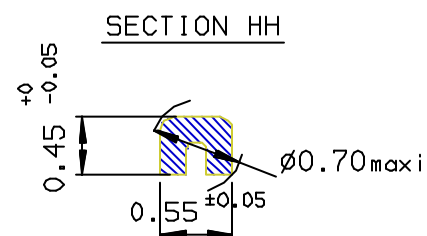
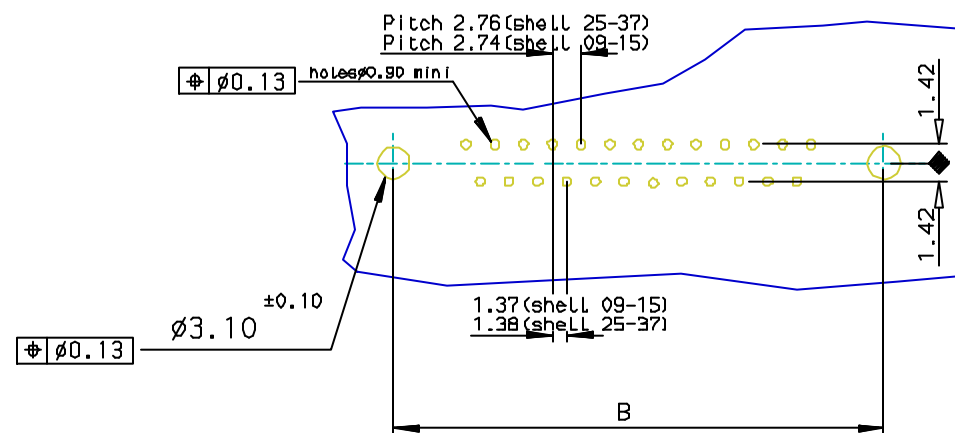

**REQUIREMENTS**

**Technical characteristics:**

- Shell: steel tin/Zinc Cr3 plated
- Insulators: self-extinguishing black polyster, UL class 94V0
- Contacts size 20: brass, gold on mating end, bright tin on termination end over nickel on entire contact
- Cycles :500 for protection 6  
:200 for protection 4

- Harpoons: phosphor bronze, tin plated
- Metal plate for electrical continuity: brass, tin/Zinc Cr3 plated
- Nuts: brass, tin /Zinc Cr3 plated torque: 0.5N/m

**Electrical characteristics:**

- max. current rating: 5A
- Test voltage: 1000V
- Rated voltage: 300V
- Contact resistance: ≤ 15mΩ
- Shell resistance: ≤ 5mΩ
- Insulation resistance: ≥ 5000MΩ

**Climatic characteristics:**

- Operating temperature range: -55°C +125°C

**Dimensions:**

- in accordance with MIL-C-24308

Part Number & Date Code Printing

PART NUMBER							
SHELL	A ± 0.38	B ± 0.12	C ± 0.10	D ± 0.25	G ± 0.25	Plating: 0.76µ AU	Plating: Flash AU
09	30.81	24.99	16.96	16.79	5.90	D09P23B6G*00**	D09P23B4G*00**
15	39.14	33.32	25.18	25.12	5.90	D15P23B6G*00**	D15P23B4G*00**
25	53.03	47.04	39.12	38.84	5.70	D25P23B6G*00**	D25P23B4G*00**
37	69.32	63.50	55.68	55.30	5.70	D37P23B6G*00**	D37P23B4G*00**

FOR ROHS DETAILS REFER DWG.N0:C01-8646-0000

Threaded ØT M3 = I  
Threaded ØT 4.40 = V  
LF FOR LEAD FREE

European Views

rev	ecn no	dr	date
B	105-0124	JS	2005/07/27
C	106-0074	SK	2006/06/08
-	-	-	-
-	-	-	-
-	-	-	-
-	-	-	-

www.fciconnect.com		surface ISO 1302 ✓	tolerance std ISO 406 ISO 1101	projection mm
TOLERANCES UNLESS OTHERWISE SPECIFIED				
Dr	JOHN SLEEBA	1999/05/17	ANGULAR	0.X ±0.1
Eng	GEORGE VJ	1999/05/17	LINEAR	0.XX ±0.1
Chr	GEORGE VJ	2005/07/27	0.XX ±1*	0.XXX ±0.1
Appr	KVSD	2005/07/27	Product family	D-SUB
FCI		title MALE CONNECT.DELTA D WITH FEMALE WITH NUT, HARPOON & METAL PLATE.		size A3
catalog no DELTA-D		dwg no C01-8646-0671		Scale 1:1
		CUSTOMER		Rev. C
		sheet 1 of 1		

REV F - 2006-04-17