

## Relay Sockets

### Features:

- Peel-A-Way® delivery system.
- Complete soldering visibility on both sides of PCB.
- Maximum air flow. Better flux rinse.
- Multiple terminal types available on a single sheet.
- No special assembly equipment required.
- Thru hole design available for board to board applications.
- RTV sealant, tape seal and solder preform options available.

### Terminals and Contacts:

Terminal: Brass - Copper Alloy (C36000)  
ASTM-B-16

Contact: Beryllium Copper - Copper Alloy (C17200), ASTM-B-194

### Plating:

Terminal: Gold over Nickel or  
Tin-Lead over Nickel

Contact: Gold over Nickel or  
Tin-Lead over Nickel

### Body Material:

Polyimide Film - Temp. range -269°C to  
400°C (-452°F to 752°F)

Relay Footprint #RFXXX

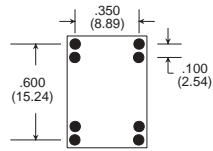

Series 107, 171, 172, 173 & 174  
DIP Reed Relays

Relay Footprint #T75

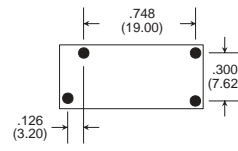

Relay Footprint #T92

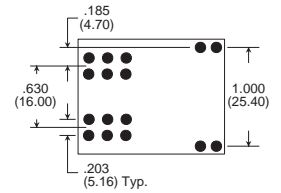

Relay Footprint #T84

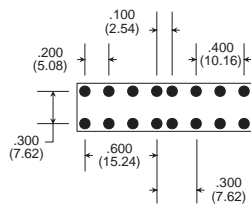

Relay Footprint #  
T85 & T82N

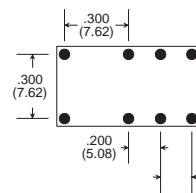

Relay Footprint #T74

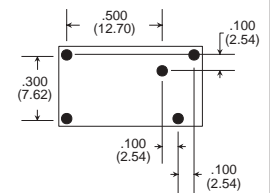

Relay Footprint #T81

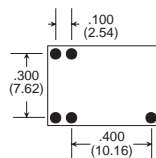

### How To Order

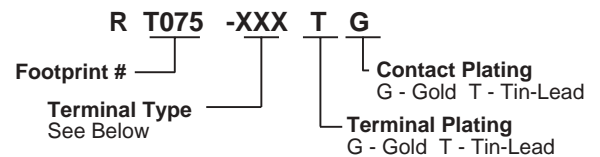

## Terminal Information

Type -301

Accepts .022" - .032" Dia. Leads

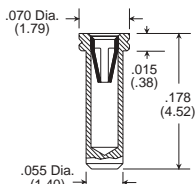

Part #3818 Contact Group D  
Standard Pitch .150" (3.91)

Type -102

Accepts .022" - .032" Dia. Leads

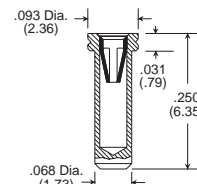

Part #1721 Contact Group D  
Standard Pitch .150" (3.91)

Type -106

Accepts .032" - .047" Dia. Leads

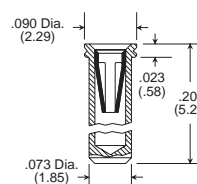

Part #1718 Contact Group E  
Standard Pitch .150" (3.91)

Type -144

Accepts .032" - .047" Dia. Leads

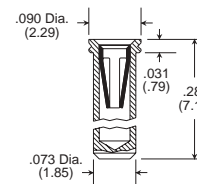

Part #1806 Contact Group E  
Standard Pitch .150" (3.91)

Type -107

Accepts .032" - .047" Dia. Leads

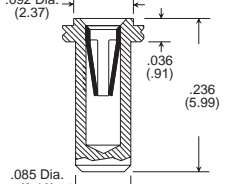

Part #1726 Contact Group E  
Standard Pitch .150" (3.91)

Type -327

Accepts .035" - .045" Dia. Leads

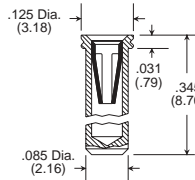

Part #3971 Contact Group E1  
Standard Pitch .150" (3.91)

Type -302

Accepts .040" - .060" Dia. Leads

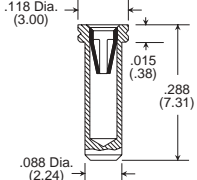

Part #3819 Contact Group E2  
Standard Pitch .150" (3.91)

Type -104

Accepts .065" - .082" Dia. Leads

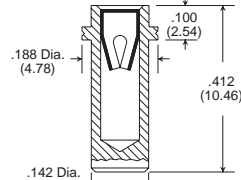

Part #1723 Contact Group F  
Standard Pitch .250" (6.45)

Type -105

Accepts .065" - .082" Dia. Leads

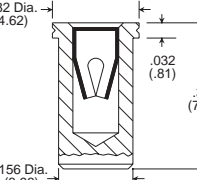

Part #1724 Contact Group F  
Standard Pitch .250" (6.45)

Type -323

Accepts .065" - .082" Leads

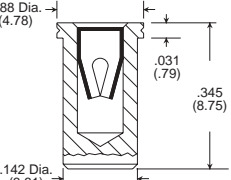

Part #3967 Contact Group F  
Standard Pitch .250" (6.45)