

MATERIALS AND FINISHES:

BODY STEEL PER ASTM-582,
PASSIVATED

CENTER CONTACT BERYLLIUM COPPER
PER ASTM-B196, PLATED GOLD
.000050 INCHES MIN PER MIL-G-45204

INSULATOR TEFLON PER ASTM-D-1457

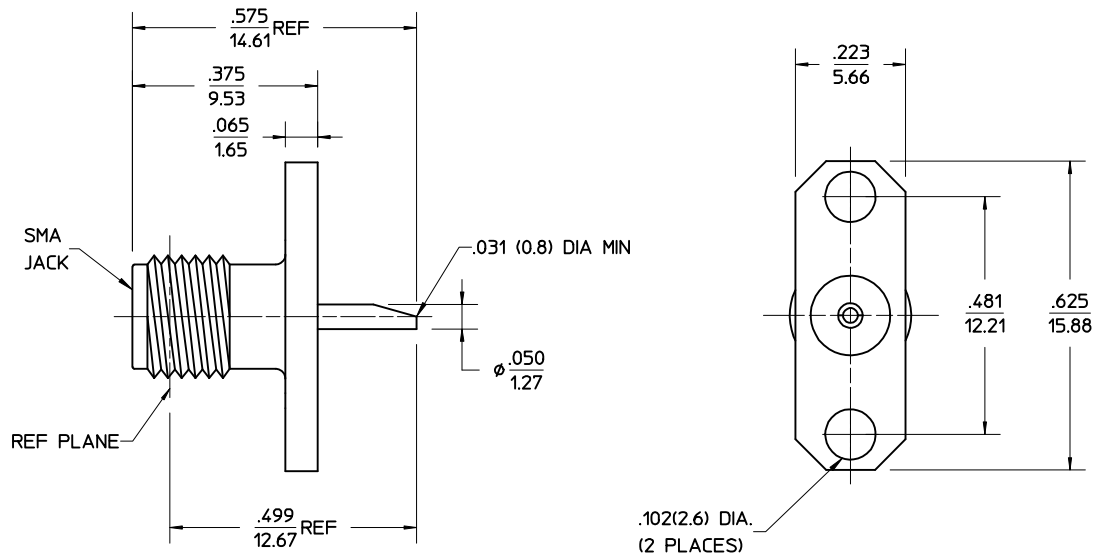

PART # 73251-0250

MIL-STD-348, FIGURE 310-2	INTERFACE
PS-89675-2820	ELECTRO/MECH PERFORMANCE
SPECIFICATION	DESCRIPTION

EC NO. RF-0013	DRWN EDC 12/10/97	CHK: DHG 01/09/98	APPR: GMH 01/09/98
A	REV	DESCRIPTION	

- UNLESS OTHERWISE SPECIFIED DIMS ARE INCHES AND ANGLES ARE DEGREES.
1. $\sqrt{63}$ ALL OVER.
 2. NO CHATTER OR NON-UNIFORM SURFACE FINISH ALLOWED.
 3. PARTS TO BE FREE OF BURRS & SHARP EDGES .005 MAX BREAK.
 4. EXTERNAL THREADS TO BE ROLLED OR SINGLE POINT.
 5. DIAMETERS TO BE CONCENTRIC WITHIN .003 TIR

QUALITY SYMBOLS
MAJOR
CRITICAL

GENERAL TOLERANCES: (UNLESS SPECIFIED)	
4 PLACES	\pm .0005
3 PLACES	\pm .005
2 PLACES	\pm .01
1 PLACE	\pm .1
ANGULAR: \pm 1/2°	
DRAFT WHERE APPLICABLE MUST REMAIN WITHIN DIMENSIONS	

SCALE	DESIGN UNITS
	<input type="checkbox"/> mm <input checked="" type="checkbox"/> INCH
DRAWN BY & DATE	
EDC 12/10/97	
CHECKED BY & DATE	
DHG 01/09/98	
APPROVED BY & DATE	
GMH 01/09/98	
CAD FILENAME	

THIRD ANGLE PROJECTION	TITLE:
	SMA JACK, RECEPTACLE, 2 HOLE FLANGE MOUNT, SOLDER POT
	SMA-SDJR/F
MOLEX INCORPORATED	
MATERIAL NO. SEE NOTE	DRAWING NO. SD-73251-025

1	A
SHT	REV
REVISE ON CAD ONLY	
SHEET NO.	SIZE
1 of 1	B