

DO NOT SCALE FROM THIS PRINT

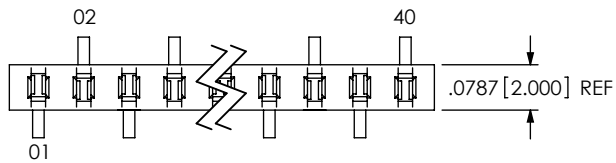

-SV

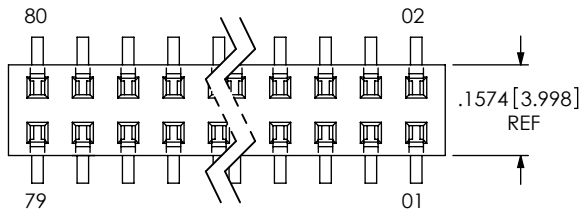

-DV-LC

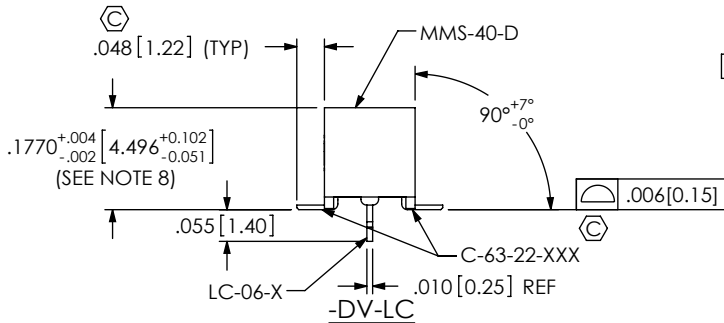
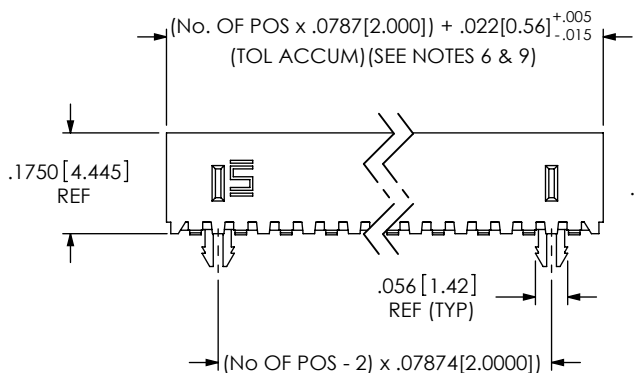

-DV-LC

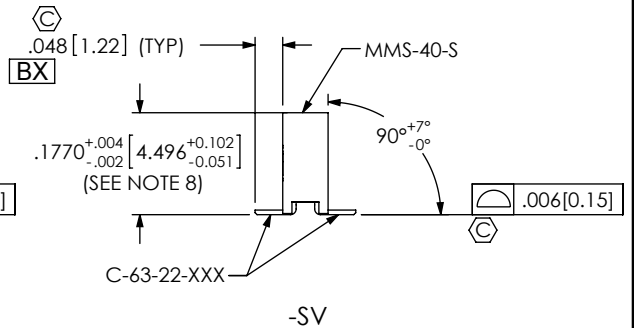

-SV

FIG 1
MMS-140-02-XXX-XV-LC SHOWN

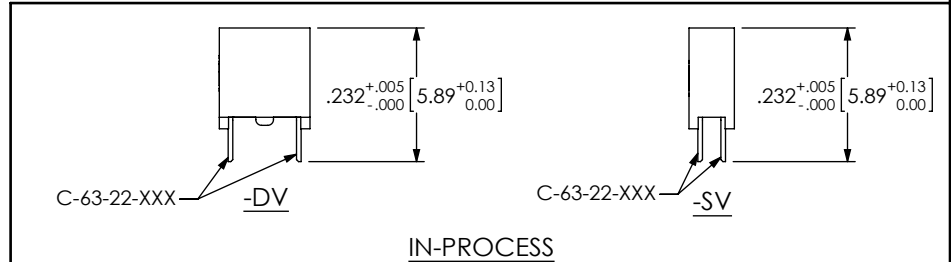

PLATING SPECIFICATION

- S: 30μ" SELECTIVE GOLD IN CONTACT AREA, MATTE TIN TAIL
- L: 10μ" SELECTIVE GOLD IN CONTACT AREA, MATTE TIN TAIL
- F: 3μ" SELECTIVE GOLD IN CONTACT AREA, MATTE TIN TAIL
- T: MATTE TIN OVER ENTIRE CONTACT
- LTL: 10μ" SELECTIVE GOLD IN CONTACT AREA, TIN LEAD (90/10 ±5%) TAIL
- SM: 30μ" SELECTIVE GOLD IN CONTACT AREA, MATTE TIN TAIL
- LM: 10μ" SELECTIVE GOLD IN CONTACT AREA, MATTE TIN TAIL
- FM: 3μ" SELECTIVE GOLD IN CONTACT AREA, MATTE TIN TAIL
- TM: MATTE TIN OVER ENTIRE CONTACT
- H: 30μ" GOLD IN CONTACT AREA, 3μ" GOLD ON TAIL

MMS-1XX-02-XXX-XX-XX-XXX

No OF POSITIONS
-02 THRU -40
(PER ROW)

LEAD STYLE
-02: SURFACE MOUNT

POLARIZING OPTION
-XXX INDICATES POSITION No
(USE PK-07-N)

OPTION

- LC: LOCKING CLIP
(NOT AVAILABLE ON -SV)
(USE LC-06-TM, SEE FIG 1,
FIG 2 & 3, SHT 2 & NOTES 6 & 7)
- P: PICK & PLACE PAD
(ONLY AVAILABLE ON -SV & -DV, 4 POS MIN)
(-SV: USE PPP-09; -DV: USE PPP-03;
SEE FIG 5, SHT 2)
- M: METAL PICK & PLACE PAD
(ONLY AVAILABLE ON -DV)
(USE LMP-03, SEE FIG 7, SHT 3)
- A: MOLDED ALIGNMENT PIN
(AVAILABLE ON -DV ONLY)
(USE MMS-XX-D-XXX, SEE FIG 4, SHT 2)
- K: POLYIMIDE FILM PAD
(AVAILABLE ONLY ON -SV, 3 POS MIN &
-DV, 4 POS MIN)
(USE K-500-300, SEE FIG 6, SHT 3)
- TR: TAPE & REEL PACKAGING
(SEE FIG 8, SHT 3)

ENTRY/ROW SPECIFICATION

- SH: SINGLE ROW, HORIZONTAL ENTRY
- DH: DOUBLE ROW, HORIZONTAL ENTRY
- SV: SINGLE ROW, VERTICAL (TOP) ENTRY
- DV: DOUBLE ROW, VERTICAL (TOP) ENTRY

NOTES:

1. Ⓞ REPRESENTS A CRITICAL DIMENSION.
2. MAXIMUM ALLOWABLE SWAY: 2° IN EITHER DIRECTION
3. MAXIMUM BURR ALLOWANCE: .003 [0.08]
4. MAXIMUM CUT FLASH: .020 [0.51].
5. MINIMUM RETENTION FORCE: SINGLE ROW: .5 LB, DOUBLE ROW: 1 LB
6. CUT BODIES FROM MMS-40-D OR MMS-40-S FOR ALL STYLES EXCEPT -LC. FOR -LC, USE POSITIONALIZED BODIES.
7. DUE TO THE HIGH AMOUNT OF INSERTION FORCE NEEDED, THE -LC OPTION IS NOT COMPATIBLE WITH AUTO PLACEMENT. SAMTEC RECOMMENDS MANUAL PLACEMENT FOR ALL ASSEMBLIES WITH THE -LC OPTION.
8. THIS DIMENSION TO BE MEASURED AT BEND.
9. FOR -SV LEAD STYLE, EVEN POSITION CUTS LOSE 2 POSITIONS PER CUT; ODD POSITION CUTS LOSE 1 POSITION PER CUT.
10. LEAD STYLE -02-SH, POSITIONS 2 THRU 4 TO BE PACKAGED IN BOXES. ALL OTHER ROW SPECIFICATIONS SHOULD BE TUBED ACCORDING TO TABLE 2, REGARDLESS OF POSITION.

UNLESS OTHERWISE SPECIFIED, DIMENSIONS ARE IN INCHES. TOLERANCES ARE:
DECIMALS ANGLES
.XX: ±.01 [.3] 2°
.XXX: ±.005 [.13]
.XXXX: ±.0020 [.051]

PROPRIETARY NOTE
THIS DOCUMENT CONTAINS INFORMATION CONFIDENTIAL AND PROPRIETARY TO SAMTEC, INC. AND SHALL NOT BE REPRODUCED OR TRANSFERRED TO OTHER DOCUMENTS OR DISCLOSED TO OTHERS OR USED FOR ANY PURPOSE OTHER THAN THAT WHICH IT WAS OBTAINED WITHOUT THE EXPRESSED WRITTEN CONSENT OF SAMTEC, INC.

samtec
520 PARK EAST BLVD, NEW ALBANY, IN 47150
PHONE: 812-944-6733 FAX: 812-948-5047
e-Mail: info@SAMTEC.com code 55322

MATERIAL: DO NOT SCALE DRAWING SHEET SCALE: 3:1	DESCRIPTION: 2mm SURFACE MOUNT BOX CONNECTOR STRIP ASM
INSULATOR: VECTRA E130I, COLOR: BLACK CONTACT: PHOS BRONZE	DWG. NO. MMS-1XX-02-XXX-XX-XX-XXX
	BY: BRATCHER 04/01/1994 SHEET 1 OF 4

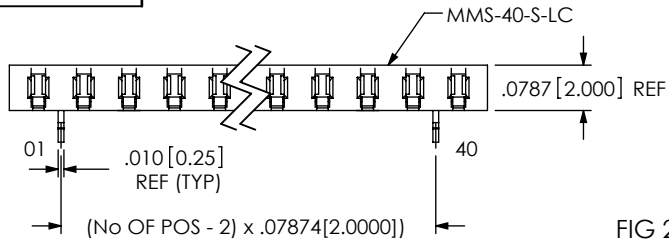

FIG 2
MMS-140-02-XXX-SH-LC SHOWN

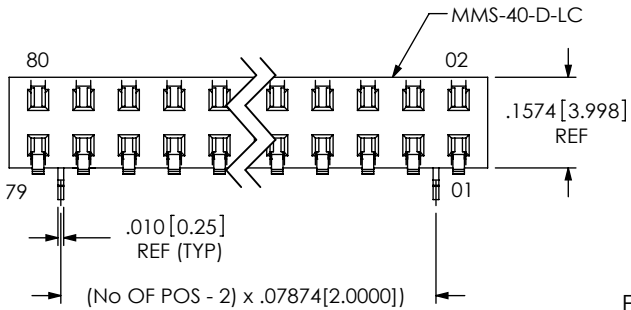
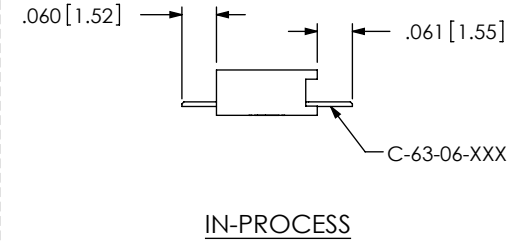
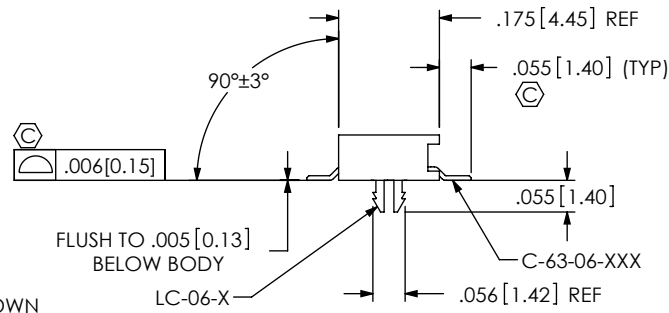
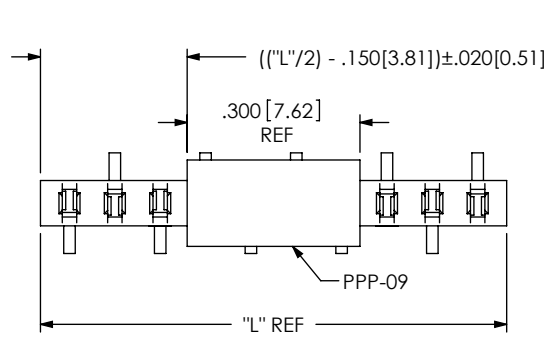
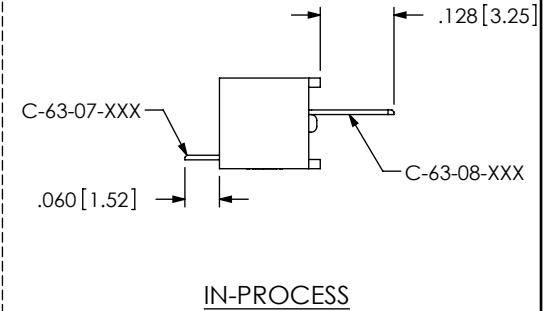
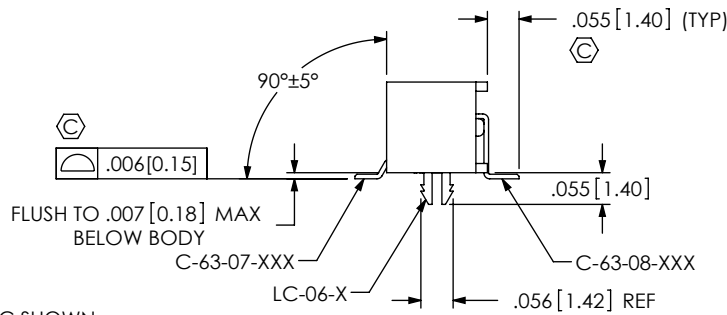
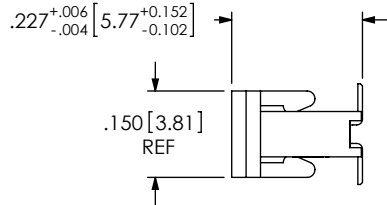

FIG 3
MMS-140-02-XXX-DH-LC SHOWN



"L" = (No OF POSITIONS x .07874 [2.0000]) + .022 [0.56]



-SV-P

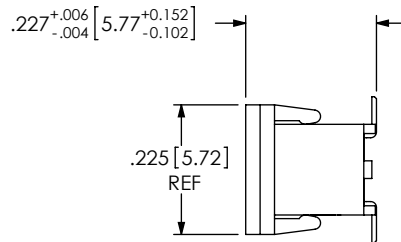
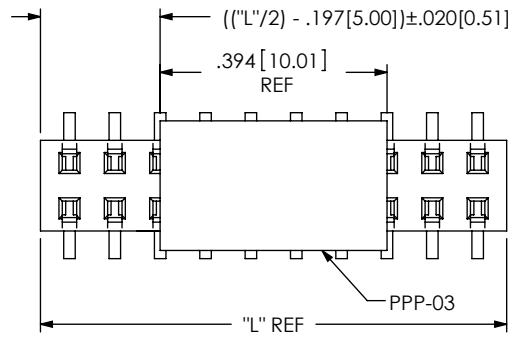

-DV-P

FIG 5
-P: PICK & PLACE PAD
ONLY AVAILABLE ON -SV & -DV
MMS-140-02-XXX-XV-P SHOWN
SAME AS FIG 1, EXCEPT AS SHOWN

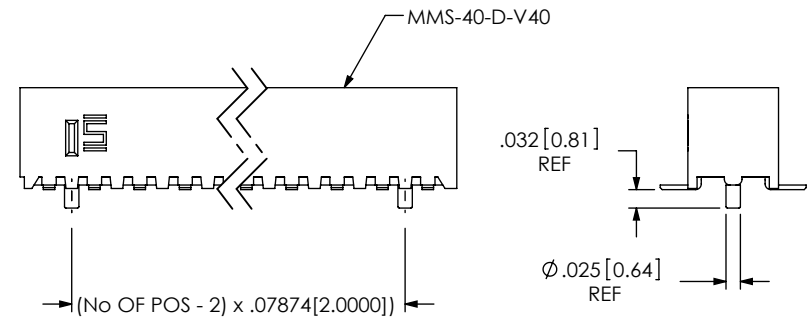

FIG 4
-A: MOLDED ALIGNMENT PIN
ONLY AVAILABLE ON -DV
MMS-140-02-XXX-DV-A SHOWN
SAME AS FIG 1, EXCEPT AS SHOWN

PROPRIETARY NOTE
THIS DOCUMENT CONTAINS INFORMATION
CONFIDENTIAL AND PROPRIETARY TO
SAMTEC, INC. AND SHALL NOT BE REPRODUCED
OR TRANSFERRED TO OTHER DOCUMENTS OR
DISCLOSED TO OTHERS OR USED FOR ANY
PURPOSE OTHER THAN THAT WHICH IT WAS
OBTAINED WITHOUT THE EXPRESSED WRITTEN
CONSENT OF SAMTEC, INC.

DO NOT SCALE DRAWING

SHEET SCALE: 3:1

samtec

520 PARK EAST BLVD, NEW ALBANY, IN 47150
PHONE: 812-944-6733 FAX: 812-948-5047
e-Mail info@SAMTEC.com code 55322

DESCRIPTION:
2mm SURFACE MOUNT BOX CONNECTOR STRIP ASM

DWG. NO.
MMS-1XX-02-XXX-XX-XX-XXX

BY: BRATCHER 04/01/1994 SHEET 2 OF 4

"R" = USED MEASURED DIMENSION
 "S" = ("R" - .118[3.00]) / 2
 *DIM WILL BE .187[4.75] IF POLARIZATION KEY IS UNDER PAD.

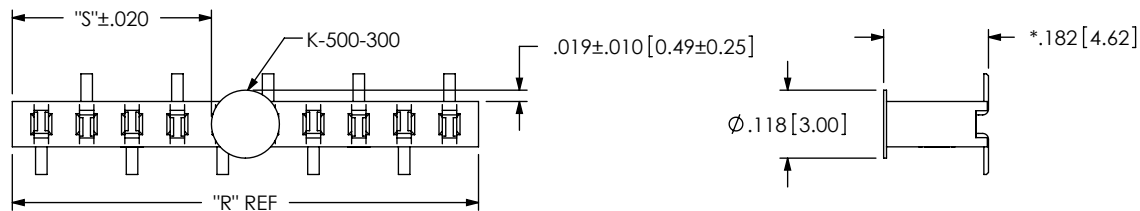

-SV-K

"M" = USED MEASURED DIMENSION
 "P" = ("M" - .2165[5.50]) / 2
 *DIM WILL BE .187[4.75] IF POLARIZATION KEY IS UNDER PAD.

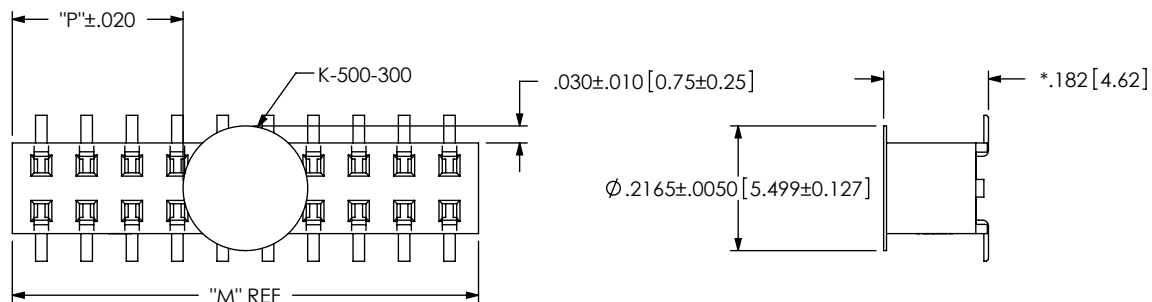

-DV-K

FIG 6
 -K: POLYIMIDE FILM PAD
 ONLY AVAILABLE ON -SV & -DV
 MMS-140-02-XXX-XV-K SHOWN
 SAME AS FIG 1, EXCEPT AS SHOWN

"L" = (No OF POSITIONS x .07874[2.0000]) + .022[0.56]

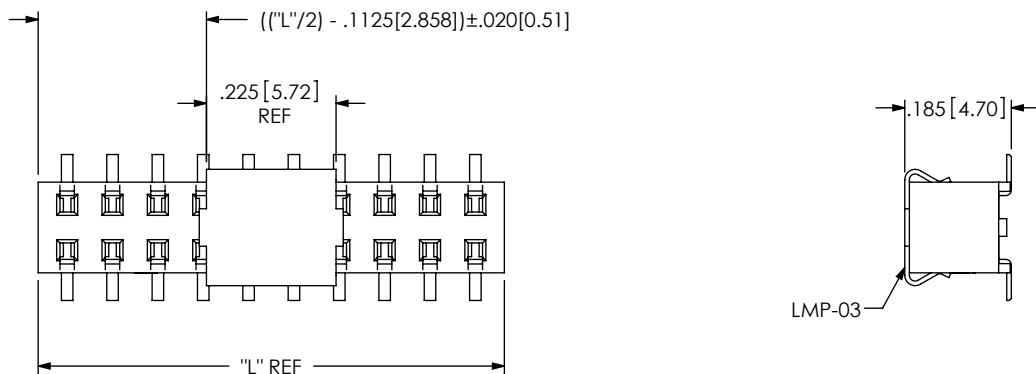

FIG 7
 -M: METAL PICK & PLACE PAD
 ONLY AVAILABLE ON -DV
 MMS-140-02-XXX-DV-M SHOWN
 SAME AS FIG 1, EXCEPT AS SHOWN

PROPRIETARY NOTE
 THIS DOCUMENT CONTAINS INFORMATION
 CONFIDENTIAL AND PROPRIETARY TO
 SAMTEC, INC. AND SHALL NOT BE REPRODUCED
 OR TRANSFERRED TO OTHER DOCUMENTS OR
 DISCLOSED TO OTHERS OR USED FOR ANY
 PURPOSE OTHER THAN THAT WHICH IT WAS
 OBTAINED WITHOUT THE EXPRESSED WRITTEN
 CONSENT OF SAMTEC, INC.

DO NOT SCALE DRAWING

SHEET SCALE: 3:1



520 PARK EAST BLVD, NEW ALBANY, IN 47150
 PHONE: 812-944-6733 FAX: 812-948-5047
 e-Mail info@SAMTEC.com code 55322

DESCRIPTION:
 2mm SURFACE MOUNT BOX CONNECTOR STRIP ASM

DWG. NO.
MMS-1XX-02-XXX-XX-XX-XXX

BY: BRATCHER 04/01/1994 SHEET 3 OF 4

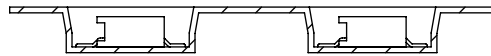
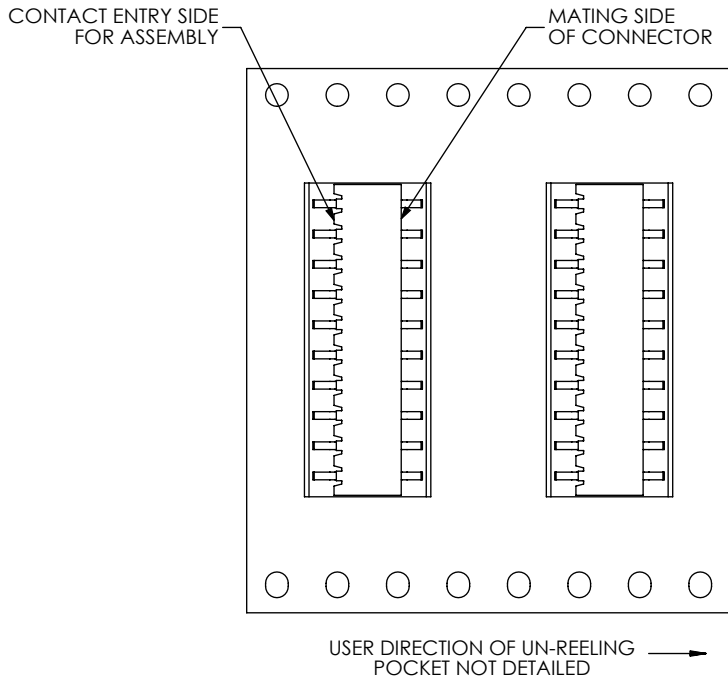
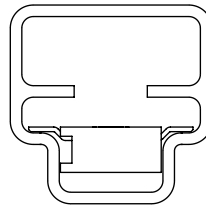
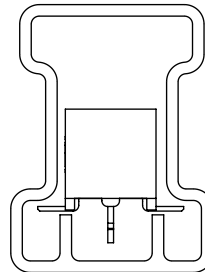

FIG 8
 -TR: TAPE & REEL PACKAGING
 MMS-110-02-XXX-SH SHOWN FOR ORIENTATION OF -SH & -DH STYLES
 (MMS-103-02-X-LC, POS 1 TO FACE ROUND HOLES)

FIG 9
 TUBE PACKAGING OPTIONS



**** -SH, -SH-LC**
**** -SH STYLE SHOWN**



-DV (NOT 4 POS), -DV-LC, -DV-A
-DV-LC STYLE SHOWN

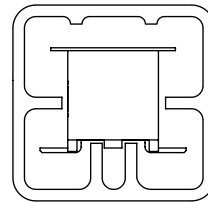

-DV-K, -DV-LC-K, -DV-A-K
-DV-K STYLE SHOWN

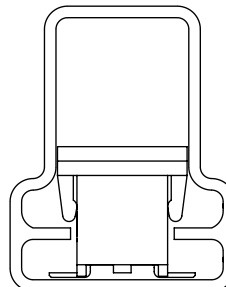

-DV-P, -DV-LC-P, -DV-A-P
-DV-P STYLE SHOWN

TABLE 2 (#1 POSITION TO BE TUBED IN DIRECTION OF ARROW)		
LEAD STYLE	PACKAGING TUBE	PLUG
-DV (NOT 4 POS), -DV-LC, -DV-A	PT-1-24-02-17	TP-09
-DV (4 POS ONLY)	PT-1-24-01-118	TP-09
-DV-M, -DV-LC-M, -DV-A-M	PT-1-24-01-63	TP-24
-DV-K, -DV-LC-K, -DV-A-K	PT-1-24-02-63	TP-24
-DV-P, -DV-LC-P, -DV-A-P	PT-1-24-03-15	TP-03
** -SH, -SH-LC	PT-1-24-02-16	TP-24
-DH	PT-1-24-03-16	TP-03
-DH-P, -DH-K	PT-1-24-06-17	TP-24
-DH-LC	PT-1-24-02-17	TP-09
-SV (NOT -02 THRU -04 POS)	PT-1-24-01-16	TP-12
-SV (-02 THRU -04 POS ONLY)	PT-1-24-01-68	TP-24-02
-SV-P	PT-1-24-02-16	TP-24
-SV-K	PT-1-24-03-63	TP-24

**SEE NOTE 10

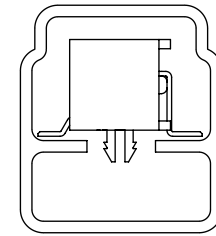

-DH-LC

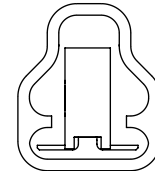

-SV (NOT -02 THRU -04 POS)

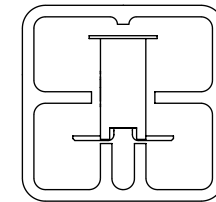

-SV -K

PROPRIETARY NOTE
 THIS DOCUMENT CONTAINS INFORMATION
 CONFIDENTIAL AND PROPRIETARY TO
 SAMTEC, INC. AND SHALL NOT BE REPRODUCED
 OR TRANSFERRED TO OTHER DOCUMENTS OR
 DISCLOSED TO OTHERS OR USED FOR ANY
 PURPOSE OTHER THAN THAT WHICH IT WAS
 OBTAINED WITHOUT THE EXPRESSED WRITTEN
 CONSENT OF SAMTEC, INC.

DO NOT SCALE DRAWING

SHEET SCALE: 3:1

samtec

520 PARK EAST BLVD, NEW ALBANY, IN 47150
 PHONE: 812-944-6733 FAX: 812-948-5047
 e-Mail info@SAMTEC.com code 55322

DESCRIPTION:
 2mm SURFACE MOUNT BOX CONNECTOR STRIP ASM

DWG. NO.
MMS-1XX-02-XXX-XX-XX-XXX

BY: BRATCHER 04/01/1994 SHEET 4 OF 4