

New Jersey Semi-Conductor Products, Inc.

20 STERN AVE.
 SPRINGFIELD, NEW JERSEY 07081
 U.S.A.

TELEPHONE: (973) 376-2922
 (212) 227-6005
 FAX: (973) 376-8960

PARAMETERS

1N5195

SI RECTIFIER, 100mA \langle I(O)/I(F) \leq 200mA

Description: Si Rectifier, 100mA \langle I(O)/I(F) \leq 200mA

Manufacturer	many
Mil/High-Rel? (Y/N)	
I(out) (If AVG) Max	200m
@Temp. (test) (x°C)	
VRRM	200
1-Cycle Surge Current (A)	2.0
Vf Max	1.0
@If (test)10
@Temp. (test) for Vf)	
Ir @25x°C	25n
@Volts (test) (V)	180
Ir @ Diff. Temp (A)	5.0u
@Temp (test) (x°C)	150
Oper. Temp (x°C) Max	200
Pkg Style	DO-35
Surface Mounted (Y/N)	N

Storage Temperature - 2 It(rms)

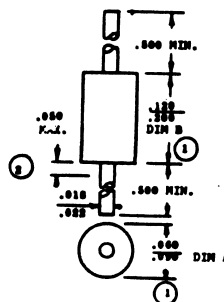

1. PACKAGE CONTOUR OPTIONAL WITHIN DIMENSIONS A & B. SLUGS, IF ANY, SHALL BE INCLUDED WITHIN THIS CYLINDER BUT SHALL NOT BE SUBJECT TO THE DIMENSION LIMIT OF DIM. A.
2. LEAD DIAMETER NOT CONTROLLED IN THIS ZONE TO ALLOW FOR PLAIN, LEAD FINISH BUILD-UP, AND OTHER IRREGULARITIES OTHER THAN SLUGS.

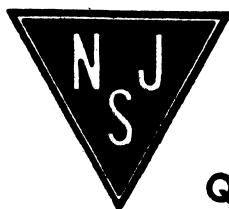

Quality Semi-Conductors