

RECOMMENDED PCB LAYOUT
COMPONENT SIDE

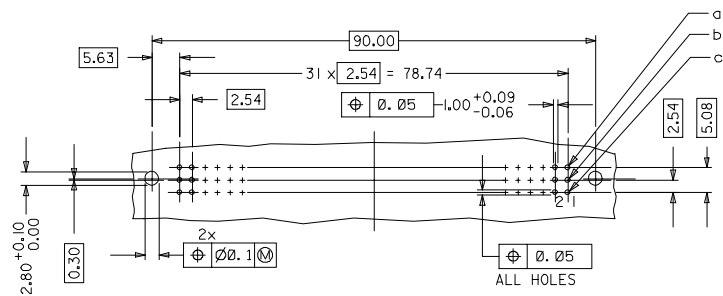

WITH MOUNTING CLIPS

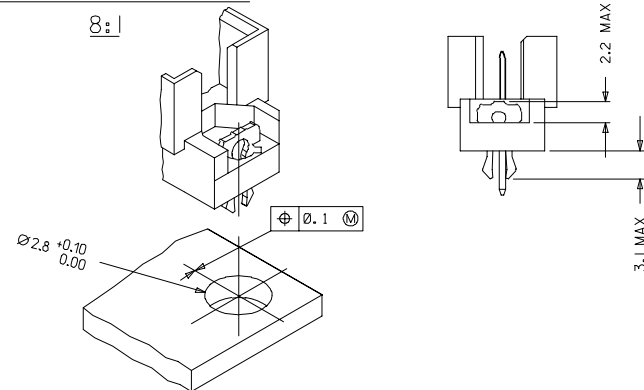

NOTES:

- MATERIALS: THERMOPLASTIC POLYESTER, GLASS FILLED, UL94V-0. COLOUR: PEBBLE GREY RAL 7032
TERMINAL - PHOSPHOR BRONZE
MOUNTING CLIP: STEEL
- FINISH: TERMINAL:-
CONTACT AREA
 - PERFORMANCE LEVEL 1: SELECTIVE GOLD (Au), THICKNESS = 1.1 MICROMETER OVER NICKEL, THICKNESS = 1.25 MICROMETER MIN
 - PERFORMANCE LEVEL 2: SELECTIVE GOLD (Au), THICKNESS = 0.6 MICROMETER OVER NICKEL, THICKNESS = 1.25 MICROMETER MIN
 - PERFORMANCE LEVEL 3: SELECTIVE GOLD (Au), THICKNESS = 0.3 MICROMETER OVER NICKEL, THICKNESS = 1.25 MICROMETER MIN
 PRESS-IN AREA : NICKEL, THICKNESS = 1.25 MICROMETER MIN OVERALL
 WRAP AREA : NICKEL, THICKNESS = 1.25 MICROMETER MIN OVERALL
 ADAPTER INSERTION AREA : PERFORMANCE LEVEL 3; SELECTIVE GOLD (Au), THICKNESS = 0.3 MICROMETER OVER NICKEL, THICKNESS = 1.25 MICROMETER MIN
- MOUNTING CLIP:-
TIN (Sn), THICKNESS = 5-10 MICROMETER,
OVER NICKEL (Ni), THICKNESS = 2.5 MICROMETER
- FOR NON MOUNTING CLIP OPTION, CONNECTOR TO BE SECURED WITH RIVETS: 2 TUBULAR RIVETS 2.5 x 0.3 ... DIN 7340
SCREWS: 2 CHEESEHEAD SCREWS M2.5 x DIN 84 AND 2 HEXAGONAL NUTS M2.5 DIN 934
- MATERIAL NUMBER, BATCH CODE, UL AND CSA MARKING TO BE PRINTED ON THE CONNECTOR
- CUT FACE OF TIP WITHOUT PLATING PERMITTED
- PRODUCT SPECIFICATION PS-36515-001

RoHS COMPLIANT

EC No: P2007-0044 DRWNSATTI/MARAD 2006/10/10 CHK/SS/SUBHR 2006/10/11 APPR/SS/SUBHR 2006/10/15	QUALITY SYMBOLS	GENERAL TOLERANCES (UNLESS SPECIFIED)	DIMENSION STYLE	SCALE	DESIGN UNITS	THIRD ANGLE PROJECTION
	▽=0 ▽=0	mm INCH 4 PLACES ± ± 3 PLACES ± 0.05 ± 2 PLACES ± 0.1 ± 1 PLACE ± 0.15 ± ANGULAR ± 2°	MM ONLY	2:1	METRIC	
C1	DESCRIPTION	DRAWN BY: SS CHECKED BY: G.J.LOWE APPROVED BY: G.J.LOWE DATE: 1999/09/24	DATE: 1999/09/24 DATE: 1999/09/24 DATE: 1999/09/24	TITLE: ASSY, DIN 41612, R MALE 96P, PRESS-IN, WIRE WRAP ADAPTER INSERTION AREA MOLEX INCORPORATED		
	DRAFT WHERE APPLICABLE MUST REMAIN WITHIN DIMENSIONS	MATERIAL NO. SD-36515-005 DOCUMENT NO. SD-36515-005	SHEET NO. 1 OF 2			

MATERIAL No.	MOLEX ENG No.	PERF LEVEL	PLATING	CONTACT SEQUENCE/ROW	DIM "L" MM	MOUNTING CLIP	FMLB
36515-0097	MM-B1466-R960	1	Au + Ni	1,2,3...32 a+b+c	13.25	NO	NO
36515-0098	MM-B1566-R960	2	Au + Ni	1,2,3...32 a+b+c	13.25	NO	NO
36515-0099	MM-B1666-R960	3	Au + Ni	1,2,3...32 a+b+c	13.25	NO	NO
36515-0103	MM-B1466-R910	1	Au + Ni	1,2,3...32 a+b+c	13.25	YES	NO
36515-0104	MM-B1566-R910	2	Au + Ni	1,2,3...32 a+b+c	13.25	YES	NO
36515-0105	MM-B1666-R910	3	Au + Ni	1,2,3...32 a+b+c	13.25	YES	NO
36515-0109	MM-B1466-R930	1	Au + Ni	1,2,3...32 a+b+c	13.25	NO	1,32a 1,32b 1,32c
36515-0110	MM-B1566-R930	2	Au + Ni	1,2,3...32 a+b+c	13.25	NO	1,32a 1,32b 1,32c
36515-0111	MM-B1666-R930	3	Au + Ni	1,2,3...32 a+b+c	13.25	NO	1,32a 1,32b 1,32c
36515-0115	MM-B1466-R950	1	Au + Ni	1,2,3...32 a+b+c	13.25	YES	1,32a 1,32b 1,32c
36515-0116	MM-B1566-R950	2	Au + Ni	1,2,3...32 a+b+c	13.25	YES	1,32a 1,32b 1,32c
36515-0117	MM-B1666-R950	3	Au + Ni	1,2,3...32 a+b+c	13.25	YES	1,32a 1,32b 1,32c

DETAILY DETAILX

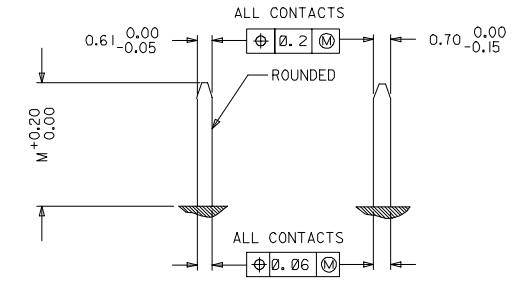

PRE MATING CONTACTS	5.4
NORMAL CONTACTS	4.8
	M

RoHS COMPLIANT

EC No: 2007-0044 DRAWING APPROVED 2006/10/10 CHECKED BY APPRESSOR 2006/10/11 APPROVED BY APPRESSOR 2006/10/15	QUALITY SYMBOLS 	GENERAL TOLERANCES (UNLESS SPECIFIED) <table border="1"> <tr> <th></th> <th>mm</th> <th>INCH</th> </tr> <tr> <td>4 PLACES</td> <td>± 0.15</td> <td>± 0.006</td> </tr> <tr> <td>3 PLACES</td> <td>± 0.05</td> <td>± 0.002</td> </tr> <tr> <td>2 PLACES</td> <td>± 0.1</td> <td>± 0.004</td> </tr> <tr> <td>1 PLACE</td> <td>± 0.15</td> <td>± 0.006</td> </tr> </table>		mm	INCH	4 PLACES	± 0.15	± 0.006	3 PLACES	± 0.05	± 0.002	2 PLACES	± 0.1	± 0.004	1 PLACE	± 0.15	± 0.006	DIMENSION STYLE MM ONLY	SCALE 2:1	DESIGN UNITS METRIC	THIRD ANGLE PROJECTION
		mm	INCH																		
4 PLACES	± 0.15	± 0.006																			
3 PLACES	± 0.05	± 0.002																			
2 PLACES	± 0.1	± 0.004																			
1 PLACE	± 0.15	± 0.006																			
DRAFT WHERE APPLICABLE MUST REMAIN WITHIN DIMENSIONS	DRAWN BY DATE SS 1999/09/24 CHECKED BY DATE GJLOWE 1999/09/24 APPROVED BY DATE GJLOWE 1999/09/24	DIMENSION STYLE SEE CHART	MATERIAL NO. SD-36515-005	SCALE 2:1	TITLE ASSY. DIN 41612, R MALE 96P. PRESS-IN. WIRE WRAP ADAPTER INSERTION AREA	SHEET NO. 2 OF 2															