

# Encapsulated Assemblies ER Series

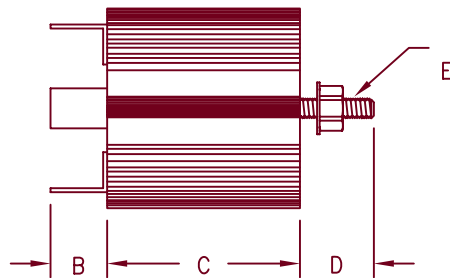
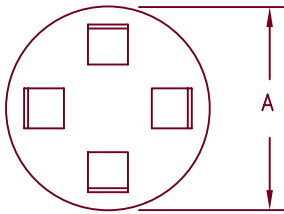

Dimensions			
	Inches	Millimeters	Notes
A	1.31	33.3	
B	0.44	11.1	
C	1.06	26.9	
D	0.47	11.9	
E	---	---	1

Note 1: 1/4"-20 Mounting Stud

Microsemi  
Catalog Number

Max. PRV Rating  
Per Circuit Arm

ER*2B1	200
ER*4B1	400
ER*6B1	600
ER*8B1	800
ER*10B1	1000
ER*12B1	1200
ER*14B1	1400
ER*16B1	1600

\*Add F for Faston Terminal  
\*Add L for Flexible lead (min length-4")

- Encapsulated in rounded case
- Single phase bridge
- PRV rating up to 1600 PRV
- Completely sealed, compact, corrosion and moisture resistant

## Electrical Characteristics

Circuit: Single phase full wave bridge  
 AC Input: Up to 1600 PRV  
 DC Output: Up to 4 Amps DC  
 Surge Current  
 Rating: 250 Amps peak for one cycle  
 Loads: Resistive, Inductive, Capacitive, Continuous  
 Duty Cycle: Continuous  
 Cooling: Convection  
 Design Features: Diodes housed in an epoxy sealed case.  
 Faston terminals or flexible leads.

Single-phase bridge current ratings (resistive-inductive)  
loads derate 20% for capacitive load

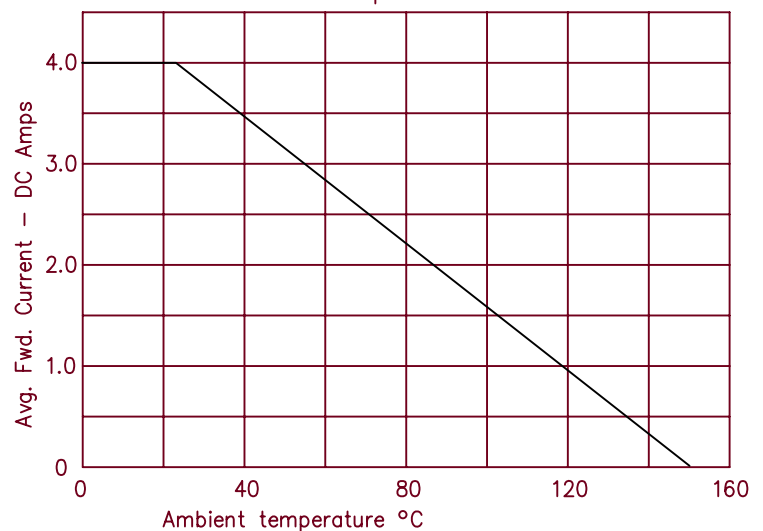

8700 East Thomas Road, P.O. Box 1390  
 Scottsdale, AZ 85252  
 PH: (480) 941-6300  
 FAX: (480) 947-1503  
[www.microsemi.com](http://www.microsemi.com)

04-24-07 Rev. 2