

## RING TERMINALS

### Non-Insulated

- Brazed Seam
- Beveled Wire Lead-In

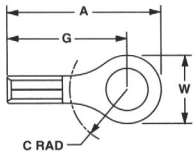

PANDUIT® Part Number	Wire Range	Stud Size	Dimensions (In.)				Std. Pkg. Qty.	Std. Ctn. Qty.	Bulk Pkg. Qty.	Bulk Ctn. Qty.	Crimp Tools
			A	W	C	G					
* P22-2R-C	26-22 .02 Stock	#2	.52	.20	.16	.42	100	1000	1000	10,000	CT-100 CT-200
* P22-4R-C		#4	.52	.20	.16	.42	100	1000	1000	10,000	
* P22-6R-C		#6	.52	.20	.16	.42	100	1000	1000	10,000	
* P22-8R-C		#8	.63	.26	.25	.50	100	1000	1000	10,000	
* P22-10R-C		#10	.63	.31	.22	.47	100	1000	1000	10,000	
<b>P18-4R-C</b>	22-18 .03 Stock	#4	.62	.25	.21	.50	100	1000	1000	10,000	CT-100‡ CT-200‡ CT-600‡ CT-1570‡
<b>P18-6R-C</b>		#6	.60	.22	.19	.49	100	1000	1000	10,000	
<b>P18-6R-C</b>		#6	.62	.25	.21	.50	100	1000	1000	10,000	
<b>P18-8R-C</b>		#8	.71	.31	.25	.55	100	1000	1000	10,000	
<b>P18-10R-C</b>		#10	.71	.31	.25	.55	100	1000	1000	10,000	
<b>P18-14R-C</b>		1/4"	.91	.46	.38	.68	100	1000	1000	10,000	
<b>P18-56R-C</b>	5/16"	.91	.46	.38	.68	100	1000	1000	10,000		
<b>P18-38R-C</b>	3/8"	1.00	.53	.43	.73	100	1000	1000	10,000		
<b>P14-4R-C</b>	16-14 .03 Stock	#4	.62	.25	.20	.50	100	1000	1000	10,000	
<b>P14-6R-C</b>		#6	.62	.25	.20	.50	100	1000	1000	10,000	
<b>P14-8R-C</b>		#8	.71	.31	.25	.55	100	1000	1000	10,000	
<b>P14-10R-C</b>		#10	.71	.31	.25	.55	100	1000	1000	10,000	
<b>P14-14R-C</b>		1/4"	.91	.46	.38	.68	100	1000	1000	10,000	
<b>P14-56R-C</b>		5/16"	.91	.46	.38	.68	100	1000	1000	10,000	
<b>P14-38R-C</b>	3/8"	1.00	.53	.43	.73	100	1000	1000	10,000		
<b>P10-6R-L</b>	12-10 .04 Stock	#6	.78	.31	.31	.62	50	500	500	5000	
<b>P10-8R-L</b>		#8	.78	.31	.31	.62	50	500	500	5000	
<b>P10-10R-L</b>		#10	.81	.38	.31	.62	50	500	500	5000	
<b>P10-14R-L</b>		1/4"	.96	.52	.38	.70	50	500	500	5000	
<b>P10-56R-L</b>		5/16"	.95	.52	.38	.70	50	500	500	5000	
<b>P10-38R-L</b>		3/8"	1.05	.58	.44	.75	50	500	500	5000	
<b>P18-610R-C</b>	22-18 .03" Thick Stock	#6, #8, #10	.80	.31	.25	.55	100	500	1000	10,000	CT-100‡ CT-200‡ CT-600‡ CT-1570‡
<b>P14-610R-C</b>	16-14 .03" Thick Stock	#6, #8, #10	.80	.31	.25	.55	100	500	1000	10,000	
<b>P10-610R-L</b>	12-10 .04" Thick Stock	#6, #8, #10	.90	.37	.31	.62	50	500	500	3000	
<b>P18-6RHT6-C</b>	22-18 .03 Stock	#6	.62	.25	.21	.50	100	1000	1000	10,000	CT-100 CT-160 CT-200 CT-260 CT-600 CT-1570
<b>P18-8RHT6-C</b>		#8	.71	.31	.25	.55	100	1000	1000	10,000	
<b>P18-10RHT6-C</b>		#10	.71	.31	.25	.55	100	1000	1000	10,000	
<b>P14-6RHT6-C</b>	16-14 .03 Stock	#6	.62	.25	.20	.50	100	1000	1000	10,000	
<b>P14-8RHT6-C</b>		#8	.71	.31	.25	.55	100	1000	1000	10,000	
<b>P14-10RHT6-C</b>		#10	.71	.31	.25	.55	100	1000	1000	10,000	
<b>P10-6RHT6-L</b>	12-10 .04 Stock	#6	.78	.31	.35	.62	50	500	500	5000	
<b>P10-8RHT6-L</b>		#8	.78	.31	.35	.62	50	500	500	5000	
<b>P10-10RHT6-L</b>		#10	.81	.38	.33	.62	50	500	500	5000	
<b>P10-14RHT6-L</b>		1/4"	.96	.53	.42	.70	50	500	500	5000	

Order the number of pieces required in multiples of standard package quantities.  
L = 50 pcs., C = 100 pcs., D = 500 pcs. and M = 1000 pcs.  
‡UL and CSA approved tooling/product combinations.  
Prime items appear in **BOLD**.

## MULTIPLE STUD TERMINALS

### Non-Insulated

- Brazed Seam
- Single Terminal for #6, #8, and #10 Size Studs

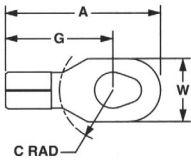

## RING TERMINALS

### Non-Insulated High Temperature

- Nickel Plated Copper
- Brazed Seam
- Beveled Wire Lead-in
- For Temperatures up to 650°F (343°C)

