

DRGH Series — Unshielded DIP Power Inductor

Features

- Designed for high density, small size, and low cost
- Provides low DCR with high DIP stability
- For Inductance values outside those listed in the datasheet contact factory
- Find Environmental information and Packaging specs in related supplemental documents



Applications

- Personal computers
- DC power supplies
- Battery powered equipment
- Power Choke

Inductance and Current ranges

• DRGH654	22 ~ 1000 μ H	0.90 ~ 0.13 A
• DRGH664	22 ~ 1000 μ H	1.27 ~ 0.19 A
• DRGH855	10 ~ 10000 μ H	2.50 ~ 0.08 A
• DRGH875	10 ~ 10000 μ H	2.90 ~ 0.08 A
• DRGH895	10 ~ 47000 μ H	2.60 ~ 0.04 A
• DRGH106	10 ~ 1000 μ H	3.60 ~ 0.36 A
• DRGH108	10 ~ 1000 μ H	4.50 ~ 0.45 A
• DRGH110	10 ~ 1000 μ H	5.30 ~ 0.53 A

How to Order

DRGH		654	K	T	100		
SEI Type		Dimensions	Tolerance	Packaging	Inductance		
Type	Description	Code	Dimensions(mm)	Code	Tolerance	Code	Inductance
DRGH	DIP Power Inductor	654	6.0x5.0	K	$\pm 10\%$	100	10 μ H
		664	6.0x6.5	M	$\pm 20\%$	101	100 μ H
		855	7.8x5.5			102	1000 μ H
		875	7.8x7.5			103	10000 μ H
		895	7.8x9.5				
		106	10.0x6.0				
		108	10.0x8.0				
		110	10.0x10.0				

DRGH Series — Unshielded DIP Power Inductor

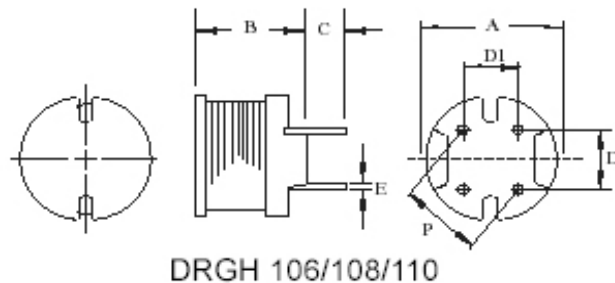
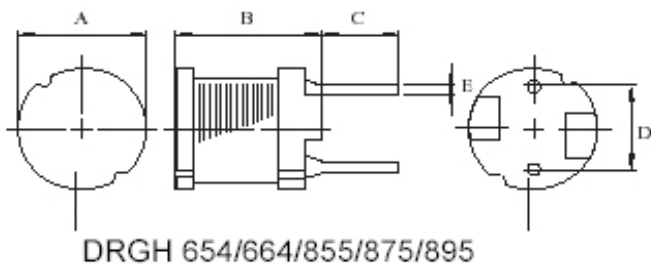

Mechanical Specifications

Type /Code	A	B	C	D	D1	E	P	Units
DRGH654	0.236 ± 0.020 6.0 ± 0.5	0.197 ± 0.020 5.0 ± 0.5	0.150 ± 0.040 4.0 ± 1.0	0.150 ± 0.012 4.0 ± 0.3	-	0.020 ± 0.004 0.5 ± 0.1	-	inches mm
DRGH664	0.236 ± 0.020 6.0 ± 0.5	0.256 ± 0.020 6.5 ± 0.5	0.150 ± 0.040 4.0 ± 1.0	0.150 ± 0.012 4.0 ± 0.3	-	0.020 ± 0.004 0.5 ± 0.1	-	inches mm
DRGH855	0.307 ± 0.020 7.8 ± 0.5	0.217 ± 0.020 5.5 ± 0.5	0.197 ± 0.040 5.0 ± 1.0	0.197 ± 0.012 5.0 ± 0.3	-	0.028 ± 0.004 0.7 ± 0.1	-	inches mm
DRGH875	0.307 ± 0.020 7.8 ± 0.5	0.295 ± 0.020 7.5 ± 0.5	0.197 ± 0.040 5.0 ± 1.0	0.197 ± 0.012 5.0 ± 0.3	-	0.028 ± 0.004 0.7 ± 0.1	-	inches mm
DRGH895	0.307 ± 0.020 7.8 ± 0.5	0.374 ± 0.5 9.5 ± 0.5	0.197 ± 0.040 5.0 ± 1.0	0.197 ± 0.012 5.0 ± 0.3	-	0.028 ± 0.004 0.7 ± 0.1	-	inches mm
DRGH106	0.394 ± 0.020 10.0 ± 0.5	0.236 ± 0.020 6.0 ± 0.5	0.138 ± 0.040 3.5 ± 1.0	0.197 ± 0.012 5.0 ± 0.3	0.150 ± 0.012 4.0 ± 0.3	0.028 ± 0.004 0.7 ± 0.1	0.252 ± 0.020 6.4 ± 0.5	inches mm
DRGH108	0.394 ± 0.020 10.0 ± 0.5	0.315 ± 0.020 8.0 ± 0.5	0.138 ± 0.040 3.5 ± 1.0	0.197 ± 0.012 5.0 ± 0.3	0.150 ± 0.012 4.0 ± 0.3	0.028 ± 0.004 0.7 ± 0.1	0.252 ± 0.020 6.4 ± 0.5	inches mm
DRGH110	0.394 ± 0.020 10.0 ± 0.5	0.394 ± 0.020 10.0 ± 0.5	0.138 ± 0.040 3.5 ± 1.0	0.197 ± 0.012 5.0 ± 0.3	0.150 ± 0.012 4.0 ± 0.3	0.028 ± 0.004 0.7 ± 0.1	0.252 ± 0.020 6.4 ± 0.5	inches mm

Electrical Characteristics - DRGH654

Part Number	L (µH)	Test Freq (KHz)	Tolerance (%)	DCR (Ω) Max	I DC (A) Max
DRGH654MT220	22	100	20	0.18	0.90
DRGH654MT270	27	100	20	0.21	0.81
DRGH654MT330	33	100	20	0.27	0.74
DRGH654MT390	39	100	20	0.29	0.68
DRGH654MT470	47	100	20	0.34	0.62
DRGH654MT560	56	100	20	0.42	0.57
DRGH654MT680	68	100	20	0.48	0.51
DRGH654MT820	82	100	20	0.55	0.47
DRGH654KT101	100	1	10	0.68	0.42
DRGH654KT121	120	1	10	0.77	0.39
DRGH654KT151	150	1	10	0.95	0.35
DRGH654KT181	180	1	10	1.15	0.32
DRGH654KT221	220	1	10	1.30	0.29
DRGH654KT271	270	1	10	1.55	0.26
DRGH654KT331	330	1	10	2.18	0.23
DRGH654KT391	390	1	10	2.47	0.21
DRGH654KT471	470	1	10	2.92	0.20
DRGH654KT561	560	1	10	3.97	0.18
DRGH654KT681	680	1	10	4.57	0.16
DRGH654KT821	820	1	10	5.28	0.15
DRGH654KT102	1000	1	10	7.06	0.13

DRGH Series — Unshielded DIP Power Inductor

Electrical Characteristics - DRGH664

Part Number	L (μ H)	Test Freq (KHz)	Tolerance (%)	DCR (Ω) Max	I DC (A) Max
DRGH664MT220	22	100	20	0.11	1.27
DRGH664MT270	27	100	20	0.14	1.14
DRGH664MT330	33	100	20	0.17	1.03
DRGH664MT390	39	100	20	0.19	0.95
DRGH664MT470	47	100	20	0.23	0.87
DRGH664MT560	56	100	20	0.26	0.80
DRGH664MT680	68	100	20	0.28	0.72
DRGH664MT820	82	100	20	0.39	0.66
DRGH664KT101	100	1	10	0.43	0.59
DRGH664KT121	120	1	10	0.54	0.54
DRGH664KT151	150	1	10	0.64	0.48
DRGH664KT181	180	1	10	0.74	0.44
DRGH664KT221	220	1	10	0.96	0.40
DRGH664KT271	270	1	10	1.12	0.36
DRGH664KT331	330	1	10	1.48	0.33
DRGH664KT391	390	1	10	1.66	0.30
DRGH664KT471	470	1	10	1.91	0.27
DRGH664KT561	560	1	10	2.31	0.25
DRGH664KT681	680	1	10	2.67	0.23
DRGH664KT821	820	1	10	3.10	0.21
DRGH664KT102	1000	1	10	4.45	0.19

Electrical Characteristics - DRGH855

Part Number	L (μ H)	Test Freq (KHz)	Tolerance (%)	DCR (Ω) Max	I DC (A) Max
DRGH855MT100	10	100	20	0.07	2.500
DRGH855MT120	12	100	20	0.08	2.400
DRGH855MT150	15	100	20	0.09	2.100
DRGH855MT180	18	100	20	0.10	2.000
DRGH855MT220	22	100	20	0.12	1.700
DRGH855MT270	27	100	20	0.14	1.600
DRGH855MT330	33	100	20	0.17	1.400
DRGH855MT390	39	100	20	0.21	1.300
DRGH855MT470	47	100	20	0.24	1.200
DRGH855MT560	56	100	20	0.31	1.100
DRGH855MT680	68	100	20	0.34	1.000
DRGH855MT820	82	100	20	0.40	0.930
DRGH855KT101	100	1	10	0.52	0.810
DRGH855KT121	120	1	10	0.59	0.760
DRGH855KT151	150	1	10	0.71	0.670
DRGH855KT181	180	1	10	0.89	0.620
DRGH855KT221	220	1	10	1.04	0.540
DRGH855KT271	270	1	10	1.28	0.490
DRGH855KT331	330	1	10	1.47	0.440
DRGH855KT391	390	1	10	1.67	0.410
DRGH855KT471	470	1	10	1.95	0.380
DRGH855KT561	560	1	10	2.83	0.350
DRGH855KT681	680	1	10	3.25	0.320

DRGH Series — Unshielded DIP Power Inductor

Electrical Characteristics - DRGH855

Part Number	L (μ H)	Test Freq (KHz)	Tolerance (%)	DCR (Ω) Max	I DC (A) Max
DRGH855KT821	820	1	10	3.82	0.310
DRGH855KT102	1000	1	10	5.28	0.250
DRGH855KT122	1200	1	10	6.03	0.230
DRGH855KT152	1500	1	10	7.15	0.210
DRGH855KT182	1800	1	10	8.26	0.200
DRGH855KT222	2200	1	10	11.1	0.180
DRGH855KT272	2700	1	10	13.1	0.160
DRGH855KT332	3300	1	10	15.9	0.140
DRGH855KT392	3900	1	10	18.0	0.130
DRGH855KT472	4700	1	10	23.9	0.120
DRGH855KT562	5600	1	10	26.8	0.110
DRGH855KT682	6800	1	10	31.7	0.098
DRGH855KT822	8200	1	10	46.5	0.088
DRGH855KT103	10000	1	10	55.7	0.081

Electrical Characteristics - DRGH875

Part Number	L (μ H)	Test Freq (KHz)	Tolerance (%)	DCR (Ω) Max	I DC (A) Max
DRGH875MT100	10	100	20	0.05	2.900
DRGH875MT120	12	100	20	0.06	2.500
DRGH875MT150	15	100	20	0.07	2.200
DRGH875MT180	18	100	20	0.08	1.900
DRGH875MT220	22	100	20	0.09	1.800
DRGH875MT270	27	100	20	0.11	1.700
DRGH875MT330	33	100	20	0.13	1.500
DRGH875MT390	39	100	20	0.14	1.300
DRGH875MT470	47	100	20	0.15	1.300
DRGH875MT560	56	100	20	0.18	1.200
DRGH875MT680	68	100	20	0.20	1.100
DRGH875MT820	82	100	20	0.24	1.000
DRGH875KT101	100	1	10	0.28	0.890
DRGH875KT121	120	1	10	0.36	0.810
DRGH875KT151	150	1	10	0.42	0.720
DRGH875KT181	180	1	10	0.57	0.660
DRGH875KT221	220	1	10	0.63	0.570
DRGH875KT271	270	1	10	0.88	0.510
DRGH875KT331	330	1	10	1.05	0.460
DRGH875KT391	390	1	10	1.17	0.440
DRGH875KT471	470	1	10	1.34	0.410
DRGH875KT561	560	1	10	1.72	0.360
DRGH875KT681	680	1	10	1.96	0.330
DRGH875KT821	820	1	10	2.56	0.300
DRGH875KT102	1000	1	10	2.94	0.270
DRGH875KT122	1200	1	10	4.04	0.240
DRGH875KT152	1500	1	10	4.70	0.220
DRGH875KT182	1800	1	10	5.05	0.200
DRGH875KT222	2200	1	10	6.25	0.180
DRGH875KT272	2700	1	10	8.72	0.160

DRGH Series — Unshielded DIP Power Inductor

Electrical Characteristics - DRGH875

Part Number	L (μH)	Test Freq (KHz)	Tolerance (%)	DCR (Ω) Max	I DC (A) Max
DRGH875KT332	3300	1	10	10.6	0.150
DRGH875KT392	3900	1	10	14.2	0.140
DRGH875KT472	4700	1	10	16.7	0.120
DRGH875KT562	5600	1	10	18.7	0.110
DRGH875KT682	6800	1	10	21.8	0.100
DRGH875KT822	8200	1	10	28.7	0.093
DRGH875KT103	10000	1	10	33.0	0.084

Electrical Characteristics - DRGH895

Part Number	L (μH)	Test Freq (KHz)	Tolerance (%)	DCR (Ω) Max	I DC (A) Max
DRGH895MT100	10	100	20	0.04	2.600
DRGH895MT120	12	100	20	0.04	2.600
DRGH895MT150	15	100	20	0.05	2.100
DRGH895MT180	18	100	20	0.05	2.000
DRGH895MT220	22	100	20	0.06	1.700
DRGH895MT270	27	100	20	0.06	1.600
DRGH895MT330	33	100	20	0.07	1.400
DRGH895MT390	39	100	20	0.08	1.400
DRGH895MT470	47	100	20	0.10	1.300
DRGH895MT560	56	100	20	0.11	1.200
DRGH895MT680	68	100	20	0.14	1.100
DRGH895MT820	82	100	20	0.16	1.000
DRGH895KT101	100	1	10	0.19	0.900
DRGH895KT121	120	1	10	0.22	0.820
DRGH895KT151	150	1	10	0.27	0.740
DRGH895KT181	180	1	10	0.31	0.710
DRGH895KT221	220	1	10	0.38	0.640
DRGH895KT271	270	1	10	0.53	0.570
DRGH895KT331	330	1	10	0.61	0.510
DRGH895KT391	390	1	10	0.69	0.480
DRGH895KT471	470	1	10	0.89	0.430
DRGH895KT561	560	1	10	1.01	0.400
DRGH895KT681	680	1	10	1.18	0.350
DRGH895KT821	820	1	10	1.57	0.320
DRGH895KT102	1000	1	10	1.84	0.300
DRGH895KT122	1200	1	10	2.10	0.270
DRGH895KT152	1500	1	10	2.80	0.230
DRGH895KT182	1800	1	10	3.21	0.210
DRGH895KT222	2200	1	10	4.21	0.190
DRGH895KT272	2700	1	10	4.94	0.170
DRGH895KT332	3300	1	10	6.16	0.150
DRGH895KT392	3900	1	10	6.84	0.140
DRGH895KT472	4700	1	10	7.89	0.130
DRGH895KT562	5600	1	10	11.50	0.120
DRGH895KT682	6800	1	10	13.20	0.110
DRGH895KT822	8200	1	10	15.20	0.100
DRGH895KT103	10000	1	10	22.00	0.089
DRGH895KT123	12000	1	10	25.00	0.073

DRGH Series — Unshielded DIP Power Inductor

Electrical Characteristics - DRGH895

Part Number	L (µH)	Test Freq (KHz)	Tolerance (%)	DCR (Ω) Max	I DC (A) Max
DRGH895KT153	15000	1	10	29.10	0.068
DRGH895KT183	18000	1	10	38.90	0.066
DRGH895KT223	22000	1	10	44.90	0.059
DRGH895KT273	27000	1	10	55.70	0.052
DRGH895KT333	33000	1	10	64.20	0.048
DRGH895KT393	39000	1	10	74.20	0.042
DRGH895KT473	47000	1	10	96.40	0.038

Electrical Characteristics - DRGH106

Part Number	L (µH)	Test Freq (KHz)	Tolerance (%)	DCR (Ω) Max	I DC (A) Max
DRGH106MT100	10	100	20	0.040	3.60
DRGH106MT120	12	100	20	0.044	3.30
DRGH106MT150	15	100	20	0.058	2.90
DRGH106MT180	18	100	20	0.064	2.70
DRGH106MT220	22	100	20	0.088	2.40
DRGH106MT270	27	100	20	0.100	2.20
DRGH106MT330	33	100	20	0.110	2.00
DRGH106MT390	39	100	20	0.140	1.80
DRGH106MT470	47	100	20	0.160	1.70
DRGH106MT560	56	100	20	0.190	1.50
DRGH106MT680	68	100	20	0.220	1.40
DRGH106MT820	82	100	20	0.290	1.30
DRGH106KT101	100	1	10	0.320	1.30
DRGH106KT121	120	1	10	0.380	1.20
DRGH106KT151	150	1	10	0.500	1.00
DRGH106KT181	180	1	10	0.560	0.84
DRGH106KT221	220	1	10	0.780	0.76
DRGH106KT271	270	1	10	0.920	0.69
DRGH106KT331	330	1	10	1.100	0.62
DRGH106KT391	390	1	10	1.300	0.57
DRGH106KT471	470	1	10	1.500	0.52
DRGH106KT561	560	1	10	1.900	0.48
DRGH106KT681	680	1	10	2.200	0.43
DRGH106KT821	820	1	10	2.600	0.40
DRGH106KT102	1000	1	10	3.200	0.36

Electrical Characteristics - DRGH108

Part Number	L (µH)	Test Freq (KHz)	Tolerance (%)	DCR (Ω) Max	I DC (A) Max
DRGH108MT100	10	100	20	0.027	4.50
DRGH108MT120	12	100	20	0.031	4.10
DRGH108MT150	15	100	20	0.036	3.70
DRGH108MT180	18	100	20	0.049	3.40
DRGH108MT220	22	100	20	0.055	3.10
DRGH108MT270	27	100	20	0.062	2.80
DRGH108MT330	33	100	20	0.078	2.50
DRGH108MT390	39	100	20	0.087	2.30
DRGH108MT470	47	100	20	0.099	2.10

DRGH Series — Unshielded DIP Power Inductor

Electrical Characteristics - DRGH108

Part Number	L (µH)	Test Freq (KHz)	Tolerance (%)	DCR (Ω) Max	I DC (A) Max
DRGH108MT560	56	100	20	0.130	1.90
DRGH108MT680	68	100	20	0.140	1.70
DRGH108MT820	82	100	20	0.160	1.60
DRGH108KT101	100	1	10	0.210	1.40
DRGH108KT121	120	1	10	0.240	1.30
DRGH108KT151	150	1	10	0.320	1.20
DRGH108KT181	180	1	10	0.350	1.10
DRGH108KT221	220	1	10	0.450	0.96
DRGH108KT271	270	1	10	0.610	0.87
DRGH108KT331	330	1	10	0.690	0.79
DRGH108KT391	390	1	10	0.780	0.72
DRGH108KT471	470	1	10	1.000	0.66
DRGH108KT561	560	1	10	1.200	0.60
DRGH108KT681	680	1	10	1.400	0.55
DRGH108KT821	820	1	10	1.800	0.50
DRGH108KT102	1000	1	10	2.100	0.45

Electrical Characteristics - DRGH110

Part Number	L (µH)	Test Freq (KHz)	Tolerance (%)	DCR (Ω) Max	I DC (A) Max
DRGH110MT100	10	100	20	0.022	5.30
DRGH110MT120	12	100	20	0.023	4.90
DRGH110MT150	15	100	20	0.026	4.40
DRGH110MT180	18	100	20	0.033	4.00
DRGH110MT220	22	100	20	0.037	3.60
DRGH110MT270	27	100	20	0.048	3.30
DRGH110MT330	33	100	20	0.055	2.90
DRGH110MT390	39	100	20	0.073	2.70
DRGH110MT470	47	100	20	0.083	2.50
DRGH110MT560	56	100	20	0.092	2.30
DRGH110MT680	68	100	20	0.120	2.10
DRGH110MT820	82	100	20	0.140	1.90
DRGH110KT101	100	1	10	0.160	1.70
DRGH110KT121	120	1	10	0.200	1.50
DRGH110KT151	150	1	10	0.230	1.40
DRGH110KT181	180	1	10	0.310	1.30
DRGH110KT221	220	1	10	0.340	1.10
DRGH110KT271	270	1	10	0.400	1.00
DRGH110KT331	330	1	10	0.520	0.93
DRGH110KT391	390	1	10	0.650	0.86
DRGH110KT471	470	1	10	0.710	0.78
DRGH110KT561	560	1	10	1.000	0.71
DRGH110KT681	680	1	10	1.100	0.65
DRGH110KT821	820	1	10	1.300	0.59
DRGH110KT102	1000	1	10	1.700	0.53