

**SPECIFICATIONS**

**Mechanical**

**Contact Retention Force:** 1.0Kg min.

**Electrical**

**Current Rating:** 1A

**Contact Resistance:** 20mΩ max.

**Dielectrical Withstanding Voltage:** 1000V

**Insulation Resistance:** 10000MΩ min.

**Physical**

**Housing:** PBT, UL 94-0, Gray White

**Contact:** Brass

**Plating:** See "ORDERING INFORMATION"

**DIN41612 CONNECTOR**

**RZ Series,  
Fixed board, style R  
Header, Press Fit Type  
2.54mm Pitch  
3 Rows**

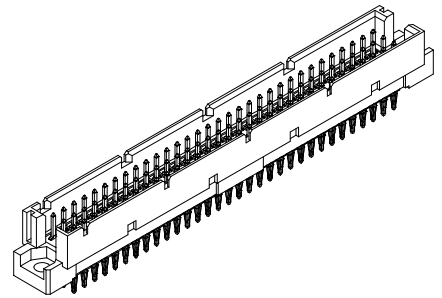

**DRAWING**

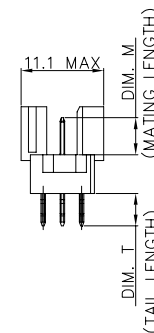
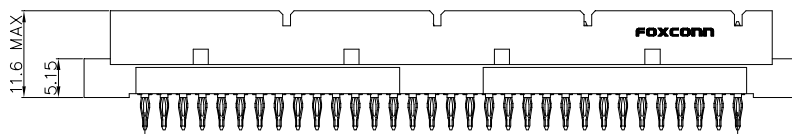
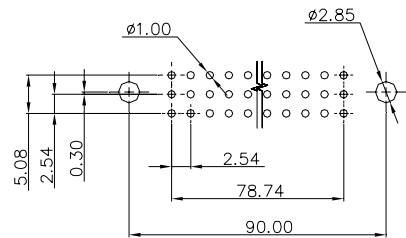
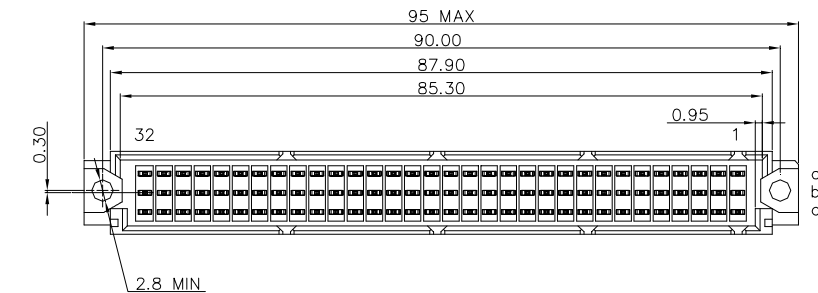

**ORDERING INFORMATION**

**PRODUCT NO.:** RZ 1 3 0 9 6 \* - P R 8 2 1 - \* \*

**POS. NO.:** \_\_\_\_\_  
096=096 pos.

**Mating Area Plating:** \_\_\_\_\_  
3=0.76um(30u")Min. gold plating  
C=0.76um(30u")Min. FPT plating,  
gold flash included  
K=0.38um(15u")Min. FPT plating,  
gold flash included

**Tail Style:** \_\_\_\_\_  
P=Press Fit

**Lead Free Code:**  
N=None  
F=Lead Free

**Package Type:**  
A=Tube  
4=Tray

**Mating length(Dim M):**  
2=4.9mm

**Tail length(Dim T):**  
8=4.3mm