

SCP02Y,Z

BOX MOUNT RECEPTACLE

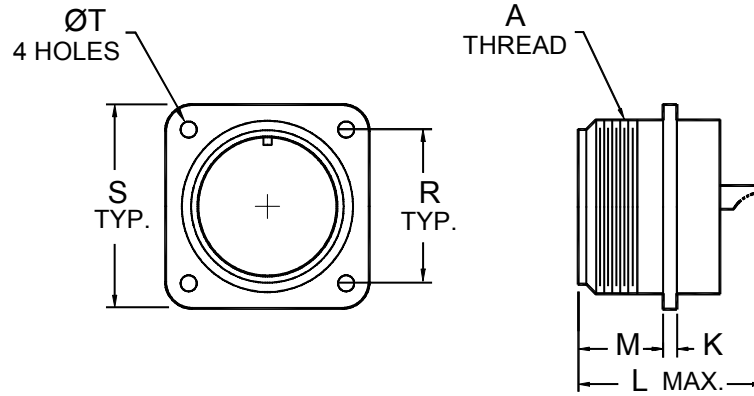

| SHELL SIZE | A COUPLING THREAD CLASS 2A | K | | L MAX. | M +.031 -.000 [+0.79] [-0.00] | R ±.005 [±0.13] | S ±.031 [±0.79] | T +.010 -.005 [+0.25] [-0.13] |
|------------|----------------------------------|----------------|----------------|------------------|---|-----------------------|-----------------------|---|
| | | MAX. | MIN. | | | | | |
| 8S | 1/2-28 UNEF | .156 [3.96] | .062 [1.57] | 1.219 [30.96] | .562 [14.27] | .594 [15.09] | .875 [22.22] | .120 [3.05] |
| 10S | 5/8-24 UNEF | .156 [3.96] | .062 [1.57] | 1.219 [30.96] | .562 [14.27] | .719 [18.26] | 1.000 [25.40] | .120 [3.05] |
| 10SL | 5/8-24 UNEF | .156 [3.96] | .062 [1.57] | 1.219 [30.96] | .562 [14.27] | .719 [18.26] | 1.000 [25.40] | .120 [3.05] |
| 12 | 3/4-20 UNEF | .156 [3.96] | .062 [1.57] | 1.625 [41.28] | .750 [19.05] | .812 [20.62] | 1.094 [27.79] | .120 [3.05] |
| 12S | 3/4-20 UNEF | .156 [3.96] | .062 [1.57] | 1.219 [30.96] | .562 [14.27] | .812 [20.62] | 1.094 [27.79] | .120 [3.05] |
| 14 | 7/8-20 UNEF | .156 [3.96] | .062 [1.57] | 1.625 [41.28] | .750 [19.05] | .906 [23.01] | 1.188 [30.18] | .120 [3.05] |
| 14S | 7/8-20 UNEF | .156 [3.96] | .062 [1.57] | 1.219 [30.96] | .562 [14.27] | .906 [23.01] | 1.188 [30.18] | .120 [3.05] |
| 16 | 1-20 UNEF | .156 [3.96] | .062 [1.57] | 1.625 [41.28] | .750 [19.05] | .969 [24.61] | 1.281 [32.54] | .120 [3.05] |
| 16S | 1-20 UNEF | .156 [3.96] | .062 [1.57] | 1.219 [30.96] | .562 [14.27] | .969 [24.61] | 1.281 [32.54] | .120 [3.05] |
| 18 | 1 1/8-18 UNEF | .203 [5.16] | .094 [2.39] | 1.938 [49.23] | .750 [19.05] | 1.062 [26.97] | 1.375 [34.92] | .120 [3.05] |
| 20 | 1 1/4-18 UNEF | .203 [5.16] | .094 [2.39] | 1.938 [49.23] | .750 [19.05] | 1.156 [29.36] | 1.500 [38.10] | .120 [3.05] |
| 22 | 1 3/8-18 UNEF | .203 [5.16] | .094 [2.39] | 1.938 [49.23] | .750 [19.05] | 1.250 [31.75] | 1.625 [41.27] | .120 [3.05] |
| 24 | 1 1/2-18 UNEF | .203 [5.16] | .094 [2.39] | 1.938 [49.23] | .812 [20.62] | 1.375 [34.92] | 1.750 [44.45] | .147 [3.73] |
| 28 | 1 3/4-18 UNS | .203 [5.16] | .094 [2.39] | 1.938 [49.23] | .812 [20.62] | 1.562 [39.67] | 2.000 [50.80] | .147 [3.73] |
| 32 | 2-18 UNS | .359 [9.12] | .125 [3.17] | 1.938 [49.23] | .875 [22.22] | 1.750 [44.45] | 2.250 [57.15] | .173 [4.39] |
| 36 | 2 1/4-16 UN | .359 [9.12] | .125 [3.17] | 1.938 [49.23] | .875 [22.22] | 1.983 [50.37] | 2.500 [63.50] | .173 [4.39] |
| 40 | 2 1/2-16 UN | .359 [9.12] | .125 [3.17] | 1.938 [49.23] | .875 [22.22] | 2.188 [55.58] | 2.750 [69.85] | .173 [4.39] |

DIMENSIONS IN BRACKETS [] ARE IN MILLIMETERS.

1B010

MIL-DTL-5015 SERIES I SOLDER OR CRIMP (F80) CONTACTS