

**PLEASE CHECK WWW.MOLEX.COM FOR LATEST PART INFORMATION**

**Part Number:** **0334820803**  
**Status:** **Active**  
**Overview:** mx150 sealed connector system  
**Description:** 3.50mm (.138") Pitch MX150™ Sealed Male Connector, Dual Row, 8 Circuits, Polarization C, without Connector Position Assurance, Gray

**Documents:**

[3D Model](#)  
[Application Specification \(PDF\)](#)  
[Drawing \(PDF\)](#)  
[Product Specification PS-33472-000 \(PDF\)](#)  
[RoHS Certificate of Compliance \(PDF\)](#)

**General**

Product Family	Crimp Housings
Series	<u>33482</u>
Comments	No Connector Position Assurance (CPA)
More Detailed Tech Information	<a href="http://ewcap.uscarteams.org">http://ewcap.uscarteams.org</a>
Overview	<u>mx150 sealed connector system</u>
Product Name	MX150™

**Physical**

Circuits (maximum)	8
Circuits Detail	8
Color - Resin	Black, Brown, Natural
Gender	Male
Glow-Wire Compliant	No
Keying to Mating Part	Yes
Lock to Mating Part	Yes
Material - Resin	Modified Polystyrene Alloy
Number of Rows	2
Packaging Type	Bag
Panel Mount	No
Pitch - Mating Interface (in)	0.138 In
Pitch - Mating Interface (mm)	3.50 mm
Polarized to Mating Part	Yes
Stackable	No
Temperature Range - Operating	-40°C to +125°C

**Electrical**

Current - Maximum per Contact	22A
-------------------------------	-----

**Material Info**

**Reference - Drawing Numbers**

Application Specification	AS-33472-100
Packaging Specification	PK-31300-635
Product Specification	PS-33472-000
Sales Drawing	SD-33482-081



**EU RoHS**

**ELV and RoHS Compliant**  
**REACH SVHC Not Reviewed**  
**Halogen-Free Status Not Reviewed**

**China RoHS**



**Need more information on product environmental compliance?**

Email [productcompliance@molex.com](mailto:productcompliance@molex.com)  
 For a multiple part number RoHS Certificate of Compliance, [click here](#)

Please visit the [Contact Us](#) section for any non-product compliance questions.

**Search Parts in this Series**

33482Series

**Mates With**

33472 Female Dual Row Sealed Connector

**Use With**

33000 MX150™ Tin (Sn) Male Terminal,  
33011 Gold (Au) Male Terminal

ASSEMBLY PART NUMBER	COLOR	KEYING OPTION	DIMENSIONS		CAVITY TYPE & STATUS (X = PLUGGED)															
			A	B	1	2	3	4	5	6	7	8								
33482-0801	BLACK	A	60	60																
33482-0802	LT.GRAY	B	25	60																
33482-0803	BROWN	C	60	25																
33482-0804	GREEN	D	25	25																
33482-0805	CUSTOM	TBD																		
33482-0806	BLACK	A	60	60									X							
33482-0807	LT.GRAY	B	25	60								X								
33482-0808	BROWN	C	60	25								X								
33482-0809	GREEN	D	25	25								X								
33482-0810	CUSTOM	TBD										X								
33482-0811	BLACK	A	60	60								X	X							
33482-0812	LT.GRAY	B	25	60								X	X							
33482-0813	BROWN	C	60	25								X	X							
33482-0814	GREEN	D	25	25								X	X							
33482-0815	CUSTOM	TBD										X	X							
33482-0816	BLACK	A	60	60	X							X	X							
33482-0817	LT.GRAY	B	25	60	X							X	X							
33482-0818	BROWN	C	60	25	X							X	X							
33482-0819	GREEN	D	25	25	X							X	X							
33482-0820	CUSTOM	TBD										X	X							
33482-0821	BLACK	A	60	60	X							X	X							X
33482-0822	LT.GRAY	B	25	60	X							X	X							X
33482-0823	BROWN	C	60	25	X							X	X							X
33482-0824	GREEN	D	25	25	X							X	X							X
33482-0825	CUSTOM	TBD										X	X							X
33482-0826	BLACK	A	60	60	X	X	X					X	X	X						X
33482-0827	BLACK	A	60	60								X	X							X
33482-0828	BLACK	A	60	60				X				X	X							X
33482-0829	BLACK	A	60	60			X	X	X	X	X	X	X							X
33482-0830	BLACK	A	60	60								X	X							X
33482-0831	BLACK	A	60	60				X				X	X							X
33482-0832	BLACK	A	60	60								X	X							X
33482-0833	BLACK	A	60	60	X			X	X	X	X	X	X							X
33482-0834	BLACK	A	60	60	X	X	X	X	X	X	X	X	X							X
33482-0835	BLACK	A	60	60								X	X							X
33482-0836	BLACK	A	60	60			X	X				X	X							X
33482-0837	BLACK	A	60	60	X						X	X								X
33482-0838	BLACK	A	60	60			X	X				X	X	X						X

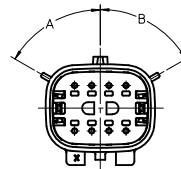

KEYING OPTION  
SEE TABLE SCALE 2:1

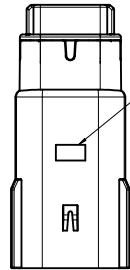

OPTIONAL TRACEABILITY  
INFORMATION LOCATED IN  
THIS AREA

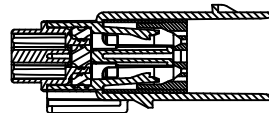

SECTION B-B  
(BLADE SHOWN IN FULL-LOCK POSITION)  
SEE NOTE 2

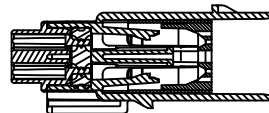

SECTION C-C  
(BLADE SHOWN IN PRE-LOCK POSITION)  
SEE NOTE 2

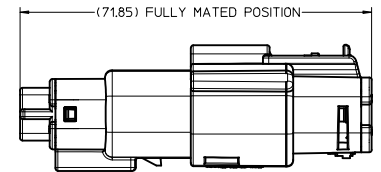

(71.85) FULLY MATED POSITION



SCALE 1:1

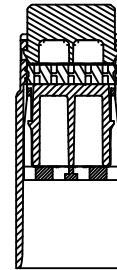

SECTION A-A

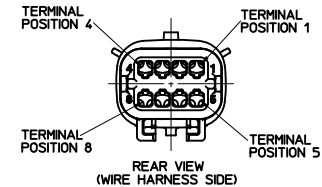

REAR VIEW  
(WIRE HARNESS SIDE)

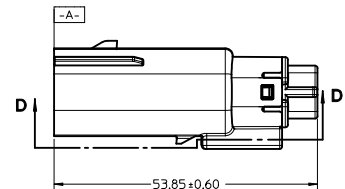
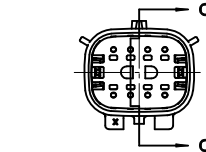
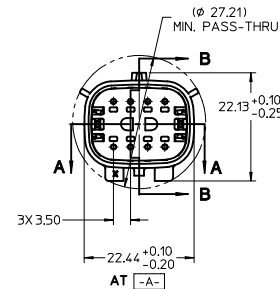

SECTION D-D

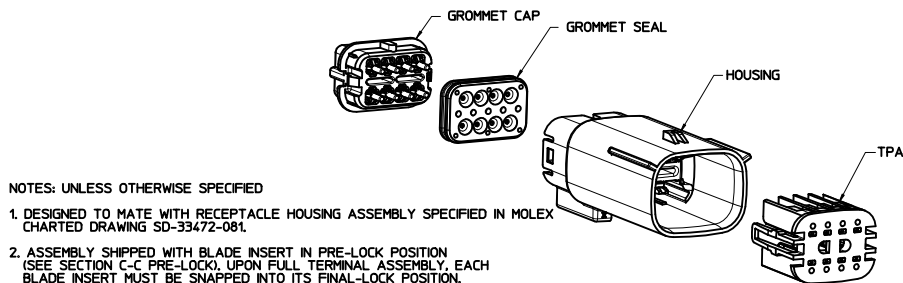

NOTES: UNLESS OTHERWISE SPECIFIED

- DESIGNED TO MATE WITH RECEPTACLE HOUSING ASSEMBLY SPECIFIED IN MOLEX CHARTED DRAWING SD-33472-081.
- ASSEMBLY SHIPPED WITH BLADE INSERT IN PRE-LOCK POSITION (SEE SECTION C-C PRE-LOCK). UPON FULL TERMINAL ASSEMBLY, EACH BLADE INSERT MUST BE SNAPPED INTO ITS FINAL-LOCK POSITION.
- FOR BLADE TERMINALS TO BE USED WITH THIS ASSEMBLY, SEE DRAWING SD-33000-001.
- SYSTEM TO BE USED WITH WIRE WITHIN DIAMETER RANGE OF 1.5mm TO 2.5mm.
- MATERIAL: SPS/NYLON BLEND, 20% GLASS FILLED.
- CHENGDU ASSEMBLIES SHALL CONFORM TO PACKAGING SPECIFICATION PK-31300-635
- SHALL CONFORM TO PRODUCT SPECIFICATION PS-33472-000.
- ASSEMBLY CONFORMS TO SAE/USCAR-2 REV 4 WITH THE FOLLOWING EXCEPTIONS:  
TERMINAL INSERTION FORCE FOR WIRE SIZE ABOVE 2.5mm NOT EXCEEDING 2.69mm SHALL NOT EXCEED 45 NEWTONS.

<b>ENTER DESCRIPTION</b> IEC NO: UAU2010-1454 DRAWN BY: DRWN:AH01 CHECKED BY: CHKD:GRFFTHS APPROV: VIOSHY 2010/02/04 2010/02/17 2010/02/17	<b>QUALITY SYMBOLS</b> ∇=0 ∇=0 ∇=0	<b>GENERAL TOLERANCES (UNLESS SPECIFIED)</b>		DIMENSION STYLE <b>MM ONLY</b>	SCALE <b>2:1</b>	DESIGN UNITS <b>METRIC</b>	THIRD ANGLE PROJECTION	
		4 PLACES ±0.10 3 PLACES ±0.15 2 PLACES ±0.20 1 PLACE ±0.30	±0.10 ±0.15 ±0.20 ±0.30	±0.10 ±0.15 ±0.20 ±0.30	±0.10 ±0.15 ±0.20 ±0.30	DRAWN BY: DMARCOUX DATE: 06-17-02 CHECKED BY: DGRIFFITHS DATE: 06-17-02 APPROVED BY: FHOLUB DATE: 06-17-02	TITLE: <b>MX150 BLADE CONNECTOR          ASSEMBLY 2 ROW SEALED,          8 WAY</b>	<b>MOLEX INCORPORATED</b>
DRAFT WHERE APPLICABLE MUST REMAIN WITHIN DIMENSIONS		AS NOTED		THIS DRAWING CONTAINS INFORMATION THAT IS PROPRIETARY TO MOLEX INCORPORATED AND SHOULD NOT BE USED WITHOUT WRITTEN PERMISSION				