

G9012

PNP EPITAXIAL TRANSISTOR

Description

The G9012 is designed for use in 1W output amplifier of portable radios in class B push-pull operation.

Package Dimensions

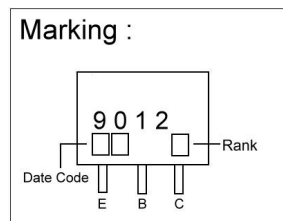
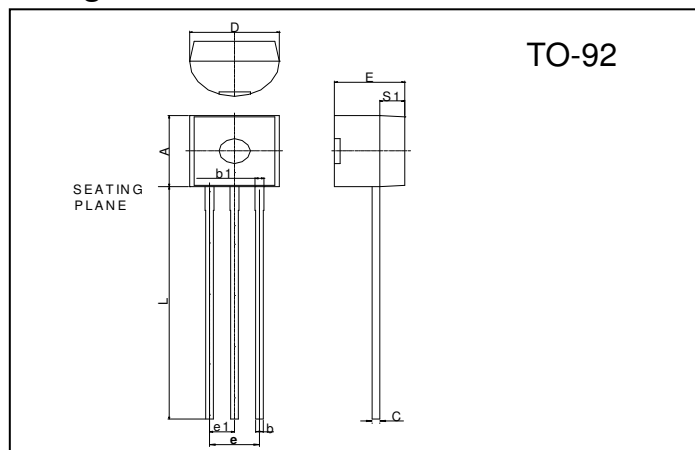

REF.	Millimeter		REF.	Millimeter	
	Min.	Max.		Min.	Max.
A	4.45	4.7	D	4.44	4.7
S1	1.02	-	E	3.30	3.81
b	0.36	0.51	L	12.70	-
b1	0.36	0.76	e1	1.150	1.390
C	0.36	0.51	e	2.42	2.66

Absolute Maximum Ratings at Ta = 25°C

Parameter	Symbol	Ratings	Unit
Junction Temperature	Tj	+150	°C
Storage Temperature	Tstg	-55 ~ +150	°C
Collector to Base Voltage	VCBO	-40	V
Collector to Emitter Voltage	VCEO	-20	V
Emitter to Base Voltage	VEBO	-5	V
Collector Current	IC	-500	mA
Total Power Dissipation	PD	625	mW

Characteristics at Ta = 25°C

Symbol	Min.	Typ.	Max.	Unit	Test Conditions
BVCBO	-40	-	-	V	IC=-100uA, IE=0
BVCEO	-20	-	-	V	IC=-1mA, IB=0
BVEBO	-5	-	-	V	IE=-100uA, IC=0
ICBO	-	-	-100	nA	VCB=-25V, IE=0
IEBO	-	-	-100	nA	VEB=-3V, IC=0
VCE(sat)	-	-	-0.6	V	IC=-500mA, IB=-50mA
VBE(sat)	-	-	-1.2	V	IC=-500mA, IB=-50mA
VBE(on)	-	-	-0.9	V	VCE=-1V, IC=-10mA
hFE1	112	180	300		VCE=-1V, IC=-50mA
hFE2	40	-	-		VCE=-1V, IC=-500mA
fT	100	-	-	MHz	VCE=-1V, IC=-10mA, f=100MHz
Cob	-	-	8	pF	VCB=-10V, f=1MHz

Classification Of hFE1

Rank	G	H	L
hFE1	112 - 166	144 - 202	176 - 300

Characteristics Curve

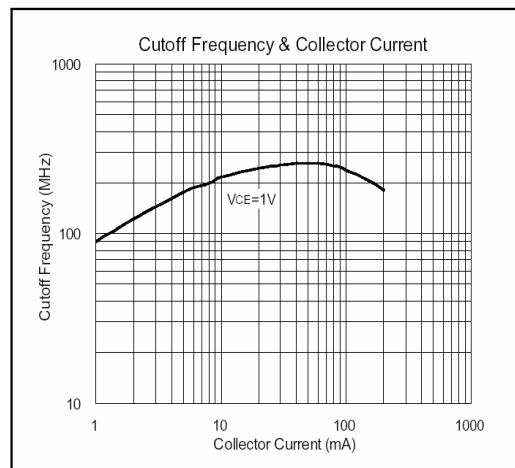
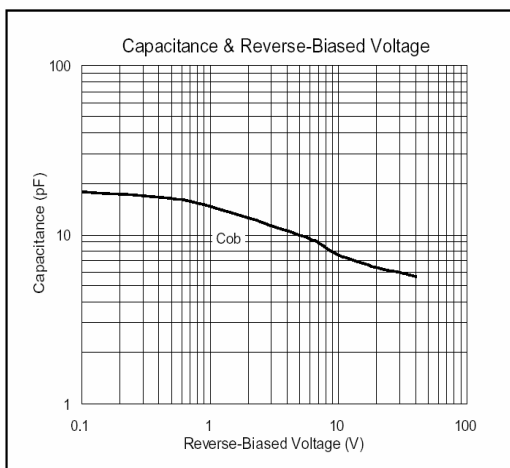
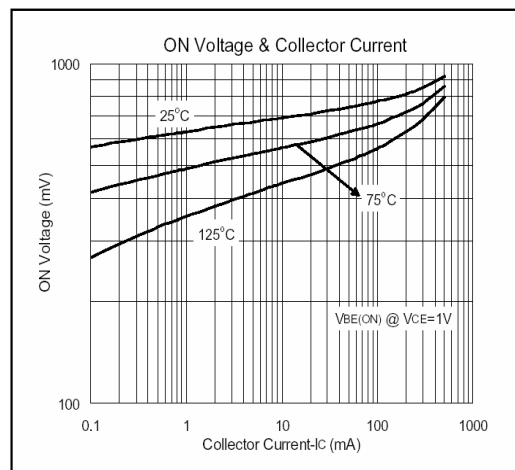
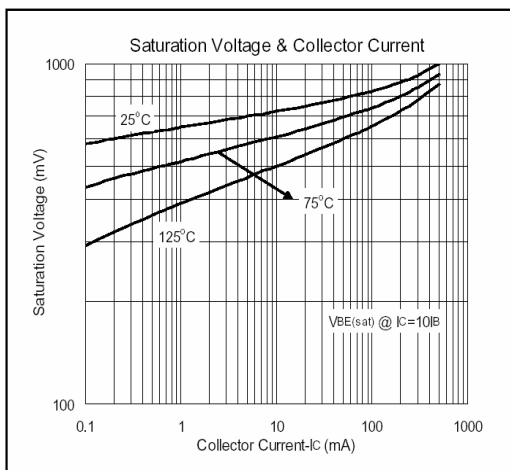
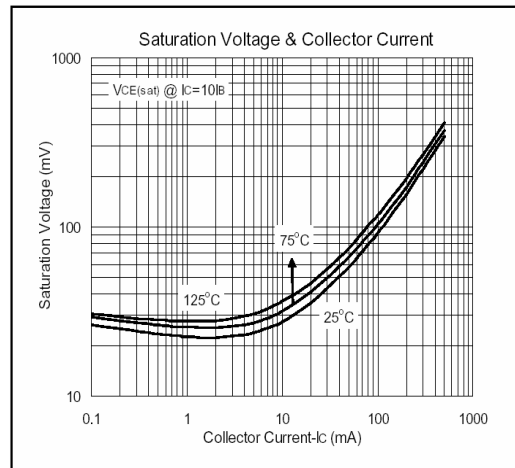
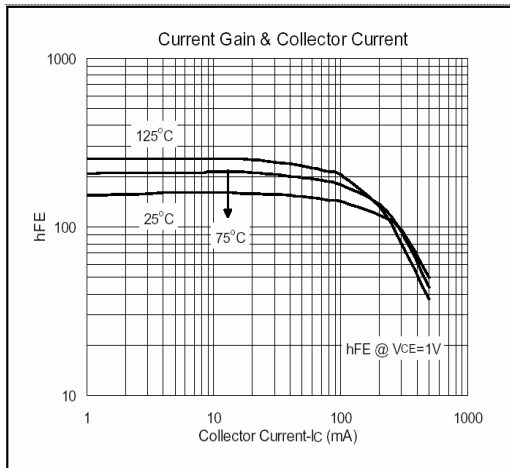

Important Notice:

- All rights are reserved. Reproduction in whole or in part is prohibited without the prior written approval of GTM.
- GTM reserves the right to make changes to its products without notice.
- GTM semiconductor products are not warranted to be suitable for use in life-support Applications, or systems.
- GTM assumes no liability for any consequence of customer product design, infringement of patents, or application assistance.

Head Office And Factory:

- **Taiwan:** No. 17-1 Tatung Rd. Fu Kou Hsin-Chu Industrial Park, Hsin-Chu, Taiwan, R. O. C.
- TEL : 886-3-597-7061 FAX : 886-3-597-9220, 597-0785
- **China:** (201203) No.255, Jang-Jiang Tsai-Lueng RD. , Pu-Dung-Hsin District, Shang-Hai City, China
- TEL : 86-21-5895-7671 ~ 4 FAX : 86-21-38950165