

**Fulleon** [Back to Contents](#)**DATASHEETS**

## Askari Electronic Sounders

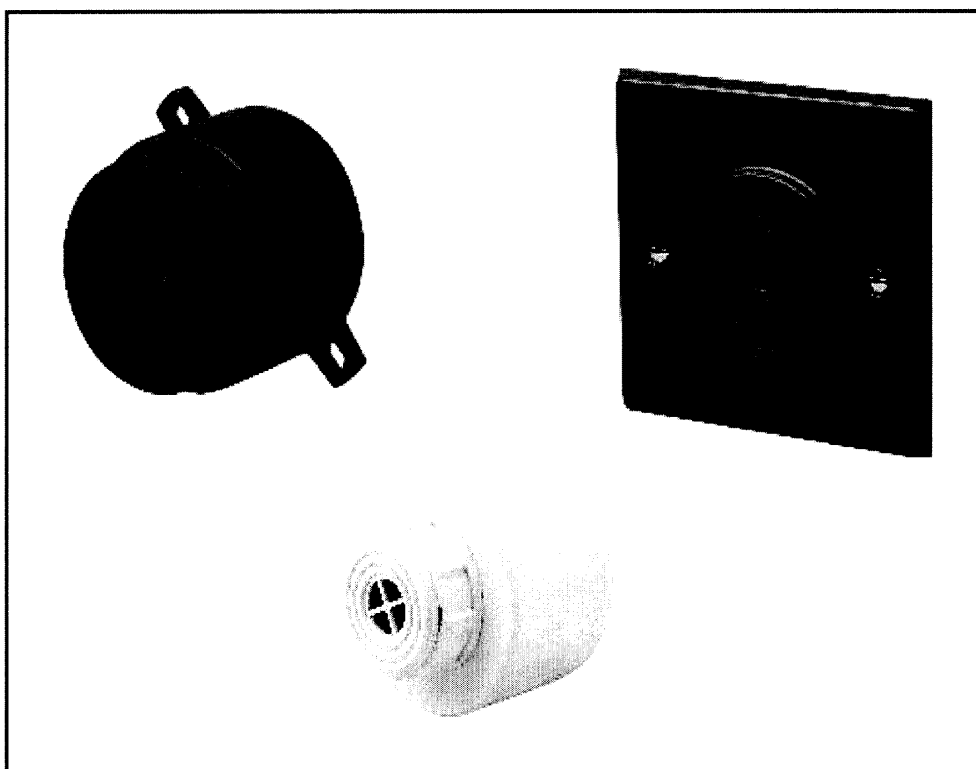

The Askari range of electronic sounders has been developed to provide alarm signals for a wide variety of fire, commercial and industrial signalling applications.

Designed for reliability in operation, three different models are available: the Askari Compact sounder for use in hotel bedrooms and other areas where unobtrusive installation is important; the Askari Panel, for panel mounting and use in industrial instrumentation and control centre applications; the Askari Flange, for surface mounting within cabinets and machines for industrial control, transport and vending machine applications.

- **28 SIGNAL TONES AVAILABLE**
- **12V DC & 24V DC OPERATION IN SAME SOUNDER NO ADJUSTMENT REQUIRED**
- **HIGH SOUND OUTPUT WITH LOW CURRENT CONSUMPTION**
- **AUTOMATIC SYNCHRONISED PHASED START**
- **ENCAPSULATED ELECTRONICS**

- AVAILABLE IN RED OR WHITE ABS MOULDING
- VERSIONS APPROVED TO CNPP REQUIREMENTS

## Askari Specifications

### Askari Compact

The Askari Compact is an ideal electronic sounder for use in hotel bedrooms and has been designed to meet the requirements of BS5839 Part 1 with regard to sound output in sleeping risk areas, its compact design will blend in with most decors to provide an unobtrusive flush or surface mounting sounder.

- The sounder is supplied pre-set to any one of 28 tones (see tone table). The unit is set to tone 3 unless specified otherwise.
- A second pre-set tone is available if a third wire is installed in the sounder circuit (see tone table).
- The sounder can be flush mounted using a standard single gang flush mounting box (minimum box depth of 36mm to allow wiring termination clearance), or a surface mounting box can be supplied.
- The signal tones available match those available for the Roshni and Squashni range of sounders and can therefore be mixed in the same system.
- Volume control.
- Available in red or white ABS moulding.

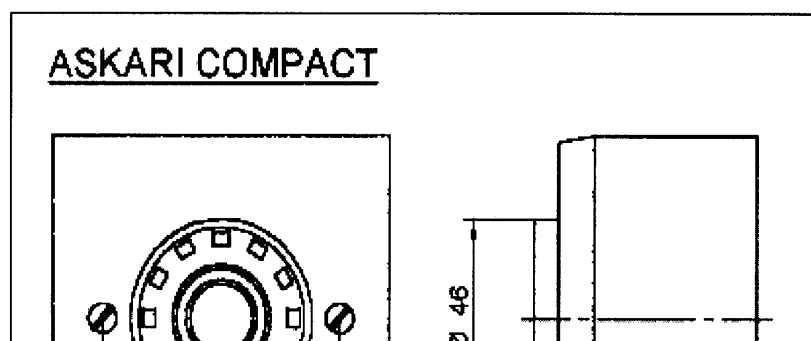
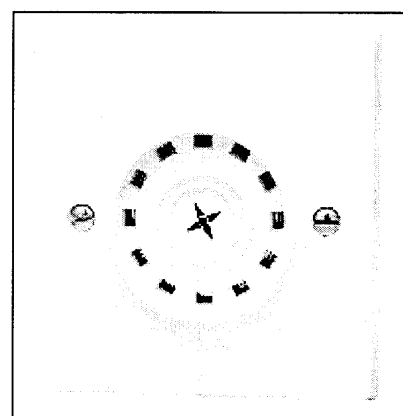
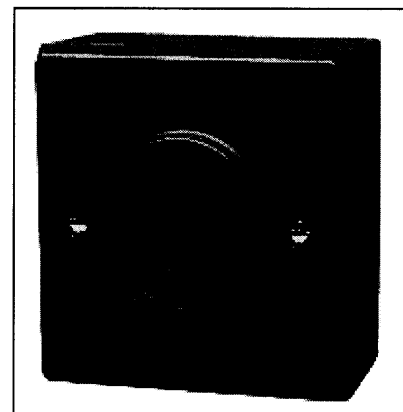

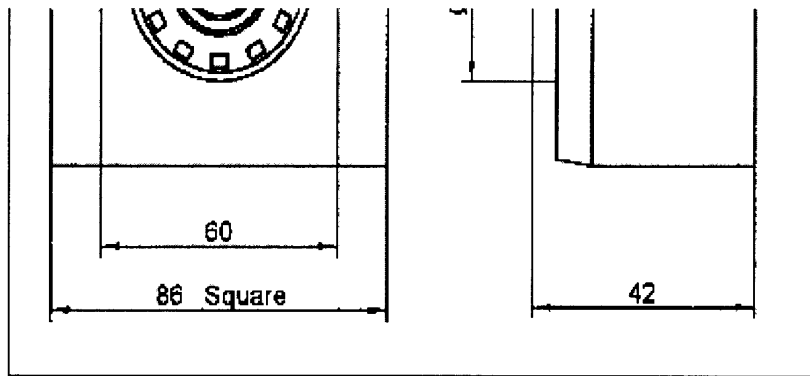

## Askari Flange

The Askari Flange sounder is designed for use in applications where an alarm signal is required from within cabinets or machines. The sounder has a wide variety of applications including pedestrian crossing sound signals, vending machine security alarms etc.

- Two protruding flanges enable the sounder to be securely fixed to any surface.
- The sounder is supplied pre-set to any one of 28 tones (see tone table). The unit is set to tone 5 unless specified otherwise.
- A second pre-set tone is available if a third wire is installed in the sounder circuit (see tone table).

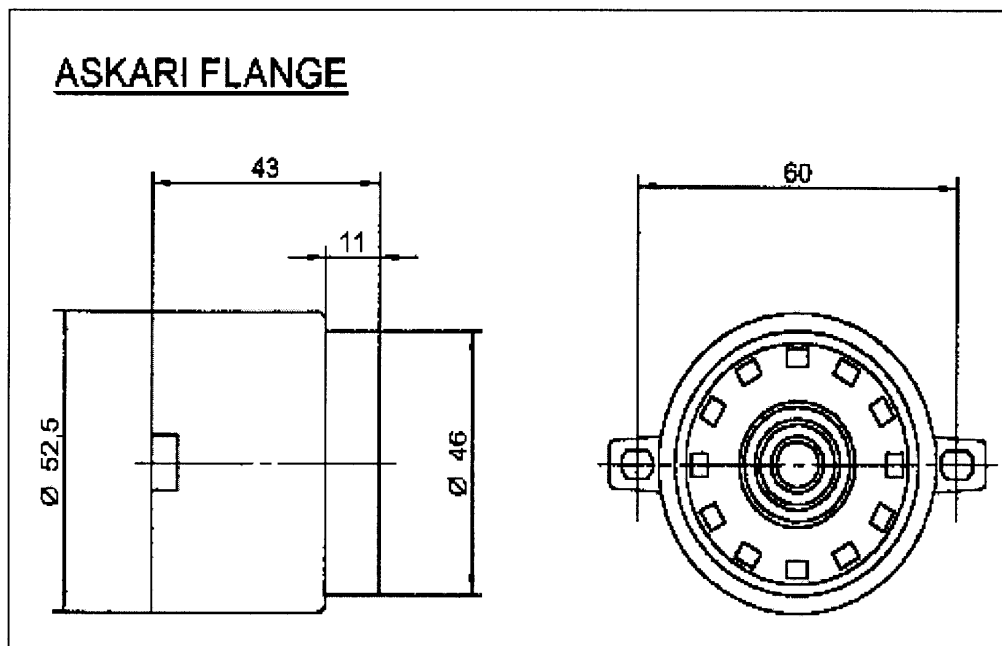
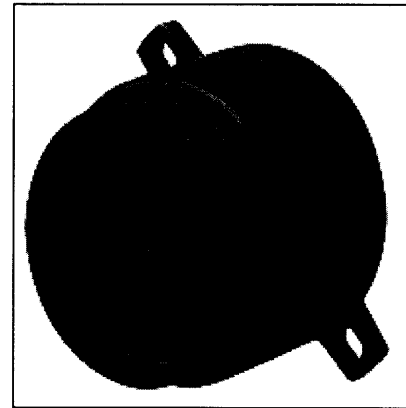

## Askari Panel

The Askari Panel sounder has been developed for instrumentation and control panel alarms, being designed for easy mounting onto panel fronts.

- The screw on top clamps the sounder body to the panel surface.
- The sounder is supplied pre-set to one of 28 different tones (see tone table). The unit is set to tone 5 unless specified otherwise.
- A second pre-set tone is available if a third wire is installed in the sounder circuit (see tone table).
- The Askari Panel sounder is supplied with three flying leads for circuit connection.
- Optional volume control.

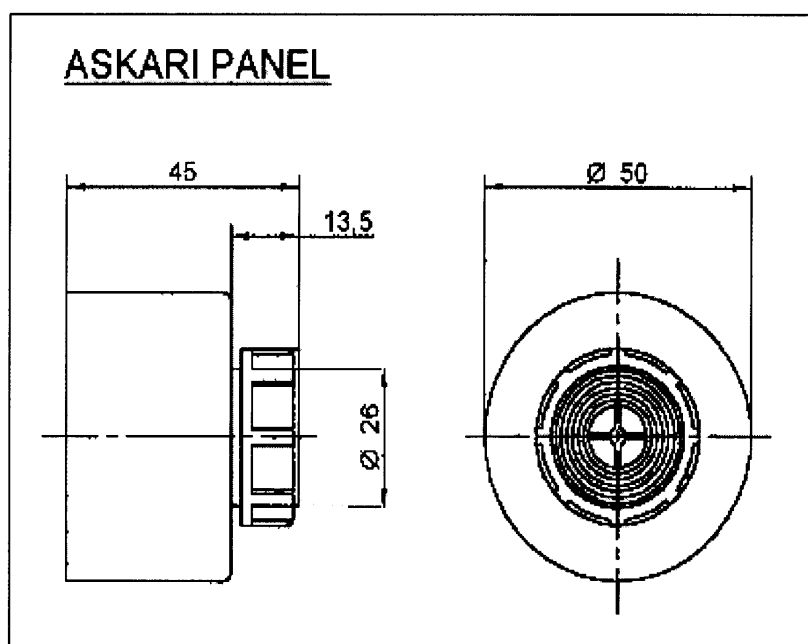
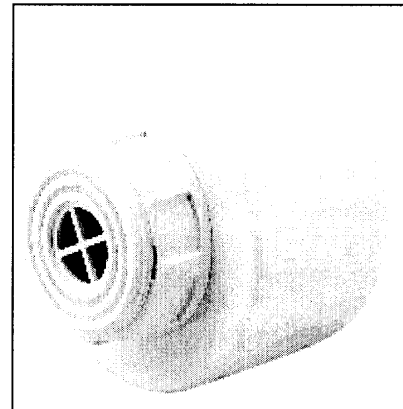

A 26mm dia. panel aperture required for fixing.

## Specifications

Model No	Askari Compact	Askari Flange	Askari Panel
Operation	Continuously Rated		
Operating Voltage Range	9 - 28V DC		
Sound Output	See table below		

Current Consumption	See table below		
Starting Current	30mA for 2 milliseconds		
Starting Time	1.5 milliseconds		
Automatic Synchronisation	Synchronised phased start		
Frequency Stability	+/- 0.5%		
Operating Temperature	-40°C to +80°C		
Line Monitoring Method	Polarised Input		
Construction	ABS plastic case Red or White		
Ingress Protection	IP54 with back box	IP65	IP65
Dimensions	85.75mm x 85.75mm x 36mm deep	50mm dia. x 44mm deep	52mm dia. x 43mm deep
Weight	109g	85g	95g

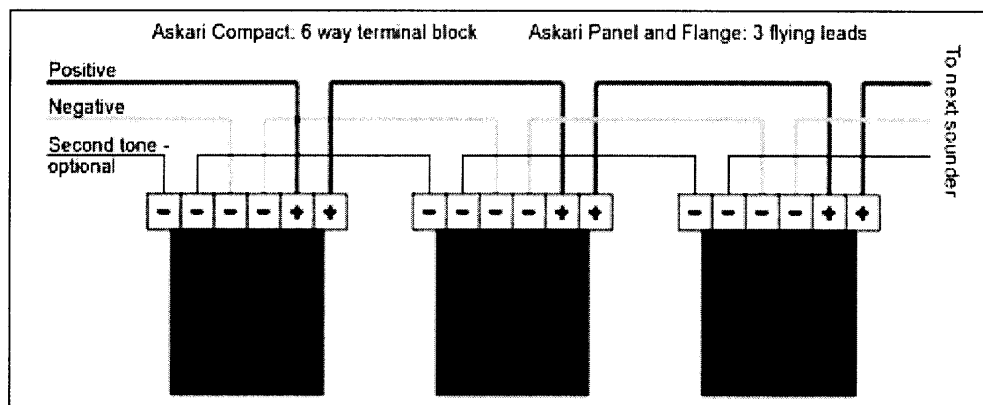

No.	Tones	2nd Tone	Code 12345	Description	Typical current (average mA)		Typical Sound Output $\pm 2\text{dBA}$ at 1m	
					12V	24V	12V	24V
1	Alternating Tones 800/970 at 2 Hz	14	11111		10	18	91	95
2	Sweeping 800/970 Hz at 7 Hz	14	11110	Fast Sweep (LF)	10	18	94	97
3	Sweeping 800/970 Hz at 1 Hz	14	11101	Medium Sweep (LF)	10	18	94	97
4	Continuous at 2850 Hz	14	11100		16	32	102	105
5	Sweeping 2400-2850 Hz at 7 Hz	4	11011	Fast Sweep	18	30	101	106
6	Sweeping 2400-2850 Hz at 1 Hz	4	11010		17	30	101	106

	1 Hz							
7	Slow Whoop	14	11001	Slow Whoop	12	20	92	96
8	Sweep 1200-500 Hz at 1 Hz	14	11000	Din Tone	9	16	91	95
9	Alternating Tones 2400/2850 2 Hz	4	10111		19	30	100	105
10	Intermittent Tone of 970 Hz at 1Hz	14	10110	Back-up Alarm (LF)	9	12	89	93
11	Alternating Tones 800/970 Hz at 1Hz	14	10101		10	18	90	95
12	Intermittent Tone at 2850 Hz at 1Hz	4	10100	Back-up Alarm (HF)	14	24	101	105
13	970 Hz at 1/4 sec. on 1 sec. off	14	10011		5	8	85	90
14	Continuous at 970 Hz	14	10010		11	20	90	94
15	554 for 100 ms and 440 Hz for 400ms	14	10001	French Fire Sound	7	12	86	91
16	Intermittent 660 Hz 150ms On/150 ms Off	16	10000	Swedish Alarm Tone	6	9	83	88
17	Intermittent 660 Hz 1.8s On/1.8s Off	17	01111	Swedish Alarm Tone	7	12	85	90
18	Intermittent 660 Hz 6.5s On/13s Off	18	01110	Swedish Alarm Tone	8	14	86	91
19	Continuous 660 Hz	19	01101	Swedish Alarm Tone	8	14	86	91
20	Alternating 554/440 Hz at 1 Hz	20	01100	Swedish Alarm Tone	7	13	86	91
21	Intermittent 660 Hz at 1 Hz	21	01011	Swedish Alarm Tone	6	10	84	89
22	Intermittent 2850 Hz 150 ms On/100 ms Off	14	01010	Pelican Crossing	13	22	100	105
23	Sweep 800-970 Hz at 50 Hz	14	01001	Low Frequency Buzz	10	18	92	96
24	Sweep 2400-2850 Hz at 50 Hz	4	01000	High Frequency Buzz	14	25	100	106
25	Intermittent 970Hz 500ms On/500ms Off	25	00111	ISO 8201 Low Frequency	9	14	88	92
26	Intermittent 2850Hz 500ms On/500ms Off	26	00110	ISO 8201 High Frequency	12	20	100	104
27	Continuous at 4kHz	27	00101		18	35	97	101
28	Alternating tones 800/970 at 2Hz	10	00100	FP1063.1	10	17	91	95

**N.B.** Sound output figures for the Flange and Panel sounders are typically 5dB(A) less than for the Compact sounder.

ORDERING CODES		EXAMPLE: AC/R/3/BB	
_ _ _ _ _		Askari Compact/Red/Tone 3/Back Box	
	VC	-	Optional volume control (Flange and Panel only)
	BB	-	Back box for surface mounting (Compact only)
	nn	-	Tone number
	R or W	-	Red or White ABS moulding
AC		Askari Compact	

AC	-	Askari Compact
AP	-	Askari Panel
AF	-	Askari Flange

We reserve the right to change, without prior notice, the specification of these products from that detailed.  
Data shown is typical for operation under normal ambient conditions.

**FULLEON LTD**

Llantarnam Park,  
Cwmbran, Gwent NP44  
3AW.  
Tel: +44 (0) 1633 872131  
Fax: +44 (0) 1633 866346



BS EN ISO 9001:1994  
Certificate Number FM351193

E-mail:

[sales@fulleon.co.uk](mailto:sales@fulleon.co.uk) URL:

<http://www.fulleon.co.uk>



◀ Back to Contents