

Features and Benefits

- Prepare the cable according to the Template.
- Apply one drop of accelerant to ferrule face of the connector.
- Apply the One part Adhesive on the fibre According to the Template. (No measuring or mixing is required)
- Insert the Fibre completely into the connector.
- For jacketed cable, Crimp tubing over the back of the connector.
- After 2 minutes, Cleave the fibre.
- Polish the connector end according to the Termination procedure
- Low Insertion loss 0.34 dB Typ.
- Operation Temperature -20°C to 70°C
- Comply with EIA/TIA 568A
- 900µm & 3mm Boot
- No specific tooling required
- Termination time : 2min

Ordering Information

This product is supplied in a kit with the following :

- 12 SC connectors, Polymeric Body.
- 3mm & 900µm boots.
- One tube of adhesive.
- One tube of Accelerant.
- Stripping template.
- Termination procedure printed on the kit

Shipping Weight : 80g

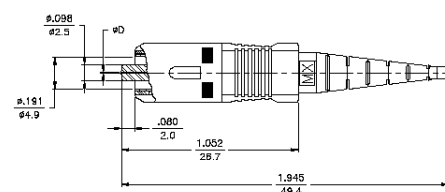
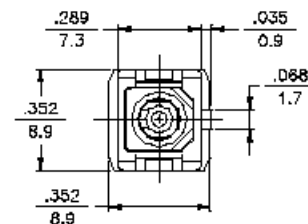
SC Connector Dimensions

Order No.	Description
AFR-00011	Xpress Termination Kit 12 SC Connectors
AFR-00006	SC Termination toolkit
91.A1080	SC Polishing Disk
91.A0900	Universal Cleaving Tool
91.A1290	Xpress consumable kit for 5 Kits or 60 Connectors

MOLEX PREMISE NETWORKS

Molex Premise
Networks
Corporate Headquarters
Tel: 603 324 0200
www.molexpn.com

Western Europe
Headquarters
Tel: 44 (0) 1489 572111
www.molexpn.co.uk

Eastern Europe
Headquarters
Tel: 48 22 36 92 51
www.molexpn.com.pl

Asia Headquarters
Tel: 852 2637 3759
www.molexpn.com.hk

South Pacific
Headquarters
Tel: 61 3 9747 8322
www.molexpn.com.au

Molex Incorporated
Tel: 630 969 4550
www.molex.com