

PLEASE CHECK WWW.MOLEX.COM FOR LATEST PART INFORMATION

Part Number: [0757570342](#)
Status: **Active**
Overview: mx150 unshrouded breakaway header
Description: 3.50mm (.138") Pitch, MX150™ Header, Breakaway, Vertical, 4 Circuits, 1.25µm (50µ") Nickel (Ni) Overall, 2.50µm (100µ") Minimum Select Matte Tin (Sn) Plating on Tail, 0.75µm Minimum Select Gold (Au) Contact Area, 11.20mm (.440") Mating Pin Length, 4.75mm (.187") PC Tail Length

Documents:

| | |
|---|--|
| Application Specification (PDF) | Packaging Specification (PDF) |
| Drawing (PDF) | Product Specification PS-75757-000 (PDF) |
| 3D Model | RoHS Certificate of Compliance (PDF) |

General

| | |
|----------------|---|
| Product Family | PCB Headers |
| Series | 75757 |
| Application | Wire-to-Board |
| Overview | mx150 unshrouded breakaway header |
| Product Name | MX150™ |

Physical

| | |
|--------------------------------|--------------------------------|
| Breakaway | Yes |
| Circuits (Loaded) | 4 |
| Circuits (maximum) | 4 |
| Circuits Detail | 4 |
| Color - Resin | Black |
| Durability (mating cycles max) | 25 |
| First Mate / Last Break | No |
| Glow-Wire Compliant | No |
| Guide to Mating Part | No |
| Keying to Mating Part | None |
| Lock to Mating Part | None |
| Material - Metal | Brass |
| Material - Plating Mating | Gold |
| Material - Plating Termination | Tin |
| Material - Resin | High Temperature Thermoplastic |
| Number of Rows | 1 |
| Orientation | Vertical |
| PC Tail Length (in) | 0.187 In |
| PC Tail Length (mm) | 4.75 mm |
| PCB Locator | No |
| PCB Retention | None |
| PCB Thickness Recommended (in) | 0.093 In |
| PCB Thickness Recommended (mm) | 3.20 mm |
| Packaging Type | Tube |
| Pitch - Mating Interface (in) | 0.138 In |
| Pitch - Mating Interface (mm) | 3.50 mm |
| Pitch - Term. Interface (in) | 0.138 In |
| Pitch - Term. Interface (mm) | 3.50 mm |
| Plating min: Mating (µin) | 30 |
| Plating min: Mating (µm) | 0.75 |
| Polarized to Mating Part | No |
| Polarized to PCB | No |
| Shrouded | No |
| Surface Mount Compatible (SMC) | Yes |
| Temperature Range - Operating | -40°C to +125°C |



image - Reference only

Series

EU RoHS

ELV and RoHS Compliant
REACH SVHC Not Reviewed
Halogen-Free Status Not Reviewed

China RoHS



Need more information on product environmental compliance?

Email productcompliance@molex.com
 For a multiple part number RoHS Certificate of Compliance, [click here](#)

Please visit the [Contact Us](#) section for any non-product compliance questions.

Search Parts in this Series

[75757Series](#)

Mates With

[33471](#) Single Row MX150™ Receptacles.
[33472](#) Dual Row MX150™ Receptacles

Termination Interface: Style

Through Hole

Electrical

Current - Maximum per Contact

16A

Voltage - Maximum

500V DC

Material Info

Reference - Drawing Numbers

Application Specification

AS-75757-104

Packaging Specification

PK-75757-007

Product Specification

PS-75757-000

Sales Drawing

SD-75757-010

Test Summary

TS-75757-001

This document was generated on 05/31/2010

PLEASE CHECK WWW.MOLEX.COM FOR LATEST PART INFORMATION

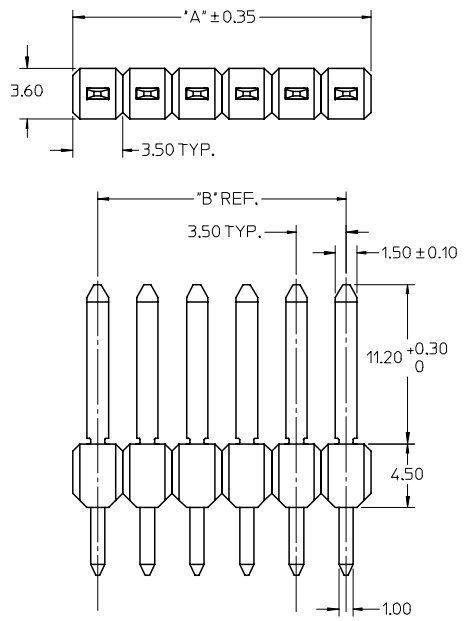

- NOTES:
1. TERMINAL MAT'L: ALLOY C26000, CARTRIDGE BRASS
 2. WAFER MAT'L: 30% GLASS FILLED LCP, 94V-0, COLOR BLACK.
 3. TERMINAL PLATING:
 - OPTION 4 - 1.54µm MIN MATTE TIN OVERALL OVER 1.254µm NICKEL OVERALL
 - OPTION 1 - 2.54µm MIN MATTE TIN OVERALL OVER 1.254µm NICKEL OVERALL
 - OPTION 2 - 1.254µm NICKEL OVERALL 2.54µm MIN SELECT MATTE TIN PC TAIL AREA 0.054µm MIN SELECT GOLD CONTACT AREA
 - OPTION 3 - 1.254µm NICKEL OVERALL 2.54µm MIN SELECT MATTE TIN PC TAIL AREA 0.754µm SELECT GOLD CONTACT AREA
 4. HEADER ASSEMBLIES ARE TUBE PACKAGED PER PK-75757-9910.
 5. COMPLIES WITH USCAR 1.5mm TERMINAL BLADE SPECIFICATION.

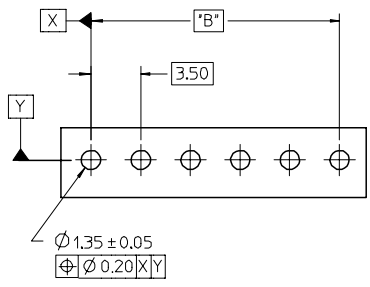
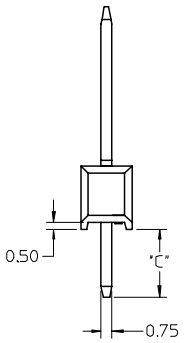

RECOMMENDED PCB LAYOUT

| CKT SIZE | PLATING OPTION | MATERIAL NUMBER | *A* DIM | *B* DIM | *C* DIM | MATERIAL NUMBER | *A* DIM | *B* DIM | *C* DIM |
|----------|----------------|-----------------|---------|---------|---------|-----------------|---------|---------|---------|
| 1 x 2 | 1 | 75757-0121 | 7 | 3.5 | 3.05 | 75757-0122 | 7 | 3.5 | |
| | 2 | 75757-0221 | | | | 75757-0222 | | | |
| | 3 | 75757-0321 | | | | 75757-0322 | | | |
| | 4 | 75757-0421 | | | | 75757-0422 | | | |
| 1 x 3 | 1 | 75757-0131 | 10.5 | 7.00 | 3.05 | 75757-0132 | 10.5 | 7.00 | |
| | 2 | 75757-0231 | | | | 75757-0232 | | | |
| | 3 | 75757-0331 | | | | 75757-0332 | | | |
| | 4 | 75757-0431 | | | | 75757-0432 | | | |
| 1 x 4 | 1 | 75757-0141 | 14.0 | 10.50 | 3.05 | 75757-0142 | 14.0 | 10.50 | 4.75 |
| | 2 | 75757-0241 | | | | 75757-0242 | | | |
| | 3 | 75757-0341 | | | | 75757-0342 | | | |
| | 4 | 75757-0441 | | | | 75757-0442 | | | |
| 1 x 5 | 1 | 75757-0151 | 17.5 | 14.00 | 3.05 | 75757-0152 | 17.5 | 14.00 | |
| | 2 | 75757-0251 | | | | 75757-0252 | | | |
| | 3 | 75757-0351 | | | | 75757-0352 | | | |
| | 4 | 75757-0451 | | | | 75757-0452 | | | |
| 1 x 6 | 1 | 75757-0161 | 21.0 | 17.50 | 3.05 | 75757-0162 | 21.0 | 17.50 | |
| | 2 | 75757-0261 | | | | 75757-0262 | | | |
| | 3 | 75757-0361 | | | | 75757-0362 | | | |
| | 4 | 75757-0461 | | | | 75757-0462 | | | |

| | | | | | | | | | | |
|---|-----------------------------|---|-------|------------------------------|---|--|------------------------|------------------------|--|--|
| REMOVED 1X2 PINS EC NO: UICP2008-0959 DRAWN/DROSICA 2007/10/25 CHKD: 2007/10/25 APPR: JCOMERC.L 2007/10/25 REV | QUALITY SYMBOLS =0 =0 | GENERAL TOLERANCES (UNLESS SPECIFIED) | | DIMENSION STYLE MM ONLY | | SCALE 4:1 | DESIGN UNITS METRIC | THIRD ANGLE PROJECTION | | |
| | | mm | INCH | DRAWN BY TMCCLELL | DATE 1/24/06 | MX150 SINGLE ROW BREAK-AWAY VERTICAL HEADER ASSEMBLY | | | | |
| | | 4 PLACES ± --- | ± --- | CHECKED BY TMCCLELL | DATE 1/24/06 | | | | | |
| | | 3 PLACES ± --- | ± --- | APPROVED BY BANAKIS | | DATE 1/24/06 | MOLEX INCORPORATED | | | |
| 2 PLACES ± 0.13 | ± --- | MATERIAL NO. SEE CHART | | DOCUMENT NO. SD-75757-010 | | | | | | |
| 1 PLACE ± 0.25 | ± --- | DRAFT WHERE APPLICABLE MUST REMAIN WITHIN DIMENSIONS | | SIZE C | THIS DRAWING CONTAINS INFORMATION THAT IS PROPRIETARY TO MOLEX INCORPORATED AND SHOULD NOT BE USED WITHOUT WRITTEN PERMISSION | | | | | |
| ANGULAR ±1/2° | | | | | | SHEET NO. 1 OF 1 | | | | |