

Dialight

Vehicle Strip Lighting

18.5 inch (470mm) 12 inch (305mm) 6 inch (153mm)

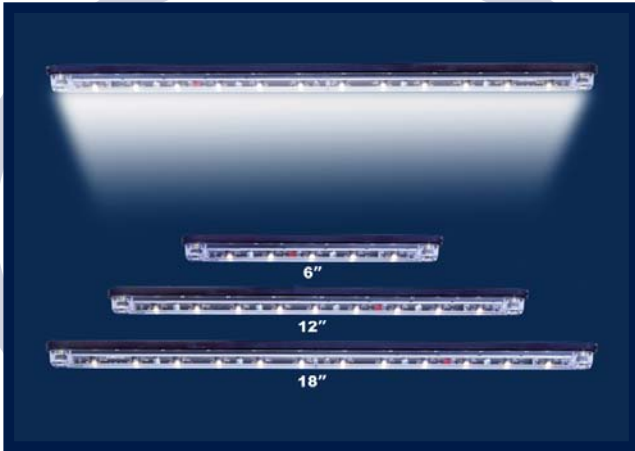

FEATURES / BENEFITS

- ▲ Low power consumption
- ▲ Wide angle uniform beam
- ▲ Long life
- ▲ Robust design
- ▲ Suitable for both indoor and outdoor applications
- ▲ Shatterproof diffused lens
- ▲ Shock and vibration resistant
- ▲ Saves money - reduces maintenance cost

APPLICATION

Dialight's Vehicle Strip Light is a high intensity lighting application designed for doorways, engine compartments, and multiple other locations where intense lighting is needed within a sleek design.

OPERATING CONDITIONS

- ▲ Operating Temperature: -40°C to +55°C
- ▲ Storage Temperature:
 - Standard Lens: -40°C to +120°
 - High Temperature Lens: -40°C to +149°

MATERIALS / FINISH

- ▲ Housing Material: Anodized Aluminum
- ▲ Lens Material:
 - Std. Lens: Polycarbonate UL94 Flammability Rating
 - High Temperature Lens: Polysulfone
- ▲ 18 AWG lead wire from rear of housing

PART NUMBERS

PART NUMBER	SIZE	TYPICAL LUMEN OUTPUT	COLOR	LENS	VOLTAGE
VSL-CC-17B-35-802	18.5"	300	Cool White	clear	10-30 volts
VSL-CC-17B-35-806	18.5"	150	Warm White	clear	10-30 volts
VSL-CC-17B-35-811	18.5"	300	Cool White	high temptature	10-30 volts
VSL-CC-37B-35-809	18.5"	450	Cool White	clear	24 volts
VSL-CC-37B-35-810	18.5"	450	Cool White	high temptature	24 volts
VSL-CC-16B-35-802	12"	275	Cool White	clear	10-30 volts
VSL-CC-16B-35-803	12"	275	Cool White	high temptature	10-30 volts
VSL-CC-15B-35-801	6"	80	Cool White	clear	10-30 volts
VSL-CC-15B-35-802	6"	140	Cool White	clear	10-30 volts
VSL-CC-15B-35-813	6"	140	Cool White	high temptature	10-30 volts

Dialight Europe Ltd

Exning Road • Newmarket • Suffolk, United Kingdom, CB8 0AX
 Tel :+44 (0)1638 666541 • www.dialight.com



Dialight Corporation

1501 Route 34 South • Farmingdale, NJ 07727 USA
 Tel: (1) 732-919-3119 • Fax: (1) 732-751-5778 • www.dialight.com



MDTBVSLX001_G

6" STRIP MECHANICAL DRAWING

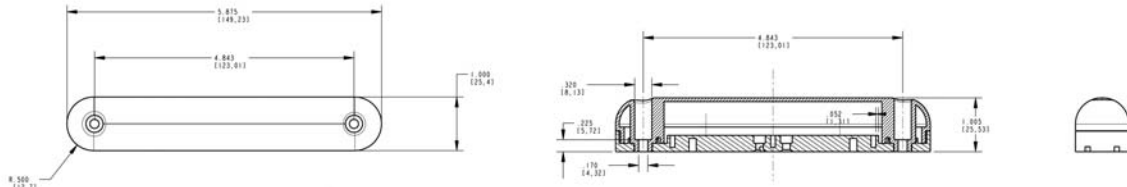

Dimensions specified in inches [mm]

12" STRIP MECHANICAL DRAWING

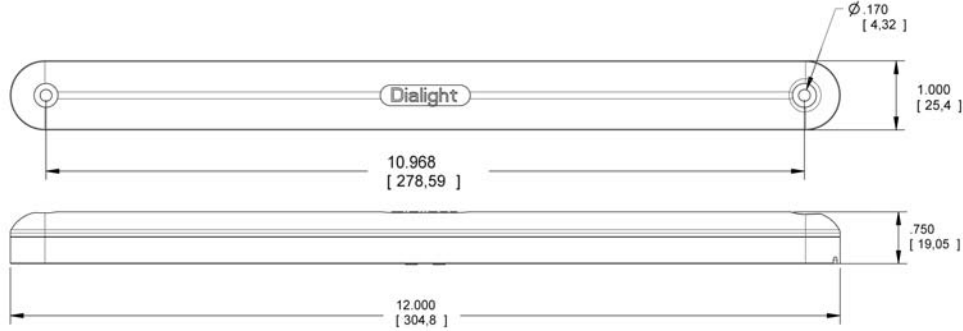

Dimensions specified in inches [mm]

18.5" STRIP MECHANICAL DRAWING

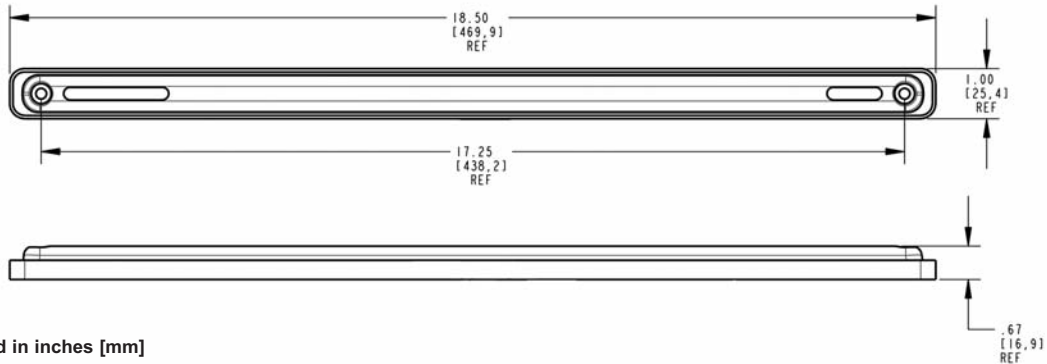

Dimensions specified in inches [mm]

CURRENT DRAW

	12 vdc TYP	24 vdc TYP
18" (1 watt LEDs)	910 mAmps	410 mAmps
18" (3 watt LEDs)	-	1.4 Amps
12" (1 watt LEDs)	700 mAmps	350 mAmps
6" (1 watt LEDs)	270 mAmps	135 mAmps
6" (2 watt LEDs)	580 mAmps	290 mAmps

Dialight Europe Ltd

Exning Road • Newmarket • Suffolk, United Kingdom, CB8 0AX

Tel :+44 (0)1638 666541 • www.dialight.com



Dialight Corporation

1501 Route 34 South • Farmingdale, NJ 07727 USA

Tel: (1) 732-919-3119 • Fax: (1) 732-751-5778 • www.dialight.com



MDTBVSLX001_G