

PLEASE CHECK WWW.MOLEX.COM FOR LATEST PART INFORMATION

Part Number: **0191640004**
Status: **Active**
Description: Perma-Seal™ Ring Tongue Terminal for 18-22 AWG Wire, Stud Size 1/4

Documents:

[Drawing \(PDF\)](#) [RoHS Certificate of Compliance \(PDF\)](#)

Agency Certification

CSA LR18689
 UL E32244

General

Product Family Ring and Spade Terminals
 Series 19164
 Crimp Quality Equipment Yes
 Mil-Spec N/A
 Product Name Perma-Seal™
 Type Ring

Physical

Barrel Type Closed
 Flammability 94V-2
 Insulation NiAc™
 Material - Plating Mating Tin
 Packaging Type Bag
 Stud Size 1/4" (M6)
 Wire Insulation Diameter 5.97mm (.235")
 Wire Size AWG 18, 20, 22
 Wire Size mm² 0.38 - 0.96

Material Info

Old Part Number SA-222-14

Reference - Drawing Numbers

Sales Drawing SD-19164-006

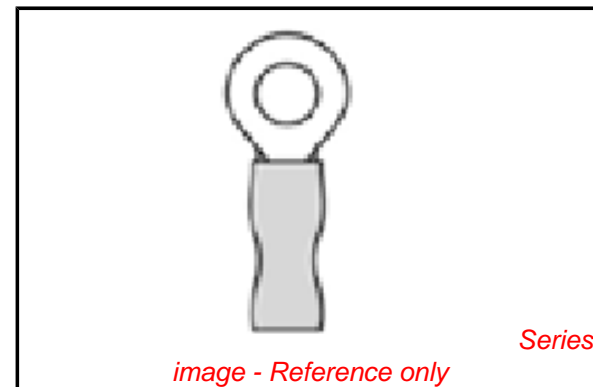

EU RoHS

**ELV and RoHS
 Compliant**
REACH SVHC
 Not Reviewed
**Halogen-Free
 Status**
Not Reviewed

China RoHS



**Need more information on product
 environmental compliance?**

Email productcompliance@molex.com
 For a multiple part number RoHS Certificate of
 Compliance, [click here](#)

Please visit the [Contact Us](#) section for any
 non-product compliance questions.

Search Parts in this Series

19164Series

Application Tooling | [FAQ](#)

*Tooling specifications and manuals are
 found by selecting the products below.
 Crimp Height Specifications are then
 contained in the Application Tooling
 Specification document.*

Global

| Description | Product # |
|---|----------------------------|
| Power Crimp Tool Head for Prema- Seal™ Terminals 10-22 AWG | 0640057400 |
| Hand Crimp Tool, UL Approved | 0640017400 |

| | 10 | 9 | 8 | 7 | 6 | 5 | 4 | 3 | 2 | 1 | |
|---|-----------------|--------------------|-------------------------|----------------------------|-----------|------------------------------------|------------------------|------------------------------|-----------|-----------|-----------|
| F | MATERIAL NUMBER | ENGINEERING NUMBER | MATERIAL NUMBER ON TAPE | ENGINEERING NUMBER ON TAPE | STUD SIZE | HOLE "S" ± 0.005 ± 0.03 | "D" MAX | "H" ± 0.10 ± 0.25 | "L" MAX | "T" REF | ID MIN |
| | 191640085 | SA-221-06 | --- | --- | #6 | $\varnothing .146/3.71$ | $\varnothing .32/8.1$ | --- | 1.46/37.1 | .028/0.71 | .064/1.63 |
| | 191640086 | SA-221-08 | 191640419 | SA-221-08T | #8 | $\varnothing .173/4.39$ | $\varnothing .32/8.1$ | .534/13.56 | 1.46/37.1 | .028/0.71 | .064/1.63 |
| | 191640003 | SA-221-10 | 191640306 | SA-221-10T | #10 | $\varnothing .198/5.03$ | $\varnothing .32/8.1$ | .534/13.56 | 1.46/37.1 | .028/0.71 | .064/1.63 |
| | 191640004 | SA-222-14 | 191640844 | SA-222-14T | 1/4 | $\varnothing .265/6.73$ | $\varnothing .48/12.2$ | .340/8.65 | 1.66/42.2 | .028/0.71 | .055/1.40 |
| | 191640005 | SA-226-38 | 191640845 | SA-226-38T | 3/8 | $\varnothing .390/9.91$ | $\varnothing .54/13.7$ | .328/8.33 | 1.95/49.5 | .032/0.81 | .055/1.40 |

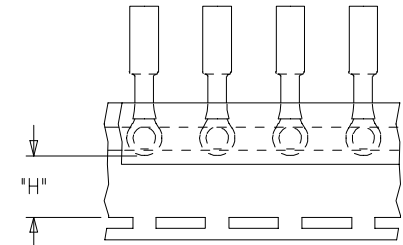
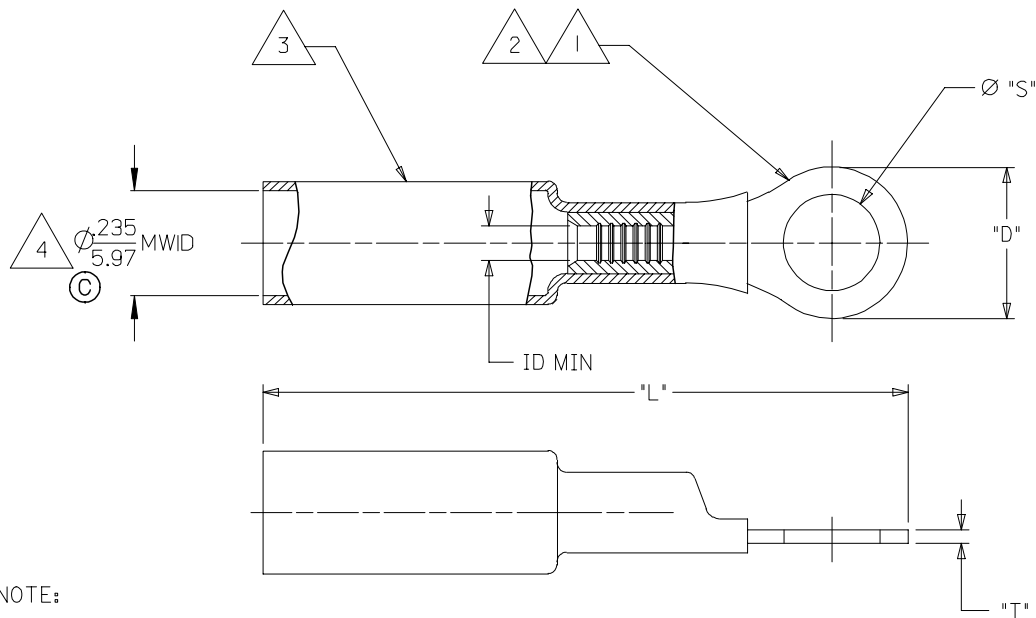

PARTS ON TAPE

SALES DRAWING

- NOTE:
- 1. TERMINAL MATERIAL: COPPER ALLOY
 - 2. FINISH: ELECTRO TIN PLATE.
 - 3. INSULATION MATERIAL: HEAT SHRINKABLE TUBING WITH HOTMELT ADHESIVE INNER LINER. COLOR: RED.
 - 4. MWID = MAXIMUM WIRE INSULATION DIAMETER.

CHANGED MWID
 EC NO: ETC2006-0154
 DRWN:NASAYDEH 2005/12/21
 CHKD: ILOMASTRO 2005/12/21
 APPR: JPAMLIK 2005/12/21

| REV | DESCRIPTION |
|-----|-----------------|
| 1 | QUALITY SYMBOLS |
| 2 | QUALITY SYMBOLS |

| | GENERAL TOLERANCES (UNLESS SPECIFIED) | |
|----------|---------------------------------------|------------|
| | mm | INCH |
| 4 PLACES | \pm --- | \pm --- |
| 3 PLACES | ± 0.13 | $\pm .005$ |
| 2 PLACES | ± 0.25 | $\pm .010$ |
| 1 PLACE | \pm --- | \pm --- |
| ANGULAR | | \pm ---° |

| DIMENSION STYLE | |
|-----------------|-----------|
| IN/MM | |
| DRAWN BY | DATE |
| BENDERLE | 2005/5/14 |
| CHECKED BY | DATE |
| HBEITZEL | 2005/5/14 |
| APPROVED BY | DATE |
| RDEROSS | 2005/5/14 |

| SCALE | DESIGN UNITS | THIRD ANGLE PROJECTION |
|---|--------------|------------------------|
| --- | INCH | |
| TITLE | | |
| RING TONGUE TERMINAL PERMA-SEAL NIAC 22-18 AWG | | |
| MATERIAL NO. DOCUMENT NO. SHEET NO. | | |
| SEE CHART | | SD-19164-006 |
| THIS DRAWING CONTAINS INFORMATION THAT IS PROPRIETARY TO MOLEX INCORPORATED AND SHOULD NOT BE USED WITHOUT WRITTEN PERMISSION | | |