

A Toggle latch to complement the highly successful TL100 adjustable series. This slightly larger latch offers high strength with adjustability in a variety of finishes.

The TL300A is vibration proof, provides for gasket pull up and, when unlocked stows flat to avoid catching on clothing/other equipment and minimises risk of damage.

Strike should be ordered separately. See table.

TECHNICAL DATA

Material : Cold rolled steel or stainless steel

Overall length : 100mm

Overall width : 30,5mm

	Mild Steel	Stainless
Strength	Working tension 2670N (600lbf)	2000N (450lbf)
	Ultimate tension 3560N (800lbf)	3000N (675lbf)

Adjustment : 14mm

Pull up : 5mm

INSTALLATION

Latches and strikes may be fitted with either 5mm Round Head Rivets or 5mm Wood Screws (No. 10 in UK).

FINISHES AND CALL UP

Latch	Strike	Material & Finish
TL300A	TL300-7	Mild Steel Zinc Plated with Chromate Passivation to BS.1706 : Zn.3.
TL300A-1	TL300-7-1	Stainless Steel
TL300-A-5	TL300-7-5	Mild Steel Chromium Plated

TL 300A
LATCH

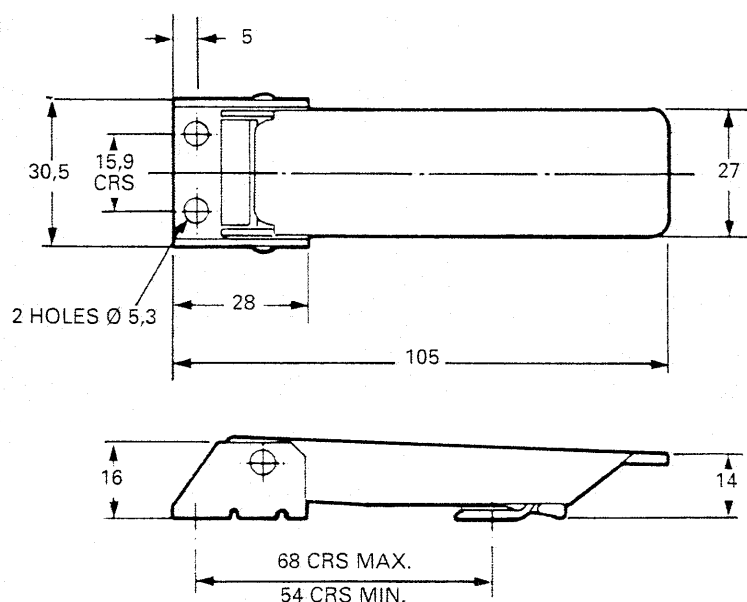

TL 300-7
STRIKE

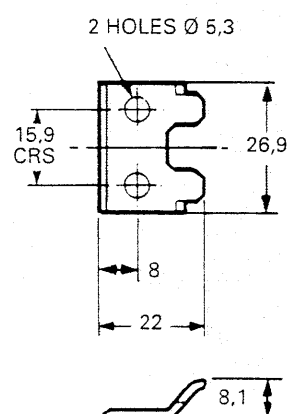

Fixing holes Ø 5,3mm