

SSF-LXH555-2000 SERIES

P.C.B. MICRO-MINI LEDS

FEATURES		APPLICATIONS		MATERIAL SPECIFICATIONS		
<ul style="list-style-type: none"> • Dialight 555 Compatible • Very Small Size • Stackable Package 		<ul style="list-style-type: none"> • Logic Status Indicator • Fault Indicator 		<ul style="list-style-type: none"> • Holder: 94V-O Nylon • Terminals: 7x.25 [] Leads 		
LUMEX PART NBR	EMITTED COLOR	OPERATING CURRENT (mA)	OPERATING TYP Volts (V)	BRIGHTNESS TYP (mCD) @	mA	LED SERIES USED
SSF-LXH555-2001RD	RED	655	10-25	5	20	SSL-LXA223XX
SSF-LXH555-2101ID	RED	635	10-25	10	20	SSL-LXA223XX
SSF-LXH555-2301GD	GREEN	565	10-25	10	20	SSL-LXA223XX
SSF-LXH555-2401YD	YELLOW	585	10-25	10	20	SSL-LXA223XX

See pages 8-14 for Max. operating limits and operating curves

DIMENSIONS (mm/inch) ±.2mm

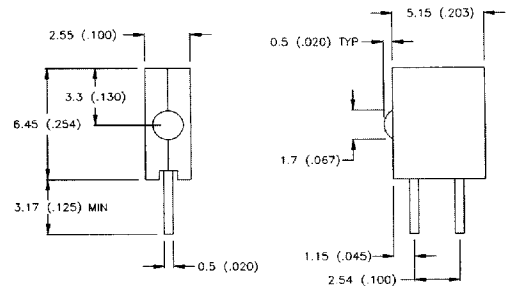

SSF-LXH4RAXX SERIES

P.C. LED T-3 RELAMPABLE

FEATURES		APPLICATIONS		MATERIAL SPECIFICATIONS		
<ul style="list-style-type: none"> • Easy P.C. Installation • LEDs are Removable • Choice of Colors • Blinking Type Option 		<ul style="list-style-type: none"> • P.C. Mount Indicator • Back Lighting Indicator 		<ul style="list-style-type: none"> • Holder: Grey Polycarbonate • Termination: Tinned Copper • Installation: P.C. Mount/Solder 		
LUMEX PART NBR	EMITTED COLOR	OPERATING CURRENT (mA)	OPERATING TYP Volts (V)	BRIGHTNESS TYP (mCD) @	mA	LED SERIES USED
SSF-LXH4RA ID	RED	635	10-25	12	20	SSL-LX3054XX
SSF-LXH4RASRD	RED	660	10-25	100	20	SSL-LX3054XX
SSF-LXH4RAGD	GREEN	565	10-25	18	20	SSL-LX3054XX
SSF-LXH4RAYD	YELLOW	585	10-25	18	20	SSL-LX3054XX
BI-COLOR OPTION						
SSF-LXH4RAHGW	RED/GREEN	695/565	10-25	8/12	20	SSL-LX3054HGW
BLINKING OPTION						
SSF-LXH4RABID	RED	635	10-20	8	9V	SSL-LX3054BID

See pages 8 -14 for Max.operating limits and operating curves

DIMENSIONS (mm/inch) ±.2mm

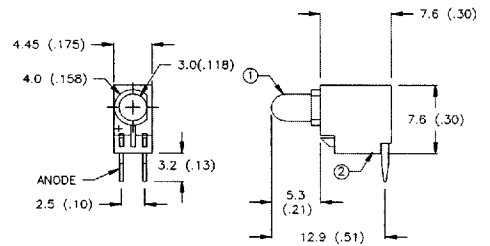

SSI-LXR1612 SERIES

PANEL MOUNT T-3mm LEDS

FEATURES		APPLICATIONS		MATERIAL SPECIFICATIONS		
<ul style="list-style-type: none"> • Easy Panel Installation • Chrome Plated Metal Holder • Choice of Colors • Lead Lengths Optional 		<ul style="list-style-type: none"> • Panel Indicators • Status Indicators • Function Status 		<ul style="list-style-type: none"> • Holder: Chrome Brass • Termination: Pins or Insulated Lead (-150) • Installation: 1/4" Panel Hole 		
LUMEX PART NBR	EMITTED COLOR	OPERATING CURRENT (mA)	OPERATING TYP Volts (V)	BRIGHTNESS TYP (mCD) @	mA	LED SERIES USED
SSI-LXR1612ID/-150	RED	635	10-25	20	20	SSL-LX3054XX
SSI-LXR1612SRD/-150	RED	660	10-25	70	20	SSL-LX3054XX
SSI-LXR161GD/-150	GREEN	565	10-25	20	20	SSL-LX3054XX
SSI-LXR1612YD/-150	YELLOW	585	10-25	20	20	SSL-LX3054XX
BI-COLOR OPTION						
SSI-LXR1612HGW/-150	RED/GREEN	695/565	10-25	7/7	20	SSL-LX3054HGW
FIXED VOLTAGE OPTION AVAILABLE (2.0/5.0/14.0 VOLTS D.C.)						
SSI-LXR1612ID-5V/-150	RED	635	20 max.	12	5V	SSL-LX3054XX5V
SSI-LXR1612GD-5V/-150	GREEN	565	20 max.	12	5V	SSL-LX3054XX5V
SSI-LXR1612YD-5V/-150	YELLOW	585	20 max.	12	5V	SSL-LX3054XX5V
BLINKING OPTION						
SSI-LXR1612BID/-150	RED	635	10-20	8	9V	SSL-LX3054BID

See pages 8 -14 for Max.operating limits and operating curves

DIMENSIONS (mm/inch) ±.2mm

