

## FEATURES AND SPECIFICATIONS

### Features and Benefits

- Contact design prevents damage to contacts during mating and unmating
- Highly reliable contact interface
- Trapezoidal-shaped housing provides polarization
- Lead-in chamfers ensure easy mating alignment
- Fitting nails increase retention to board
- Options include polarizing pegs and pick-and-place cover

### Reference Information

Product Specification: PS-87433-0001  
 Packaging: Tube or embossed tape and reel  
 Mates With: 87436 plug  
 Designed In: Millimeters

### Electrical

Voltage: 125V  
 Current: 1.0A  
 Contact Resistance: 30mΩ max.  
 Dielectric Withstanding Voltage: 500V  
 Insulation Resistance: 1000 MΩ min.

### Physical

Housing: High-temperature thermoplastic, UL 94V-0  
 Contact: Phosphor Bronze  
 Plating: 30μ" (0.76 μm min.) select Gold  
 Temperature: -30 to +85°C

# molex® 1.00mm (.039") Pitch ZYTON™ Stacking System Board-to-Board Receptacle

## 87433

## SMT, Dual Row Vertical Stacking

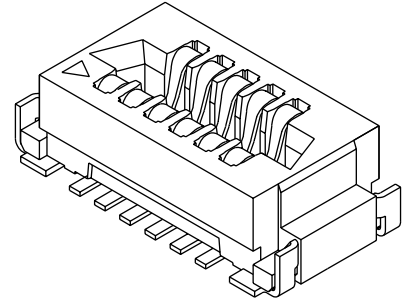

Micro Connectors

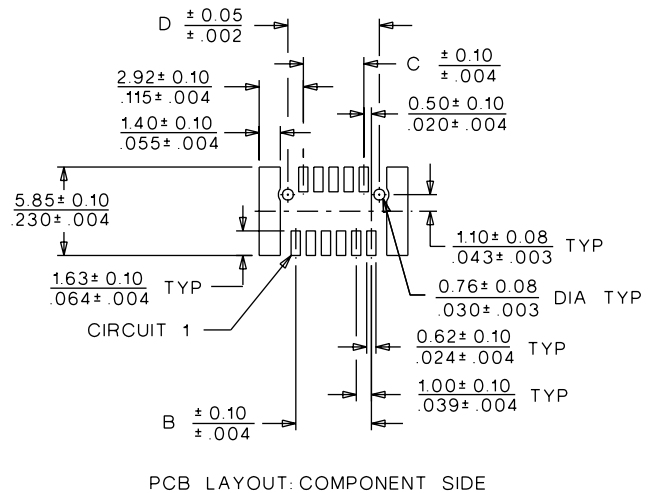
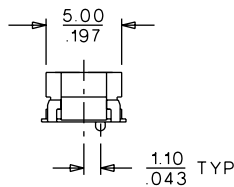
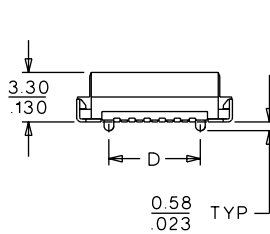
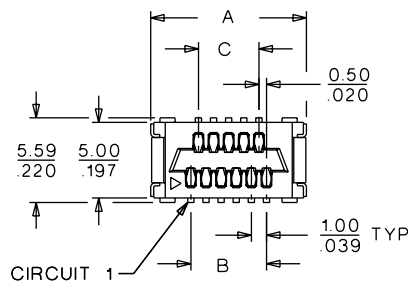

PCB LAYOUT: COMPONENT SIDE

## ORDERING INFORMATION AND DIMENSIONS

Circuits	Order No.	Dimension			
		A	B	C	D
9	87433-05*0	9.30 (.366)	4.00 (.157)	3.00 (.118)	5.05 (.199)
11	87433-06*0	10.30 (.406)	5.00 (.197)	4.00 (.157)	6.05 (.238)
15	87433-08*0	12.30 (.484)	7.00 (.276)	6.00 (.236)	8.05 (.317)
21	87433-11*0	15.30 (.602)	10.00 (.394)	9.00 (.354)	11.05 (.435)
25	87433-13*0	17.30 (.681)	12.00 (.472)	13.00 (.511)	13.05 (.514)
31	87433-16*0	20.30 (.799)	15.00 (.591)	14.00 (.551)	16.05 (.632)
41	87433-21*0	25.30 (.996)	20.00 (.787)	19.00 (.748)	21.05 (.829)
51	87433-26*0	30.30 (1.193)	25.00 (.984)	24.00 (.944)	26.05 (1.026)
69	87433-35*0	39.30 (1.547)	34.00 (1.339)	33.00 (1.299)	35.05 (1.380)

Replace (\*) with options desired

Note: * for Polarizing Pegs, Cover and Packaging Options			
*	Pegs	Cover	Packaging
2	No	No	Tube
3	2	No	Tube
4	No	Yes	Tube
5	2	Yes	Tube
6	No	No	Reel
7	2	No	Reel
8	No	Yes	Reel
9	2	Yes	Reel