

## Miniatur Rundsteckverbinder Serie 682 Miniature circular connectors series 682

## Kurzinformation Brief information

### Winkelsteckverbinder

- Winkelsteckverbinder mit Schraubverriegelung nach IEC 130-9
- Schutzart IP 40<sup>1)</sup>
- Metallgehäuse schirmbar (sehr gute EMV Eigenschaften)
- Winkelstellung bei Metallgehäuse in 4 Stellungen einstellbar
- Kostengünstige Kunststoffausführungen
- Innenliegende Zugentlastung

### Cable Connector

- Angeled connector with screw locking according to IEC 130-9
- Degree of protection IP 40<sup>1)</sup>
- Metal housings with good EMC characteristics
- Angled connector adjustable in 4 angled positions (only metal housings)
- Cost-effective plastic versions
- Internal strain relief

Aufbau des Steckverbinders:  
Construction of the connector:

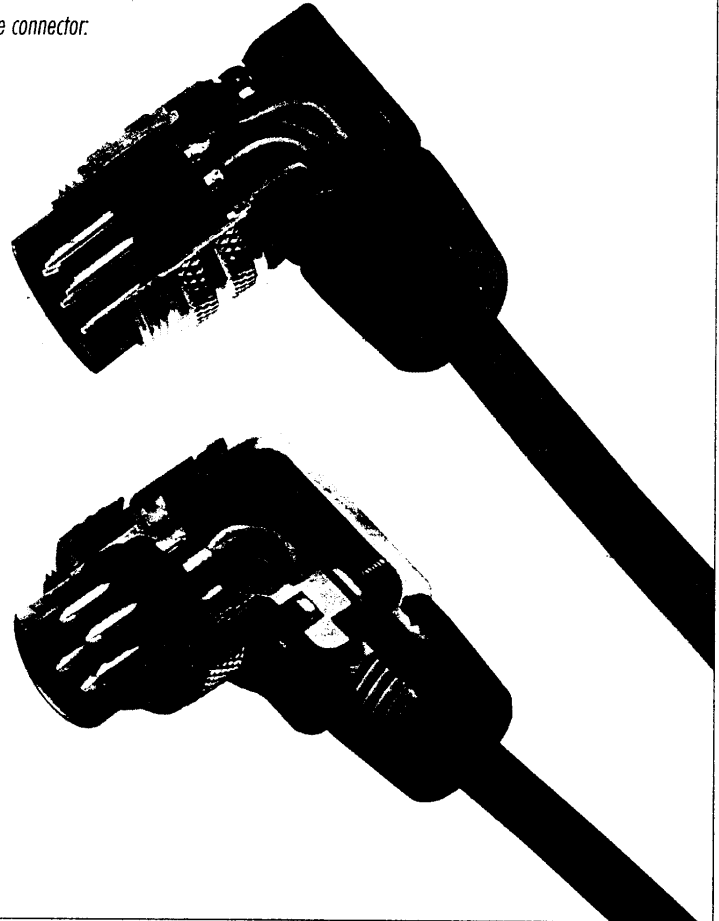

### Flanschsteckverbinder

- 1 Standard: mit Lötanschluss, wird von vorn eingesetzt und von hinten verschraubt.
- 2 Mit Lötanschluss, von vorn verschraubbar, besonders geeignet für vorkonfigurierte Kabelbäume, die nach dem Lötens eingebaut werden.
- 3 Mit Tauchlötanschluss, für den Anschluss auf die Leiterplatte (Abbildung vor dem Einbau in das Gehäuse).
- 4 Mit Tauchlötanschluss nach der Gehäusemontage.

1

2

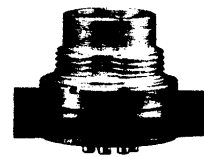
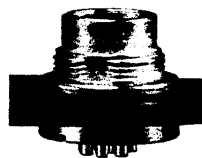

### Chassis sockets

- 1 Standard, with solder termination, mounted from front side and fastened from back side.
- 2 With solder termination, mounted from back side and fastened from front side, especially suited for preassembled cable trees which are mounted after soldering.
- 3 Dip solder termination for connection to PCB (figure: before built into housing).
- 4 Dip solder termination after installation into housing.

3

4

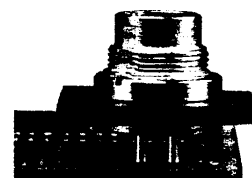
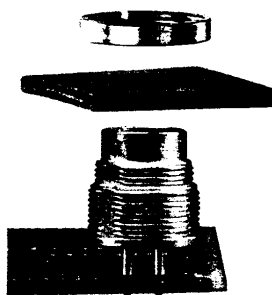

## Miniatur Rundsteckverbinder Serie 682 Miniature circular connectors series 682

## Technische Daten <sup>1)</sup> Specifications <sup>1)</sup>

Allgemeine Kennwerte		General Characteristics														
Polzahl	Number of contacts	2	3 DIN	4	5	5 DIN	6 DIN	7	7 DIN	8 DIN	12	14	16	19	24	
Verriegelung	Locking system	schrauben / screw														
Anschlussart	Termination	löten, tauchlöten / solder, dip solder														
Anschlussquerschnitt in mm <sup>2</sup>	Wire gauge in mm <sup>2</sup>	max. 0,75					max. 0,25					0,14				
Anschlussquerschnitt in AWG	Wire gauge in AWG	max. 20					max. 24					26				
Kabeldurchlass	Cable outlet	4 - 6 mm (.16 - .24) / 6 - 8 mm (.24 - .32)														
Schutzart Gehäuse	Shell protection	IP 40														
Mechanische Lebensdauer	Mechanical operation	> 500 Steckzyklen / > 500 mating cycles														
Obere Grenztemperatur	Upper temperature	+ 85 °C (+ 185 °F)														
Untere Grenztemperatur	Lower temperature	- 40 °C (- 40 °F)														
Gewicht Kabelsteckverbinder	Weight cable connector	~ 14 g (Kunststoffausführung/plastic version), ~ 40 g (Metallausführung/metal version)														
Gewicht Flanschsteckverbinder	Weight socket	~ 12 g														
Elektrische Kennwerte		Electrical Characteristics														
Bemessungsspannung	Rated voltage	250 V			60 V		125 V		60 V							
Bemessungsstoßspannung	Rated impulse voltage	1500 V			500 V		800 V		500 V							
Verschmutzungsgrad	Pollution degree	1														
Überspannungskategorie	Overvoltage categorie	I														
Isolierstoffgruppe	Material group	III														
Prüfstoßspannung	Test voltage	1750 V			550 V		910 V		550 V							
Bemessungsstrom (40 °C)	Rated current (40 °C)	7 A			6 A		5 A		3 A			1 A				
Durchgangswiderstand	Contact resistance	≤ 5 mΩ					≤ 3 mΩ									
Isolationswiderstand	Insulation resistance	≥ 10 <sup>10</sup> Ω														
Werkstoffe		Materials														
Kontaktstift	Pin contact	CuZn (Messing/brass)														
Kontaktbuchse	Socket contact	CuSn (Bronze/bronze)														
Kontaktoberfläche	Contact plating	Ag (Silber/silver) / Au (Gold/gold)					Au (Gold/gold)									
Steckerkörper	Male insert	PBT (UL 94 V-0)														
Buchsenkörper	Female Insert	PBT (UL 94 V-0)														
Gehäuse Kunststoffausführung	Housing plastic version	PA 66 (UL 94 HB)														
Gehäuse Metallausführung	Housing metal version	Zink-Druckguss, vernickelt/zinc diecasting, nickel plated														
Flanschgehäuse	Socket	Zink-Druckguss, vernickelt/zinc diecasting, nickel plated														

## Miniatur Rundsteckverbinder Serie 682 Miniature circular connectors series 682

## Winkelstecker Male angled cable connectors

Bezeichnung — Abbildung Description — Figure	Maßzeichnung Drawing	Polzahl Contacts	Bestell-Nr./Ordering-No.	
			versilberte Kontakte silver plated contacts	vergoldete Kontakte gold plated contacts
Winkelstecker, Kabeldurchlass 4 - 6 mm, Kunststoffausführung Male angled connector cable outlet 4 - 6 mm (.16 - .24 in.), plastic version		2	09-0133-70-02	09-0133-79-02
		3 DIN	09-0135-70-03	09-0135-79-03
		4	09-0137-70-04	09-0137-79-04
		5	09-0139-70-05	09-0139-79-05
		5 (Stereo)	09-0141-70-05	09-0141-79-05
		6 DIN	09-0143-70-06	09-0143-79-06
		7	09-0145-70-07	09-0145-79-07
		7 DIN	09-0177-70-07	—
		8 DIN	09-0153-70-08	09-0153-79-08
		12	—	09-0147-70-12
		14	—	09-0161-70-14
		16	—	09-0185-70-16
19	—	09-0163-70-19		
24	—	—		
Winkelstecker, Kabeldurchlass 6 - 8 mm, Kunststoffausführung Male angled connector cable outlet 6 - 8 mm (.24 - .32 in.), plastic version		2	09-0133-72-02	09-0133-78-02
		3 DIN	09-0135-72-03	09-0135-78-03
		4	09-0137-72-04	09-0137-78-04
		5	09-0139-72-05	09-0139-78-05
		5 (Stereo)	09-0141-72-05	09-0141-78-05
		6 DIN	09-0143-72-06	09-0143-78-06
		7	09-0145-72-07	09-0145-78-07
		7 DIN	—	—
		8 DIN	09-0153-72-08	09-0153-78-08
		12	—	09-0147-72-12
		14	—	09-0161-72-14
		16	—	09-0185-72-16
19	—	09-0163-72-19		
24	—	09-0165-72-24		
Winkelstecker, Kabeldurchlass 4 - 6 mm, Metallausführung Male angled connector cable outlet 4 - 6 mm (.16 - .24 in.), metal version		2	99-0133-10-02	—
		3 DIN	99-0135-10-03	—
		4	99-0137-10-04	—
		5	99-0139-10-05	—
		5 (Stereo)	99-0141-10-05	—
		6 DIN	99-0143-10-06	—
		7	99-0145-10-07	—
		7 DIN	99-0177-10-07	—
		8 DIN	99-0153-10-08	—
		12	—	99-0147-10-12
		14	—	99-0161-10-14
		16	—	—
19	—	99-0163-10-19		
24	—	—		
Winkelstecker, Kabeldurchlass 6 - 8 mm, Metallausführung Male angled connector cable outlet 6 - 8 mm (.24 - .32 in.), metal version		2	99-0133-12-02	—
		3 DIN	99-0135-12-03	—
		4	99-0137-12-04	—
		5	99-0139-12-05	—
		5 (Stereo)	99-0141-12-05	—
		6 DIN	99-0143-12-06	—
		7	99-0145-12-07	—
		7 DIN	—	—
		8 DIN	99-0153-12-08	—
		12	—	99-0147-12-12
		14	—	99-0161-12-14
		16	—	—
19	—	99-0163-12-19		
24	—	99-0165-12-24		

## Miniatur Rundsteckverbinder Serie 682 Miniature circular connectors series 682

## Winkeldosen Female angled cable connectors

Bezeichnung – Abbildung Description – Figure	Maßzeichnung Drawing	Polzahl Contacts	Bestell-Nr./Ordering-No.	
			versilberte Kontakte silver plated contacts	vergoldete Kontakte gold plated contacts
Winkeldose, Kabeldurchlass 4 - 6 mm, Kunststoffausführung Female angled connector cable outlet 4 - 6 mm (.16 - .24 in.), plastic version		2	09-0134-70-02	09-0134-79-02
		3 DIN	09-0136-70-03	09-0136-79-03
		4	09-0138-70-04	09-0138-79-04
		5	09-0140-70-05	09-0140-79-05
		5 (Stereo)	09-0142-70-05	09-0142-79-05
		6 DIN	09-0144-70-06	09-0144-79-06
		7	09-0146-70-07	09-0146-79-07
		7 DIN	09-0178-70-07	-
		8 DIN	09-0154-70-08	09-0154-79-08
		12	-	09-0148-70-12
		14	-	09-0162-70-14
		16	-	09-0186-70-16
Winkeldose, Kabeldurchlass 6 - 8 mm, Kunststoffausführung Female angled connector cable outlet 6 - 8 mm (.24 - .32 in.), plastic version		2	09-0134-72-02	09-0134-78-02
		3 DIN	09-0136-72-03	09-0136-78-03
		4	09-0138-72-04	09-0138-78-04
		5	09-0140-72-05	09-0140-78-05
		5 (Stereo)	09-0142-72-05	09-0142-78-05
		6 DIN	09-0144-72-06	09-0144-78-06
		7	09-0146-72-07	09-0146-78-07
		7 DIN	-	-
		8 DIN	09-0154-72-08	09-0154-78-08
		12	-	09-0148-72-12
		14	-	09-0162-72-14
		16	-	09-0186-72-16
Winkeldose, Kabeldurchlass 4 - 6 mm, Metallausführung Female angled connector cable outlet 4 - 6 mm (.16 - .24 in.), metal version		2	99-0134-10-02	-
		3 DIN	99-0136-10-03	-
		4	99-0138-10-04	-
		5	99-0140-10-05	-
		5 (Stereo)	99-0142-10-05	-
		6 DIN	99-0144-10-06	-
		7	99-0146-10-07	-
		7 DIN	-	-
		8 DIN	09-0154-10-08	-
		12	-	99-0148-10-12
		14	-	99-0162-10-14
		16	-	-
Winkeldose, Kabeldurchlass 6 - 8 mm, Metallausführung Female angled connector cable outlet 6 - 8 mm (.24 - .32 in.), metal version		2	99-0134-12-02	-
		3 DIN	99-0136-12-03	-
		4	99-0138-12-04	-
		5	99-0140-12-05	-
		5 (Stereo)	99-0142-12-05	-
		6 DIN	99-0144-12-06	-
		7	99-0146-12-07	-
		7 DIN	-	-
		8 DIN	99-0154-12-08	-
		12	-	99-0148-12-12
		14	-	99-0162-12-14
		16	-	-

<b>Miniatur Rundsteckverbinder Serie 682</b> <i>Miniature circular connectors series 682</i>	<b>Flanschstecker</b> <i>Male sockets</i>
---	--

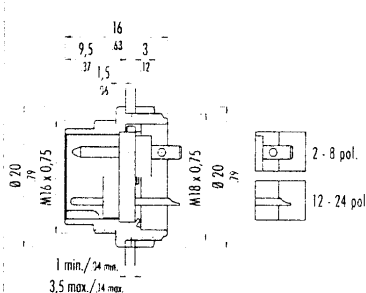
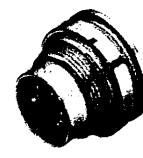
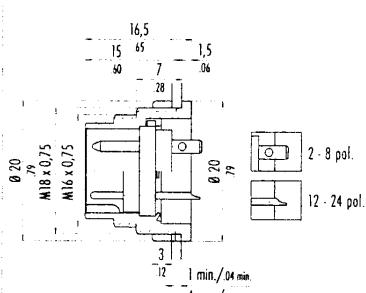
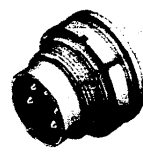
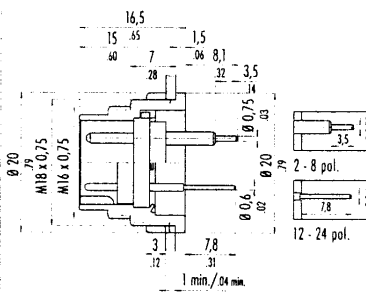
Bezeichnung – Abbildung <i>Description – Figure</i>	Maßzeichnung <i>Drawing</i>	Polzahl <i>Contacts</i>	Bestell-Nr./Ordering-No.	
			versilberte Kontakte <i>silver plated contacts</i>	vergoldete Kontakte <i>gold plated contacts</i>
Flanschstecker, löten <i>Male socket, solder</i> 		2	09-0303-00-02	09-0303-09-02
		3 DIN	09-0307-00-03	09-0307-09-03
		4	09-0311-00-04	09-0311-09-04
		5	09-0315-00-05	09-0315-09-05
		5 (Stereo)	09-0319-00-05	09-0319-09-05
		6 DIN	09-0323-00-06	09-0323-09-06
		7	09-0327-00-07	09-0327-09-07
		7 DIN	09-1583-00-07	—
		8 DIN	09-0473-00-08	09-0473-09-08
		12	—	09-0331-00-12
		14	—	09-0053-00-14
		16	—	09-0339-00-16
		19	—	09-0363-00-19
		24	—	09-0197-00-24
Flanschstecker, löten, von vorne verschraubbar <i>Male socket, solder, front fastened</i> 		2	09-0303-80-02	09-0303-89-02
		3 DIN	09-0307-80-03	09-0307-89-03
		4	09-0311-80-04	09-0311-89-04
		5	09-0315-80-05	09-0315-89-05
		5 (Stereo)	09-0319-80-05	09-0319-89-05
		6 DIN	09-0323-80-06	09-0323-89-06
		7	09-0327-80-07	09-0327-89-07
		7 DIN	—	—
		8 DIN	09-0473-80-08	09-0473-89-08
		12	—	09-0331-80-12
		14	—	09-0053-80-14
		16	—	09-0339-80-16
		19	—	09-0363-80-19
		24	—	09-0197-80-24
Flanschstecker, tauchlöten, von vorne verschraubbar <i>Male socket, dip solder, front fastened</i> 		2	09-0303-90-02	09-0303-99-02
		3 DIN	09-0307-90-03	09-0307-99-03
		4	09-0311-90-04	09-0311-99-04
		5	09-0315-90-05	09-0315-99-05
		5 (Stereo)	09-0319-90-05	09-0319-99-05
		6 DIN	09-0323-90-06	09-0323-99-06
		7	09-0327-90-07	09-0327-99-07
		7 DIN	—	—
		8 DIN	09-0473-90-08	09-0473-99-08
		12	—	09-0331-90-12
		14	—	09-0053-90-14
		16	—	09-0339-90-16
		19	—	09-0363-90-19
		24	—	09-0197-90-24

682

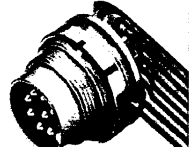
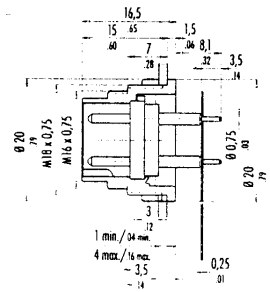
Flanschstecker mit Flexplatte, von vorne verschraubbar <i>Male socket with flex board, front fastened</i> 		7	09-0327-65-07	
		8	09-0473-65-08	
		12		09-0331-65-12
		12		09-0331-66-12

Weitere Maße siehe Seite Z3.  
 Additional dimensions see page Z3

## Miniatur Rundsteckverbinder Serie 682 Miniature circular connectors series 682

## Flanschdosen Female sockets

Bezeichnung – Abbildung Description – Figure	Maßzeichnung Drawing	Polzahl Contacts	Bestell-Nr./Ordering-No.	
			versilberte Kontakte silver plated contacts	vergoldete Kontakte gold plated contacts
Flanschdose, löten Female socket, solder		2	09-0304-00-02	09-0304-09-02
		3 DIN	09-0308-00-03	09-0308-09-03
		4	09-0312-00-04	09-0312-09-04
		5	09-0316-00-05	09-0316-09-05
		5 (Stereo)	09-0320-00-05	09-0320-09-05
		6 DIN	09-0324-00-06	09-0324-09-06
		7	09-0328-00-07	09-0328-09-07
		7 DIN	09-1584-00-07	—
		8 DIN	09-0474-00-08	09-0474-09-08
		12	—	09-0332-00-12
		14	—	09-0054-00-14
		16	—	09-0340-00-16
		19	—	09-0364-00-19
		24	—	09-0198-00-24
Flanschdose, löten, von vorne verschraubbar Female socket, solder, front fastened		2	09-0304-80-02	09-0304-89-02
		3 DIN	09-0308-80-03	09-0308-89-03
		4	09-0312-80-04	09-0312-89-04
		5	09-0316-80-05	09-0316-89-05
		5 (Stereo)	09-0320-80-05	09-0320-89-05
		6 DIN	09-0324-80-06	09-0324-89-06
		7	09-0328-80-07	09-0328-89-07
		7 DIN	—	—
		8 DIN	09-0474-80-08	09-0474-89-08
		12	—	09-0332-80-12
		14	—	09-0054-80-14
		16	—	09-0340-80-16
		19	—	09-0364-80-19
		24	—	09-0198-80-24
Flanschdose, tauchlöten, von vorne verschraubbar Female socket, dip solder, front fastened		2	09-0304-90-02	09-0304-99-02
		3 DIN	09-0308-90-03	09-0308-99-03
		4	09-0312-90-04	09-0312-99-04
		5	09-0316-90-05	09-0316-99-05
		5 (Stereo)	09-0320-90-05	09-0320-99-05
		6 DIN	09-0324-90-06	09-0324-99-06
		7	09-0328-90-07	09-0328-99-07
		7 DIN	—	—
		8 DIN	09-0474-90-08	09-0474-99-08
		12	—	09-0332-90-12
		14	—	09-0054-90-14
		16	—	09-0340-90-16
		19	—	09-0364-90-19
		24	—	09-0198-90-24
Flanschdose mit Flexplatte, von vorne verschraubbar Female socket with flex board, front fastened		7	09-0328-65-07	—
		8	09-0474-65-08	—
		12	—	09-0332-65-12
		12	—	09-0332-66-12

Weitere Maße siehe Seite Z3.  
Additional dimensions see page Z3.

## Miniatur Rundsteckverbinder Serie 682 Miniature circular connectors series 682

## Polbilder Contact arrangements

Polbilder mit Sicht auf die Lötanschlusseite der Stifteinsätze  
Contact arrangements with view on the solder termination side of male inserts

x-y Koordinaten  
x-y Coordinates

2 pol

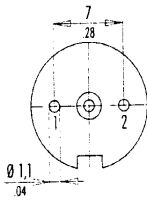

3 pol (DIN 41524)

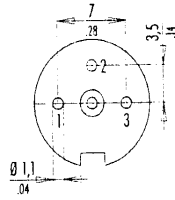

4 pol

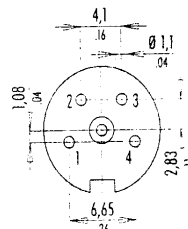

12 pol

	X	Y
A	-0,41	-3,45
B	2,29	-3,61
C	4,10	-1,21
D	3,20	1,34
E	2,71	3,59
F	0,41	3,45
G	-2,29	3,61
H	-4,10	1,21
J	-3,20	-1,34
K	-2,71	-3,59
L	-2,00	-1,51
M	-2,00	-1,51

5 pol

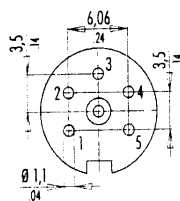

5 pol stereo (DIN 41524)

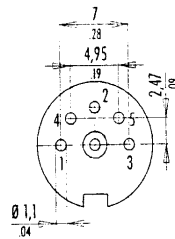

6 pol (DIN 45322)

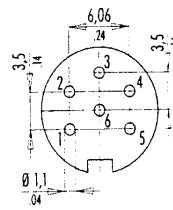

14 pol

	X	Y		X	Y
A	2,50	-4,00	T	-2,40	-0,95
C	4,25	0,00	U	-0,95	-2,40
E	2,30	4,00			
G	-2,30	4,00			
J	-4,25	0,00			
L	-2,50	-4,00			
M	0,95	2,40			
N	2,40	-0,95			
O	2,40	0,95			
P	0,95	2,40			
R	-0,95	2,40			
S	-2,40	0,95			

7 pol

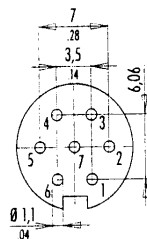

7 pol (DIN 45329)

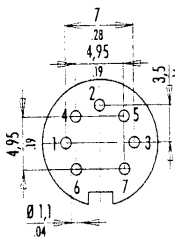

8 pol (DIN 45326)

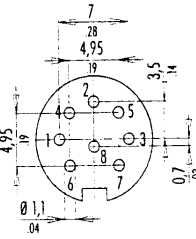

16 pol

	X	Y		X	Y
A	2,50	-4,00	N	2,45	-0,80
B	4,00	-2,25	O	1,50	2,10
C	4,25	0,00	P	-1,50	2,10
D	4,00	2,40	R	-2,45	-0,80
E	2,30	4,00			
F	0,00	4,25			
G	-2,30	4,00			
H	-4,00	2,40			
I	-4,25	0,00			
K	-4,00	-2,25			
L	-2,50	-4,00			
M	0,00	-2,60			

12 pol

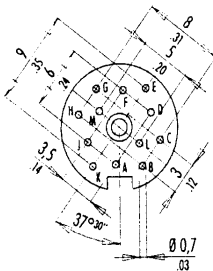

14 pol

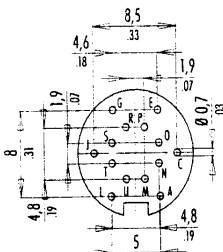

16 pol

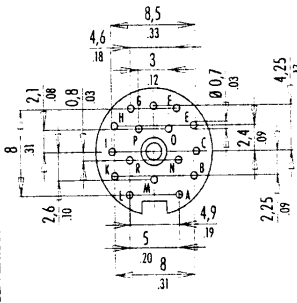

19 pol

	X	Y		X	Y
A	2,50	-4,00	N	2,40	-0,95
B	4,00	-2,25	O	2,40	0,95
C	4,25	0,00	P	0,95	2,40
D	4,00	2,40	R	-0,95	2,40
E	2,30	4,00	S	-2,40	0,95
F	0,00	4,25	T	-2,40	-0,95
G	-2,30	4,00	U	-0,95	-2,40
H	-4,00	2,40			
I	-4,25	0,00			
K	-4,00	-2,25			
L	-2,50	-4,00			
M	0,95	-2,40			

19 pol

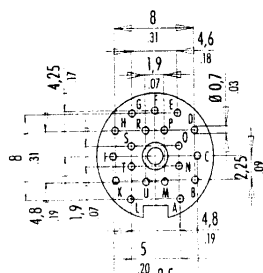

24 pol

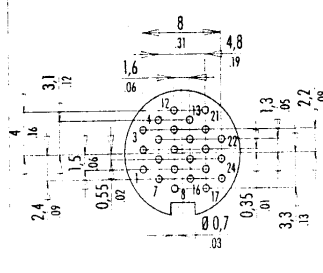

Montageausschnitt  
Panel cut out

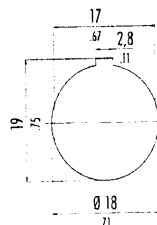

24 pol

	X	Y		X	Y
Y			13	0,80	3,10
1	-4,00	-1,50	14	0,80	1,30
2	-4,00	0,35	15	0,80	-0,55
3	-4,00	2,20	16	0,80	-2,40
4	-2,40	3,10	17	2,40	-3,30
5	-2,40	1,30	18	2,40	-1,50
6	-2,40	-0,55	19	2,40	0,35
7	-2,40	-2,40	20	2,40	2,20
8	-0,80	-3,30	21	2,40	4,00
9	-0,80	-1,50	22	4,00	1,30
10	-0,80	0,35	23	4,00	-0,55
11	-0,80	2,20	24	4,00	-2,40

## Miniatur Rundsteckverbinder Serie 682 Miniature circular connectors series 682

## Einzelteildarstellung Component part drawings

Winkelstecker  
Kunststoffausführung  
Angled connector  
plastic version

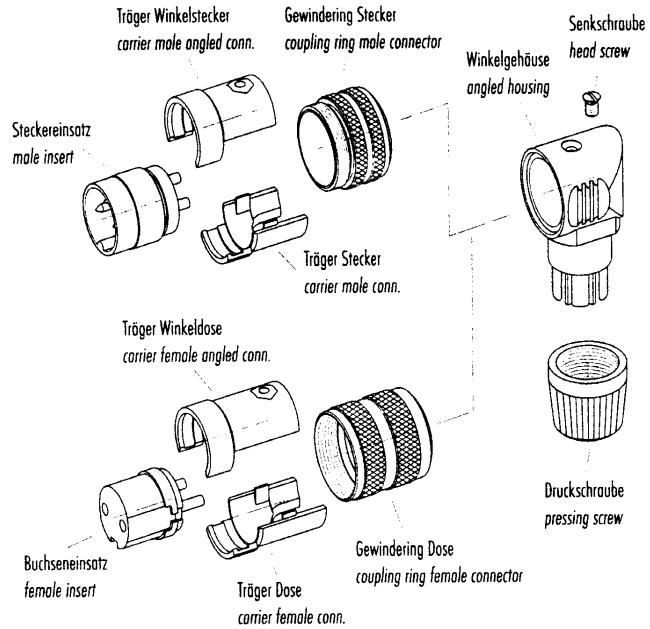

Winkelstecker  
Metallausführung  
Angled connector  
metal version

