

2-Position ATO® Style Fuse and Circuit Breaker Module

RoHS

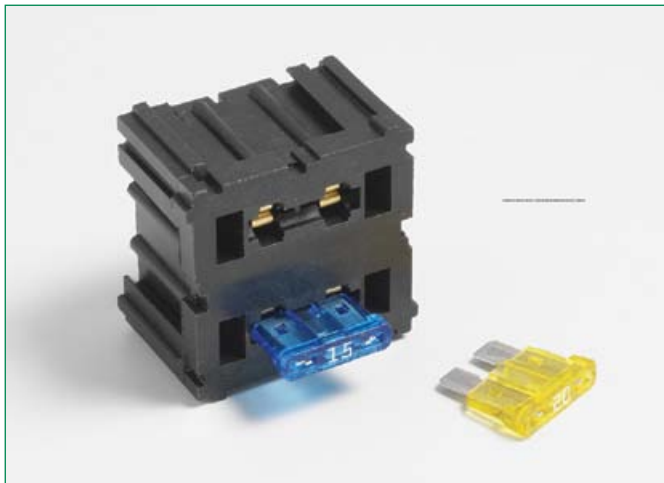

Dimensions in mm / Maße in mm

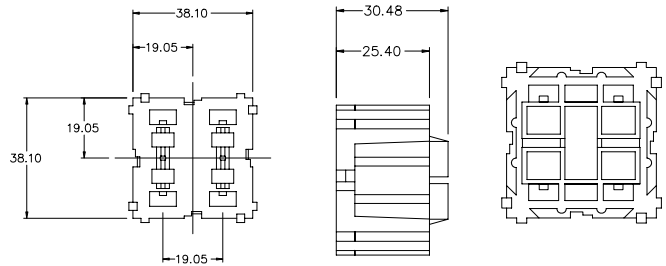

Part Number / Artikel-Nr.	Max. Current Indication Maximalstrom ca.	Terminals / Kontakte (see according section) (siehe entsprechendes Kapitel)	Terminal Loks / Kontaktverriegelungen (see according section) (siehe entsprechendes Kapitel)
03540501Z (40 pcs.)	60A	Type 1 or 7	Type 4, 5 or 6

4-Position ATO® Style Fuse and Circuit Breaker Module

RoHS

Fuse Modules



Dimensions in mm / Maße in mm

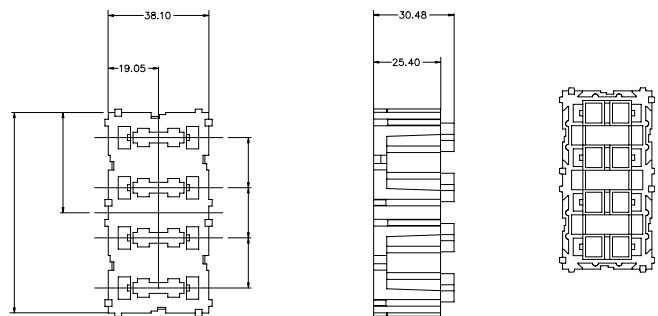

Part number / Artikel-Nr.	Max. current. Indication Maximalstrom ca.	Terminals / Kontakte (see according section) (siehe entsprechendes Kapitel)	Terminal loks / Kontaktverriegelungen (see according section) (siehe entsprechendes Kapitel)
03540502Z (20 pcs.)	120A	Type 1 or 7	Type 4, 5, 6 or 7