



# TAI-SAW TECHNOLOGY CO., LTD.

No. 3, Industrial 2nd Rd., Ping-Chen Industrial District,  
Taoyuan, 324, Taiwan, R.O.C.

TEL: 886-3-4690038 FAX: 886-3-4697532

E-mail: [tstsales@mail.taisaw.com](mailto:tstsales@mail.taisaw.com) Web: [www.taisaw.com](http://www.taisaw.com)

## Approval Sheet For Product Specification

Issued Date:

Product Name: SAW Filter 180.175 MHz SMD 5X5 mm

TST Parts No.: TA0574A

Customer Parts No.: \_\_\_\_\_

Company: _____
Division: _____
Approved by : _____
Date: _____

Checked by: \_\_\_\_\_ Asin Lin

Approval by: \_\_\_\_\_ Francis Chen

Date: \_\_\_\_\_ 2006/5/12



# TAI-SAW TECHNOLOGY CO., LTD.

No. 3, Industrial 2nd Rd., Ping-Chen Industrial District,  
Taoyuan, 324, Taiwan, R.O.C.

TEL: 886-3-4690038 FAX: 886-3-4697532

E-mail: [tstsales@mail.taisaw.com](mailto:tstsales@mail.taisaw.com) Web: [www.taisaw.com](http://www.taisaw.com)

## SAW Filter 180.175 MHz

MODEL NO.: TA0574A

REV. NO.: 1

### A. MAXIMUM RATING:

1. Input Power Level: 10 dB<sub>m</sub>
2. DC voltage: 5 V
3. Operating Temperature: -25°C to +85°C
4. Storage Temperature: -40°C to +85°C

RoHS Compliant  
Lead free  
Lead-free soldering

### B. ELECTRICAL CHARACTERISTICS:

Item		Specification			
		Unit	Min.	Typ.	Max.
Center Frequency	F <sub>c</sub>	MHz	-	180.175	-
Insertion Loss	IL <sub>min</sub> (reference level)	dB	-	1.55	2.8
Bandwidth	BW <sub>-3dB</sub>	MHz	6	8.9	-
Absolute Attenuation(reference to IL <sub>min</sub> dB)					
F <sub>c</sub> -50 ~ F <sub>c</sub> -30	MHz	dB	42	55	-
F <sub>c</sub> -30 ~ F <sub>c</sub> -15	MHz	dB	36	52	-
F <sub>c</sub> +30 ~ F <sub>c</sub> +100	MHz	dB	42	46	-
Source impedance	Z <sub>s</sub>	Ω	-	50	-
Load impedance	Z <sub>L</sub>	Ω	-	50	-

Note: IL<sub>min</sub> is the minimum of the pass band attenuation. The center frequency F<sub>c</sub> is the mean value of the upper and lower frequencies at the 3dB filter attenuation level relative to the IL<sub>min</sub>.

### C. MEASUREMENT CIRCUIT:

HP Network analyzer

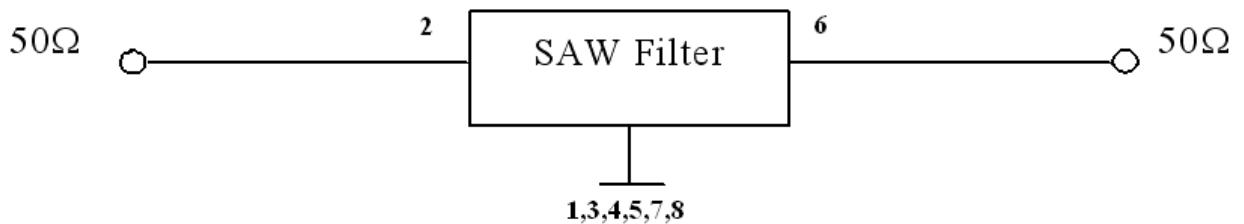

### D. Frequency Characteristics :

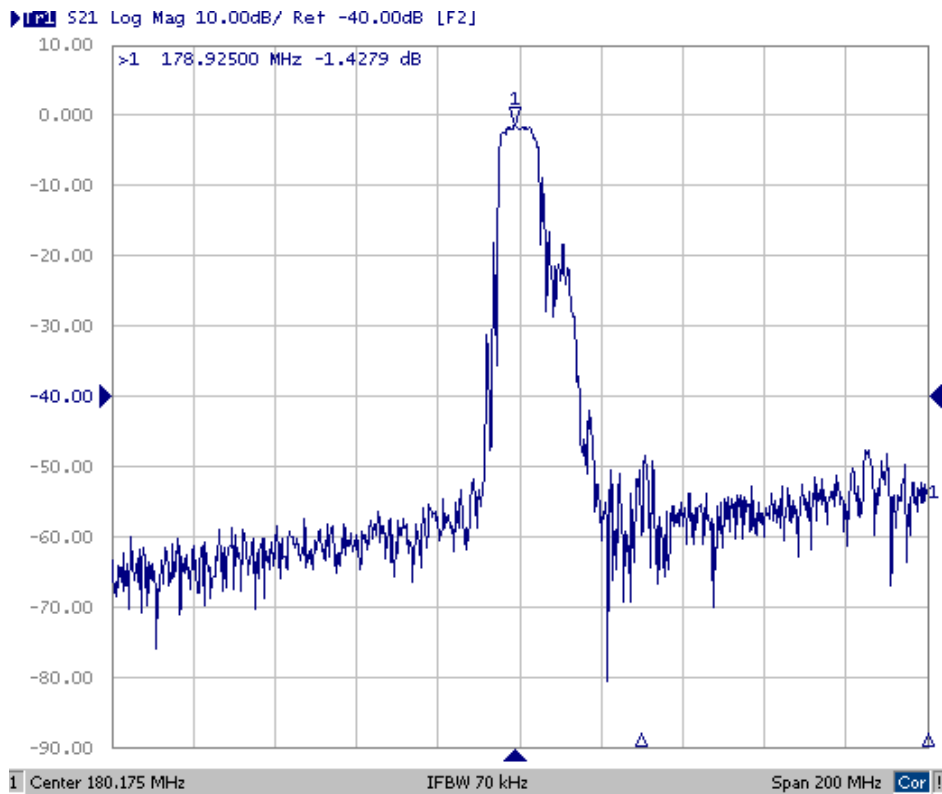
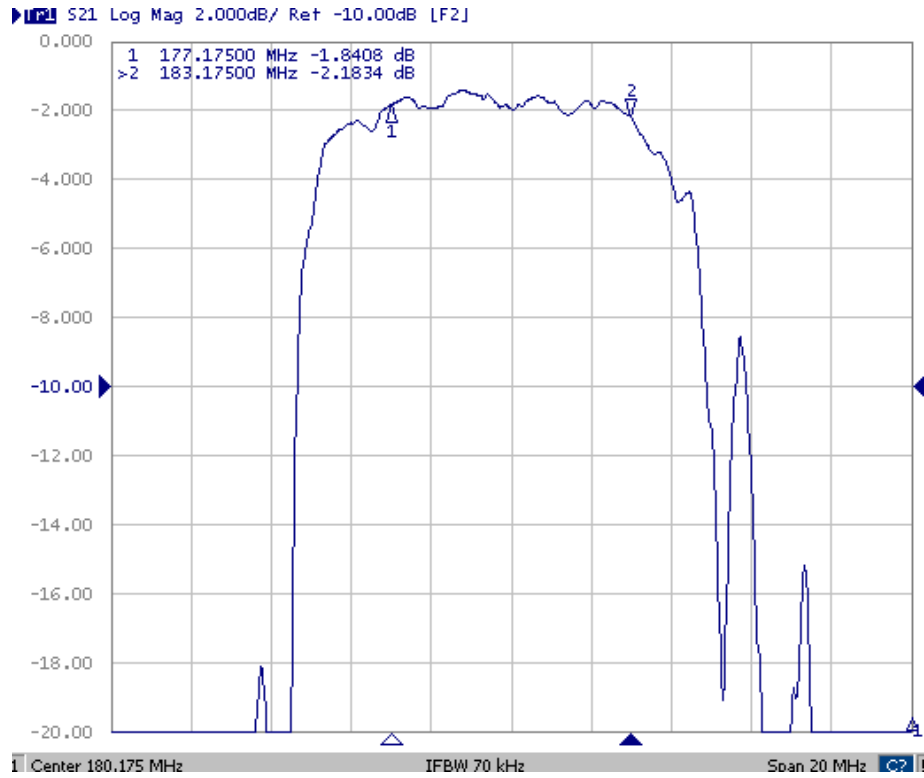

**E.OUTLINE DRAWING:**

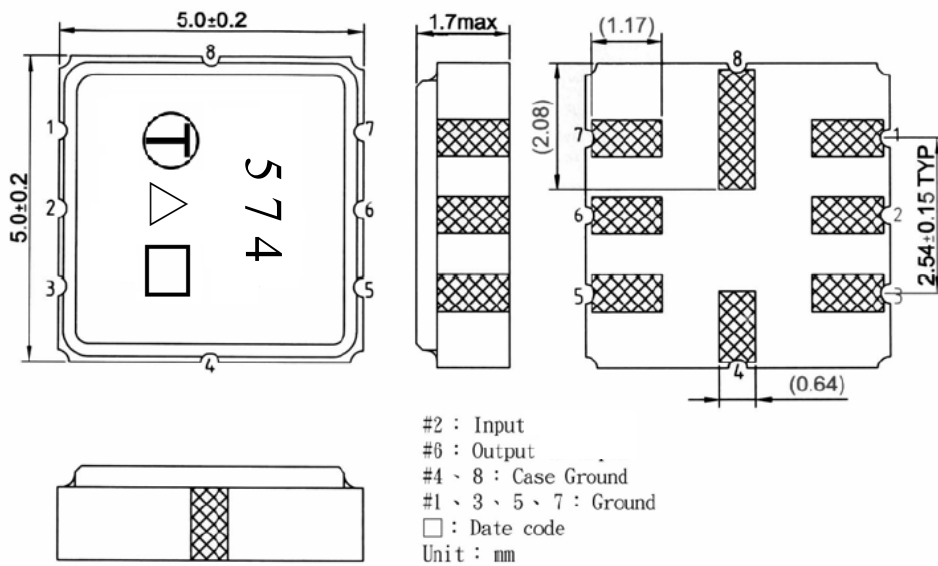

#2 : Input  
 #6 : Output  
 #4、8 : Case Ground  
 #1、3、5、7 : Ground  
 □ : Date code  
 Unit : mm

- Date code: Provided by planer each year
- △ Product Year Code

Year	2005 2009	2006 2010	2007 2011	2008 2012
Product Code	A	a	<u>A</u>	<u>a</u>

**F.PCB FOOTPRINT:**

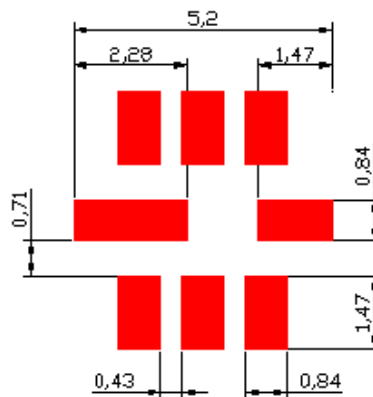

## G. PACKING:

### 1. REEL DIMENSION

7"=1000

13"=3000

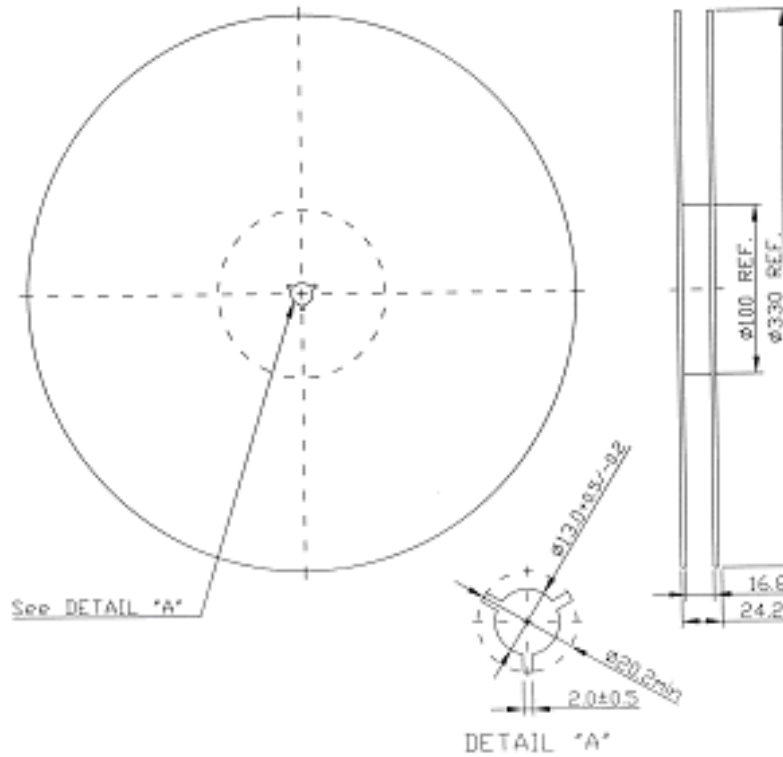

### 2. TAPE DIMENSION

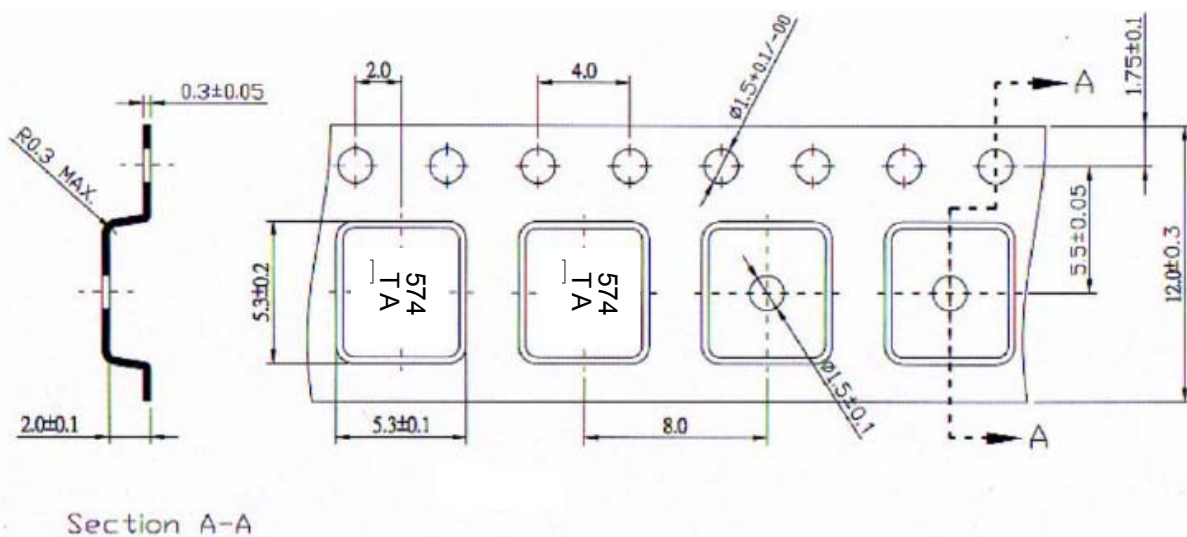

Direction of Feed

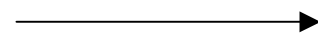

### H.RECOMMENDED REFLOW PROFILE:

