

DISCON INDUSTRIES, INC.

DIGICATOR®

MODEL 5700

BCD TO 7 LINE DECODER/DRIVER WITH MEMORY

MODEL 5701

BCD TO 7 LINE DECODER/DRIVER

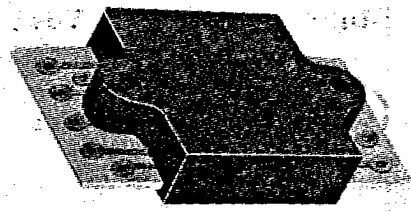

Chassis Mounted
PC Card &
Solder Pads

MODEL 5702

BCD TO 7 LINE DECODER/DRIVER WITH MEMORY

MODEL 5703

BCD TO 7 LINE DECODER/DRIVER



Chassis Mounted
Integral Leads

MODEL 5704

BCD TO 7 LINE DECODER/DRIVER WITH MEMORY

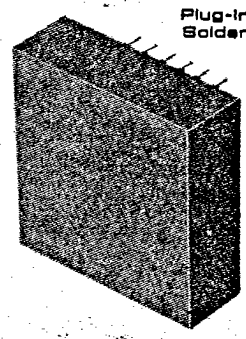

Plug-in with
Solder Pins

DCDR-3X

DIGIGATOR[®]

8421 BCD to 7 Line Decoder/Drivers

PART NUMBER	MODULE TYPE	READOUT USED WITH	MEMORY	INPUT CONNECTION	OUTPUT CONNECTION
5511	Chassis Mounted	Universal	No	12" wire lead	12" wire lead
5518	Chassis Mounted	Universal	No	Pin type	12" wire lead
5517	Chassis Mounted	Universal	Yes	12" wire lead	12" wire lead
5519	Chassis Mounted	Universal	Yes	Pin type	12" wire lead
5515	Plug-in	Series 13	No	Turret termin.	Readout socket
5527	Plug-in	Series 16	No	Turret termin.	Readout socket
5526	Plug-in	Series 13	No	12" wire lead	Readout socket
5533	Plug-in	Series 16	No	12" wire lead	Readout socket
5520	Plug-in	Series 13	No	Pin type	Readout socket
5529	Plug-in	Series 16	No	Pin type	Readout socket
5516	Plug-in	Series 13	Yes	12" wire lead	Readout socket
5528	Plug-in	Series 16	Yes	12" wire lead	Readout socket
5521	Plug-in	Series 13	Yes	Pin type	Readout socket
5530	Plug-in	Series 16	Yes	Pin type	Readout socket

Decimal to 7-Line Decoder/Drivers

5522	Chassis mounted	Universal	12" wire leads	12" wire leads
5523	Chassis mounted	Universal	Pin type	12" wire leads
5524	Plug-in	Series 13	12" wire leads	Readout socket
5531	Plug-in	Series 16	12" wire leads	Readout socket
5525	Plug-in	Series 13	Pin type	Readout socket
5532	Plug-in	Series 16	Pin type	Readout socket

DCDR-4X

DECODER/DRIVERS FOR INCANDESCENT READOUTS

<u>Model</u>	<u>Package Type</u>	<u>Description</u>
5900	16-pin DIP	BCD to 7-segment decoder/driver 30 V, 40 mA per segment
5916	16-pin DIP	BCD to 7-segment, high power decoder/driver with quad latch
5918	20-pin DIP	BCD to 7-segment, high power decoder/driver with decade counter and quad latch
5970	16-pin DIP	Hexadecimal decoder/driver, de- codes 0-9 and A-F for 9-segment readout, 40V, 120mA

MATING DECODER/DRIVERS FOR DIGICATOR READOUTS

5920	Plug-in Module	Mates with Discon Digicator, Series 20
5920-1	Plug-in Module	Mates with Discon Digicator, Series 20
5925-1	Plug-in Module	Decoder/driver with quad latch; mates with Discon Digicator, Series 20
5950	Plug-in Module	Decoder/Driver with decade counter; mates with Discon Digicator, Series 20
5990	Plug-in Module	Hexadecimal decoder/driver, mates with Discon Digicator, Series 20
3392	Plug-in Module	Hexadecimal decoder/driver, mates with Discon Digicator, Series 30
5515	Plug-in Module	Mates with Discon Digicator, Series 13
5822	Plug-in Module	Mates with Discon Digicator, Series 16
5832	Plug-in Module	Decoder/driver with quad latch, mates with Discon Digicator, Series 16
5720	Plug-in Module	Mates with Digicator Series 20, decoder/driver 4 line to 7 line without memory
5722	Plug-in Module	Mates with Digicator Series 20, Decoder/driver, 4 line to 7 line
5725	Plug-in Module	Mates with Digicator Series 20, Decoder Driver, 4 line to 7 line with memory

DISCON INDUSTRIES, INC.

61 S.W. 5TH COURT • POMPANO BEACH, FLORIDA 33060

• TELEPHONES: 305 / 782-7424, 782-7425

DCDR-5X