

PNP/NPN Silicon Power Transistor

(Pb) Lead(Pb)-Free

FEATURES:

- * Medium Power Complementary silicon transistors
- * TIP120,121,122 Darlington TRANSISTOR (NPN)
- * TIP125,126,127 Darlington TRANSISTOR (PNP)

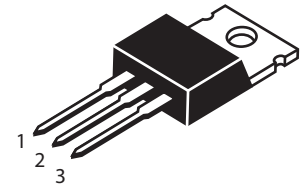

1. BASE
2. COLLECTOR
3. EMITTER

TO-220

MAXIMUM RATINGS ($T_A=25^\circ\text{C}$ unless otherwise noted)

Symbol	Parameter	TIP120 TIP125	TIP121 TIP126	TIP122 TIP127	Units
V_{CBO}	Collector-Base Voltage	60	80	100	V
V_{CEO}	Collector-Emitter Voltage	60	80	100	V
V_{EBO}	Emitter-Base Voltage	5			V
I_C	Collector Current -Continuous	5			A
P_C	Collector Power Dissipation	2			W
$R_{\theta JA}$	Thermal Resistance Junction to Ambient	62.5			$^\circ\text{C}/\text{W}$
$R_{\theta JC}$	Thermal Resistance Junction to Case	1.92			$^\circ\text{C}/\text{W}$
T_J	Junction Temperature	150			$^\circ\text{C}$
T_{stg}	Storage Temperature	-55-150			$^\circ\text{C}$

ELECTRICAL CHARACTERISTICS ($T_{amb}=25^\circ\text{C}$ unless otherwise specified)

Parameter	Symbol	Test conditions	MIN	MAX	UNIT			
Collector-base breakdown voltage	$V_{(BR)CBO}$	$I_C=1\text{mA}, I_E=0$	TIP120,TIP125	60	V			
			TIP121,TIP126	80				
			TIP122,TIP127	100				
Collector-emitter breakdown voltage	$V_{CEO(SUS)}$	$I_C=30\text{mA}, I_B=0$	TIP120,TIP125	60	V			
			TIP121,TIP126	80				
			TIP122,TIP127	100				
Collector cut-off current	I_{CBO}	$V_{CB}=60\text{V}, I_E=0$ $V_{CB}=80\text{V}, I_E=0$ $V_{CB}=100\text{V}, I_E=0$		0.2	mA			
			Collector cut-off current	I_{CEO}		$V_{CE}=30\text{V}, I_B=0$ $V_{CE}=40\text{V}, I_B=0$ $V_{CE}=50\text{V}, I_B=0$	0.5	mA
							Emitter cut-off current	
DC current gain	$h_{FE(1)}$	$V_{CE}=3\text{V}, I_C=0.5\text{A}$	1000					
	$h_{FE(2)}$	$V_{CE}=3\text{V}, I_C=3\text{A}$	1000					
Collector-emitter saturation voltage	$V_{CE(sat)}$	$I_C=3\text{A}, I_B=12\text{mA}$ $I_C=5\text{A}, I_B=20\text{mA}$		2 4	V			
Base-emitter voltage	V_{BE}	$V_{CE}=3\text{V}, I_C=3\text{A}$		2.5	V			
Output Capacitance	C_{ob}	$V_{CB}=10\text{V}, I_E=0\text{A}$ $f = 0.1\text{MHz}$	TIP125,TIP126,TIP127	300	pF			
			TIP120,TIP121,TIP122	200				

Typical Characteristics

TIP120,121,122,125,126,127

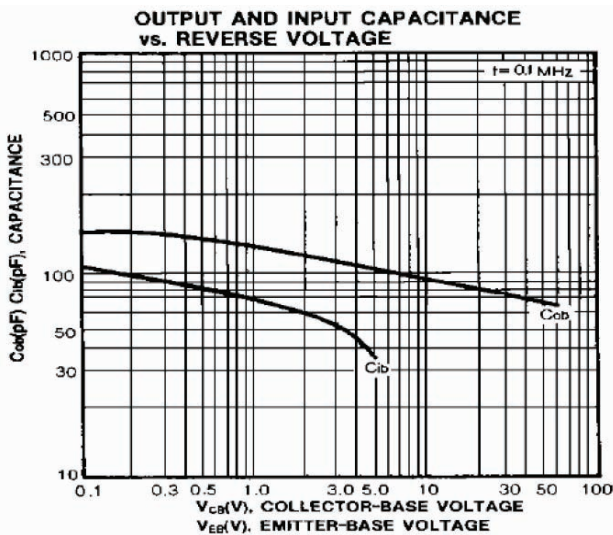
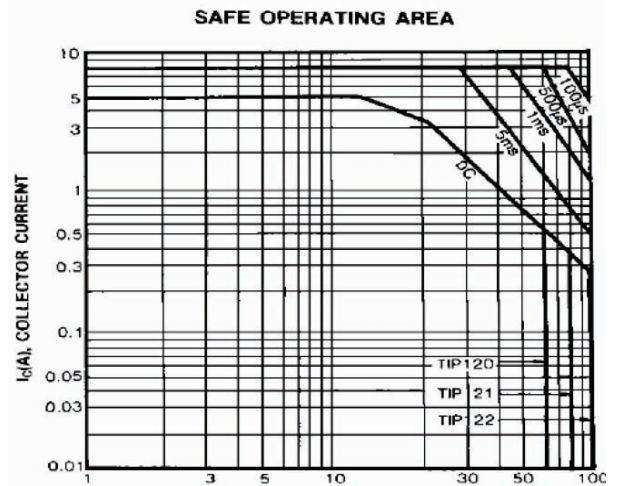
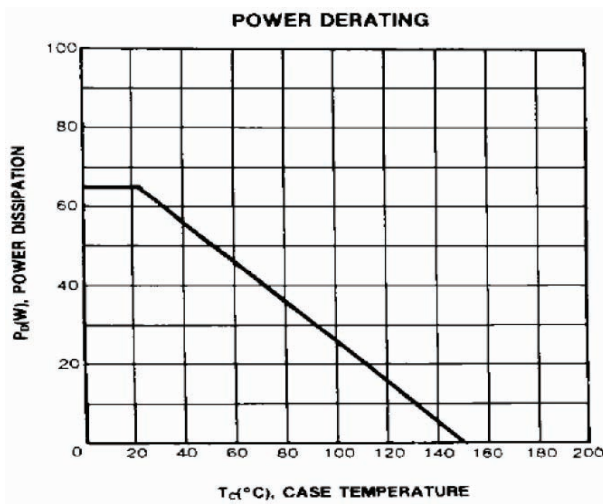
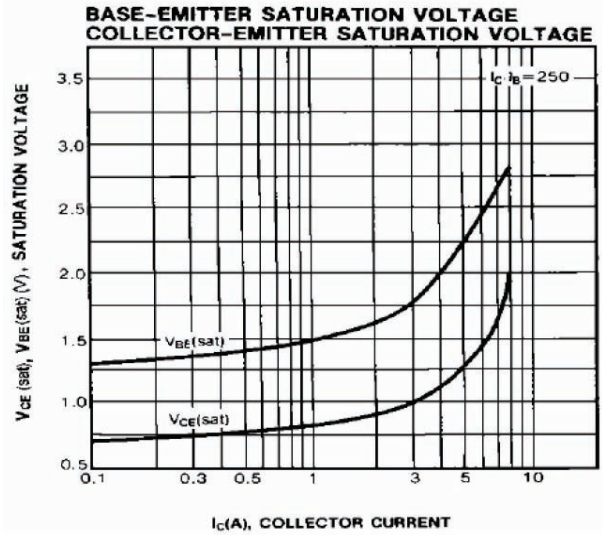
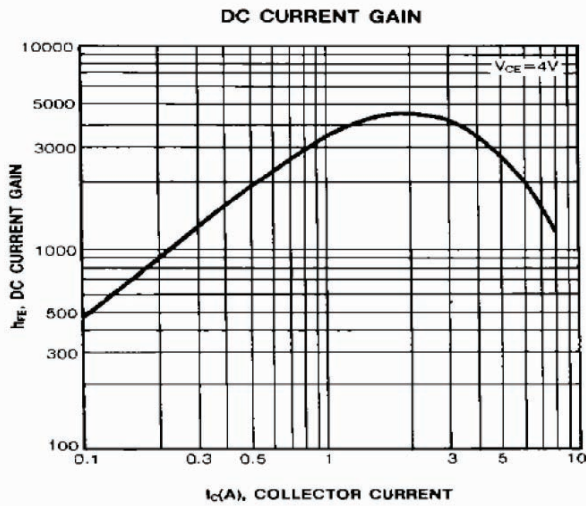

TO-220 Outline Dimensions

unit:mm

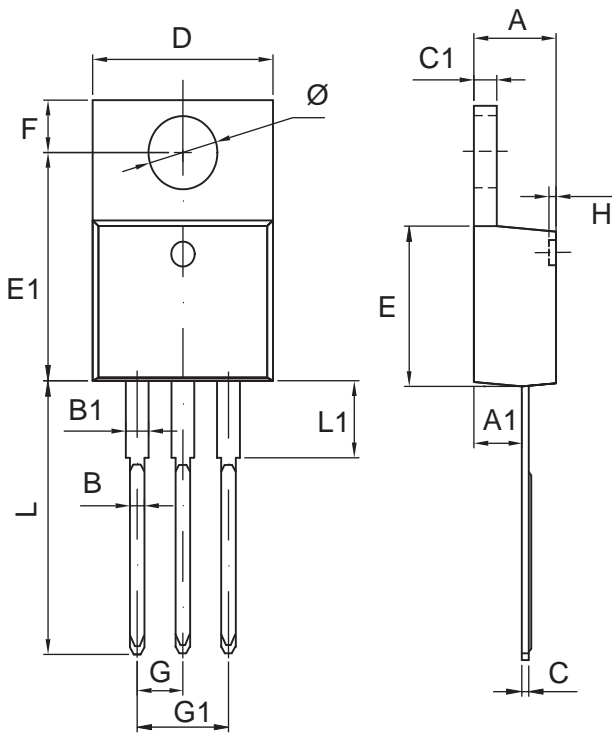

TO-220		
Dim	Min	Max
A	4.47	4.67
A1	2.52	2.82
B	0.71	0.91
B1	1.17	1.37
C	0.31	0.53
C1	1.17	1.37
D	10.01	10.31
E	8.50	8.90
E1	12.06	12.446
G	2.54 TYP	
G1	4.98	5.18
F	2.59	2.89
H	0.00	0.30
L	13.4	13.8
L1	3.56	3.96
Φ	3.73	3.93