

PLEASE CHECK WWW.MOLEX.COM FOR LATEST PART INFORMATION

Part Number: [0475976001](#)
Status: **Active**
Description: LGA 1156 Shoulder Screw for Desktop PC, 6.00mm (.236") Thread, Lead-free

Documents:

[Drawing \(PDF\)](#) [RoHS Certificate of Compliance \(PDF\)](#)
[Product Specification PS-47596-001 \(PDF\)](#)

General

Product Family	Processor Sockets
Series	47596
Component Type	Screw
Product Name	LGA1156

Physical

Circuits (Loaded)	N/A
Durability (mating cycles max)	20
Packaging Type	Bag
Pitch - Mating Interface (in)	0.000 In
Pitch - Mating Interface (mm)	0.00 mm
Temperature Range - Operating	-25°C to +100°C
Termination Interface: Style	Screw or Lug

Electrical

Current - Maximum per Contact	N/A
Voltage - Maximum	N/A

Material Info

Reference - Drawing Numbers

Product Specification	PS-47596-001
Sales Drawing	SD-47597-009

Intel and Nehalem and relevant names are either trademarks or registered trademarks of Intel Corporation

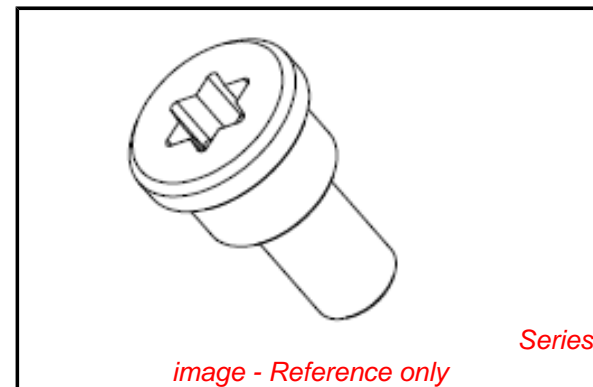

EU RoHS

**ELV and RoHS
Compliant**
**REACH SVHC
Contains SVHC: No
Halogen-Free
Status**

China RoHS



**Need more information on product
environmental compliance?**

Email productcompliance@molex.com
 For a multiple part number RoHS Certificate of
 Compliance, [click here](#)

Please visit the [Contact Us](#) section for any
 non-product compliance questions.

Search Parts in this Series
[47596Series](#)

Mates With
 Intel* Nehalem Processor

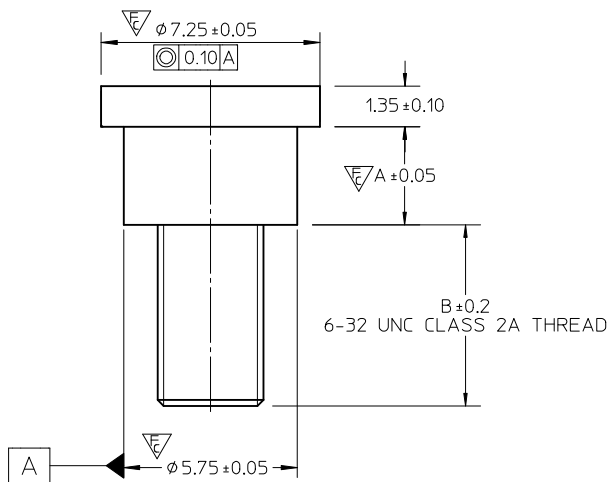
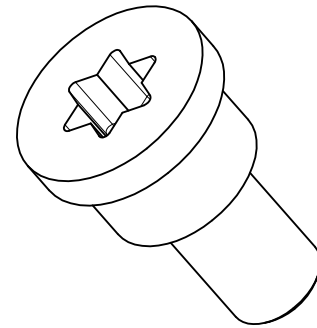
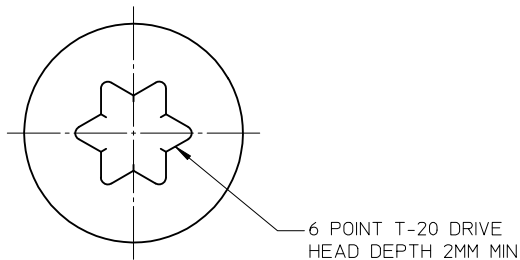

NOTES:

1. MATERIAL: LOW CARBON STEEL.
MIN HARDNESS-ROCKWELL HARDNESS B70.
2. PLATING: 2 MICRON MINIMUM ELECTROLYTIC NICKEL.
PROCESS TEST: 48 HOURS AT 85°C/85% HUMIDITY WITH NO VISIBLE CORROSION.
3. REMOVE ALL BURRS OR SHARP EDGES AROUND PERIMETER OF PART.
SHARPNESS OF EDGES SUBJECT TO HANDLING ARE REQUIRED TO MEET UL1439 TEST.
4. BREAK ALL SHARP CORNERS, EDGES, AND BURRS TO 0.10MM MAX.
5. PART SHALL BE DEGREASED AND FREE OF OIL AND DIRT MARKS.
6. THE PART IS COMPLAINT TO RoHS DIRECTIVE 2002/95/EC AND ELV DIRECTIVE 2000/53/EC.

47597-6201	3.35	6.0
47597-6101	3.25	3.8
47597-6001	3.25	6.0
MATERIAL NUMBER	DIM A	DIM B

ENTER DESCRIPTION EC NO: SH2010-0330 DRWN: ZHANG11 2010/01/06 CHKD: 2010/02/08 APPR: WFDENG 2010/02/24	QUALITY SYMBOLS $\sqrt{A}=0$ $\sqrt{A}=3$ $\sqrt{A}=0$	GENERAL TOLERANCES (UNLESS SPECIFIED)		DIMENSION STYLE	SCALE	DESIGN UNITS	THIRD ANGLE PROJECTION		
				MM ONLY	6:1	METRIC			
				DRAWN BY	DATE	TITLE		SOCKET H1 ILM SHOULDER SCREW	
				CHECKED BY	DATE	APPROVED BY			
		4 PLACES \pm --- \pm --- 3 PLACES \pm --- \pm --- 2 PLACES ± 0.10 \pm --- 1 PLACE ± 0.15 \pm --- ANGULAR $\pm 1^\circ$		DATE	MOLEX INCORPORATED		SHEET NO. 1 OF 1		
		DRAFT WHERE APPLICABLE MUST REMAIN WITHIN DIMENSIONS		DATE	MOLEX INCORPORATED				
A1				MATERIAL NO.	DOCUMENT NO.				
				SEE TABLE	SD-47597-009				
				THIS DRAWING CONTAINS INFORMATION THAT IS PROPRIETARY TO MOLEX INCORPORATED AND SHOULD NOT BE USED WITHOUT WRITTEN PERMISSION					