

PLEASE CHECK WWW.MOLEX.COM FOR LATEST PART INFORMATION

Part Number: [0351091610](#)
Status: **Active**
Description: 1.78mm (.070") Tab Wire-to-Board Female Housing, 5.00mm (.197") Pitch, 16Circuits

Documents:

[3D Model](#) [Product Specification PS-35028-001 \(PDF\)](#)
[Drawing \(PDF\)](#) [RoHS Certificate of Compliance \(PDF\)](#)

General

Product Family Crimp Housings
 Series [35109](#)
 Product Name N/A

Physical

Circuits (maximum) 16
 Color - Resin Natural
 Gender Female
 Glow-Wire Compliant No
 Material - Resin Nylon
 Number of Rows 2
 Packaging Type Bag
 Panel Mount No
 Pitch - Mating Interface (in) 0.197 In
 Pitch - Mating Interface (mm) 5.00 mm
 Stackable No
 Temperature Range - Operating -40°C to +105°C

Material Info

Reference - Drawing Numbers

Product Specification PS-35028-001
 Sales Drawing SD-35109-**10

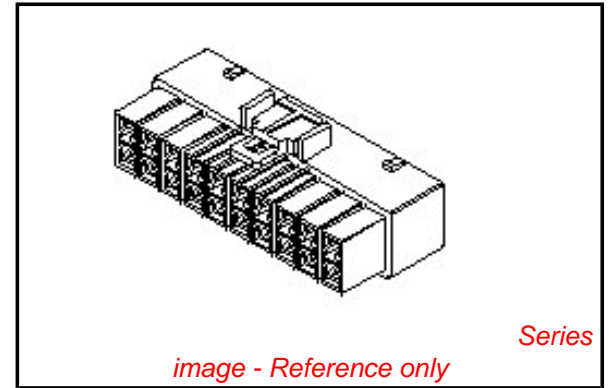

EU RoHS

**ELV and RoHS
 Compliant**
**REACH SVHC
 Contains SVHC: No**
**Halogen-Free
 Status**

China RoHS



**Need more information on product
 environmental compliance?**

Email productcompliance@molex.com
 For a multiple part number RoHS Certificate of
 Compliance, [click here](#)

Please visit the [Contact Us](#) section for any
 non-product compliance questions.

Search Parts in this Series

[35109Series](#)

Mates With

[35205|35208](#)

Use With

[35028](#)

DO NOT SCALE DRAWING
DIMENSION IN METRIC

PROJECT NO. METER CONN.

SIMILAR ITEM

EDP NO.

35 09 *** 1

ENG. NO

SD 35 09 *** 1

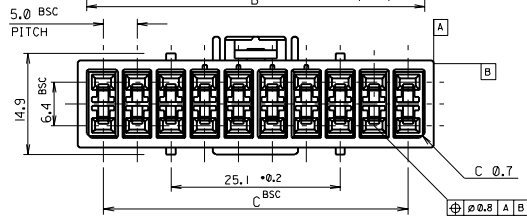
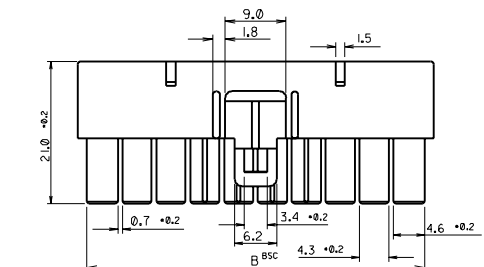
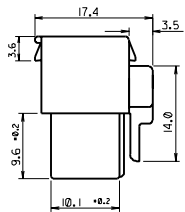
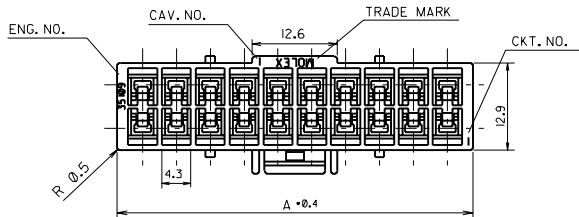

NOTE

1. MATERIAL : NYLON 66 UL94V-2
2. APPLICABLE TERMINAL : 35028-9010
3. MATED WITH HEADER : 35205-**-1, 35208-****

LEGEND

35 109 - ** 1

COLOR : 0 --- NATURAL
1 --- BLACK

CKT(16,20)

45.0	49.9	52.6	35 109-20 1*	35 109-20 1*	20
35.0	39.9	42.6	35 109-16 1*	35 109-16 1*	16
C	B	A	EDP. NO.	ENG. NO.	CKT.

C REVISED		99/04/10	99/04/10	ASS'Y PART		QTY/REEL OR PACK		SURFACE AREA		MATERIAL		WIRE RANGE		GENERAL TOLERANCES		MOLEX MOLEX-KOREA CO.,LTD.	
B RELEASED		99/01/17	99/03/27	DESCRIPTION		MM ²		MM ²		NYLON 66 UL94V-2		AWG: ---		DIM. : 0.30		REVISE ONLY ON CAD SYSTEM	
A NEW RELEASED		99/01/17	99/03/27	ENG. NO.		DIE NO.		LAYOUT NO.		DIMENSION CLASSIFICATION		MM ² : ---		ANGLE : 1°			
TEMPORARY RELEASED		99/03/25	99/03/25	---		---		---		<input checked="" type="checkbox"/> : CRITICAL <input type="checkbox"/> : MAJOR <input type="checkbox"/> : MINOR <input type="checkbox"/> : REFERENCE		INSULATION RANGE		TITLE:		METER CONN.FEMALE HOUSING	
---		99/03/25	99/03/25	---		---		---		DRAWN BY		RANGE		ENG. NO.			
LTR REVISION RECORD		ECN	DR. / CHK.	DATE	DIE FEED	APPL FEED	WBDW	IBDW	APP'D BY	H.S.SHIN	CHK'D BY	SCALE	---		SD 35 109-**-1		REV C